

# Tillable Soils Map

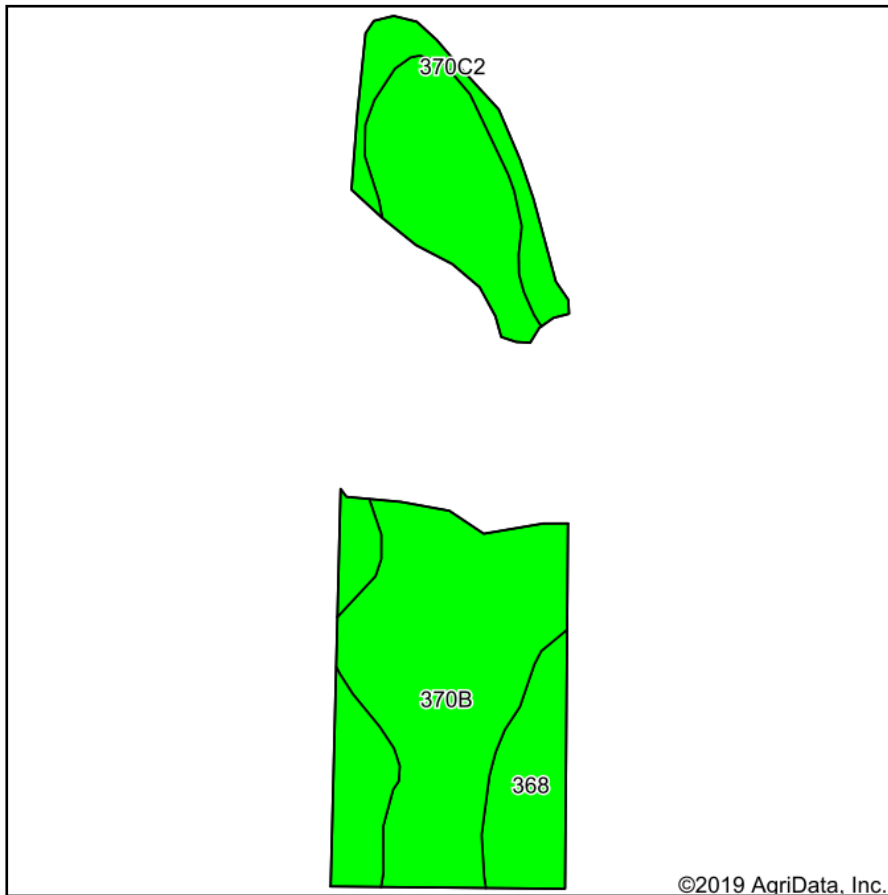

Soils data provided by USDA and NRCS.

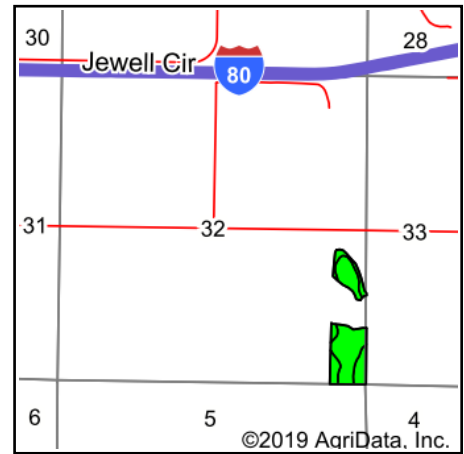

State: **Iowa**  
 County: **Dallas**  
 Location: **32-78N-28W**  
 Township: **Adams**  
 Acres: **19.76**  
 Date: **2/28/2020**



Maps Provided By:



Area Symbol: IA049. Soil Area Version: 25											
Code	Soil Description	Acres	Percent of field	CSR2 Legend	Non-Irr Class *c	*i Corn	*i Soybeans	CSR2**	CSR	*n NCCPI Overall	
370B	Sharpsburg silty clay loam, 2 to 5 percent slopes	13.19	66.8%		Ile	225.6	65.4	91	87	93	
370C2	Sharpsburg silty clay loam, 5 to 9 percent slopes, eroded	4.03	20.4%		IIle	204.8	59.4	80	67	71	
368	Macksburg silty clay loam, 0 to 2 percent slopes	2.54	12.9%		Iw	230.4	66.8	93	95	85	
<b>Weighted Average</b>						<b>222</b>	<b>64.4</b>	<b>89</b>	<b>83.9</b>	<b>*n 87.5</b>	

\*\*IA has updated the CSR values for each county to CSR2.

\*i Yield data provided by the ISPAID Database version 8.1.1 developed by IA State University.

\*n: The aggregation method is "Weighted Average using major components"

\*c: Using Capabilities Class Dominant Condition Aggregation Method

Soils data provided by USDA and NRCS.