

TEXAS
HALL

Form: FSA-156EZ

See Page 2 for non-discriminatory Statements.



United States Department of Agriculture
Farm Service Agency

Abbreviated 156 Farm Record

FARM : 2578

Prepared : Jul 30, 2019

Crop Year : 2019

Operator Name : KEVIN HUDDLESTON
Farms Associated with Operator : 48-191-363, 48-191-1898, 48-191-2448, 48-191-2578, 48-191-2583
CRP Contract Number(s) : None
Recon ID : 48-191-2015-4
ARCPLC G//F Eligibility : Eligible

Farm Land Data

Farmland	Cropland	DCP Cropland	WBP	WRP	CRP	GRP	Sugarcane	Farm Status	Number Of Tracts
445.64	442.51	442.51	0.00	0.00	0.00	0.00	0.00	Active	1
State Conservation	Other Conservation	Effective DCP Cropland	Double Cropped		MPL	Acre Election	EWP	DCP Ag.Rel. Activity	Broken From Native Sod
0.00	0.00	442.51	0.00		0.00		0.00	0.00	0.00

Crop Election Choice

ARC Individual	ARC County	Price Loss Coverage
None	None	WHEAT, OATS, FLAX, CORN, SORGH, PNUTS, SNFLR, SFLWR, SOYBN, BARLY, RAPE, MUSTD, SESME, CANOL, CRAMB, SUP, RICE-LGR, RICE-MGR, SML-CHIKP, LRG-CHIKP, PEAS, LENTI

DCP Crop Data

Crop Name	Base Acres	CCC-505 CRP Reduction Acres	CTAP Yield	PLC Yield	HIP
Wheat	0.00	0.00	0	19	
Seed Cotton	347.20	0.00	0	754	
TOTAL	347.20	0.00			

NOTES

Tract Number : 1580
Description : H 6
FSA Physical Location : TEXAS/HALL
ANSI Physical Location : TEXAS/HALL
BIA Unit Range Number :
HEL Status : HEL field on tract.Conservation system being actively applied
Wetland Status : Wetland determinations not complete
WL Violations : None
Owners : KEVIN HUDDLESTON, CHRIS L CABBINESS
Other Producers : None
Recon ID : None

Tract Land Data

Farm Land	Cropland	DCP Cropland	WBP	WRP	CRP	GRP	Sugarcane
445.64	442.51	442.51	0.00	0.00	0.00	0.00	0.00
State Conservation	Other Conservation	Effective DCP Cropland	Double Cropped	MPL	EWP	DCP Ag. Rel Activity	Broken From Native Sod
0.00	0.00	442.51	0.00	0.00	0.00	0.00	0.00

DCP Crop Data

TEXAS
HALL
Form: FSA-156EZ



United States Department of Agriculture
Farm Service Agency

Abbreviated 156 Farm Record

FARM : 2578
Prepared : Jul 30, 2019
Crop Year : 2019

Tract 1580 Continued ...

Crop Name	Base Acres	CCC-505 CRP Reduction Acres	CTAP Yield	PLC Yield
Seed Cotton	347.20	0.00	0	754

TOTAL 347.20 0.00

NOTES

In accordance with Federal civil rights law and U.S. Department of Agriculture (USDA) civil rights regulations and policies, the USDA, its Agencies, offices, and employees, and institutions participating in or administering USDA programs are prohibited from discriminating based on race, color, national origin, religion, sex, gender identity (including gender expression), sexual orientation, disability, age, marital status, family/parental status, income derived from a public assistance program, political beliefs, or reprisal or retaliation for prior civil rights activity, in any program or activity conducted or funded by USDA (not all bases apply to all programs). Remedies and complaint filing deadlines vary by program or incident.

Persons with disabilities who require alternative means of communication for program information (e.g., Braille, large print, audiotope, American Sign Language, etc.) should contact the responsible Agency or USDA's TARGET Center at (202) 720-2600 (voice and TTY) or contact USDA through the Federal Relay Service at (800) 877-8339. Additionally, program information may be made available in languages other than English.

To file a program discrimination complaint, complete the USDA Program Discrimination Complaint Form, AD-3027, found online at http://www.ascr.usda.gov/complaint_filing_cust.html and at any USDA office or write a letter addressed to USDA and provide in the letter all of the information requested in the form. To request a copy of the complaint form, call (866) 632-9992. Submit your completed form or letter to USDA by: (1) mail: U.S. Department of Agriculture Office of the Assistant Secretary for Civil Rights 1400 Independence Avenue, SW Washington, D.C. 20250-9410; (2) fax: (202) 690-7442; or (3) e-mail: program.inlake@usda.gov. USDA is an equal opportunity provider, employer, and lender.

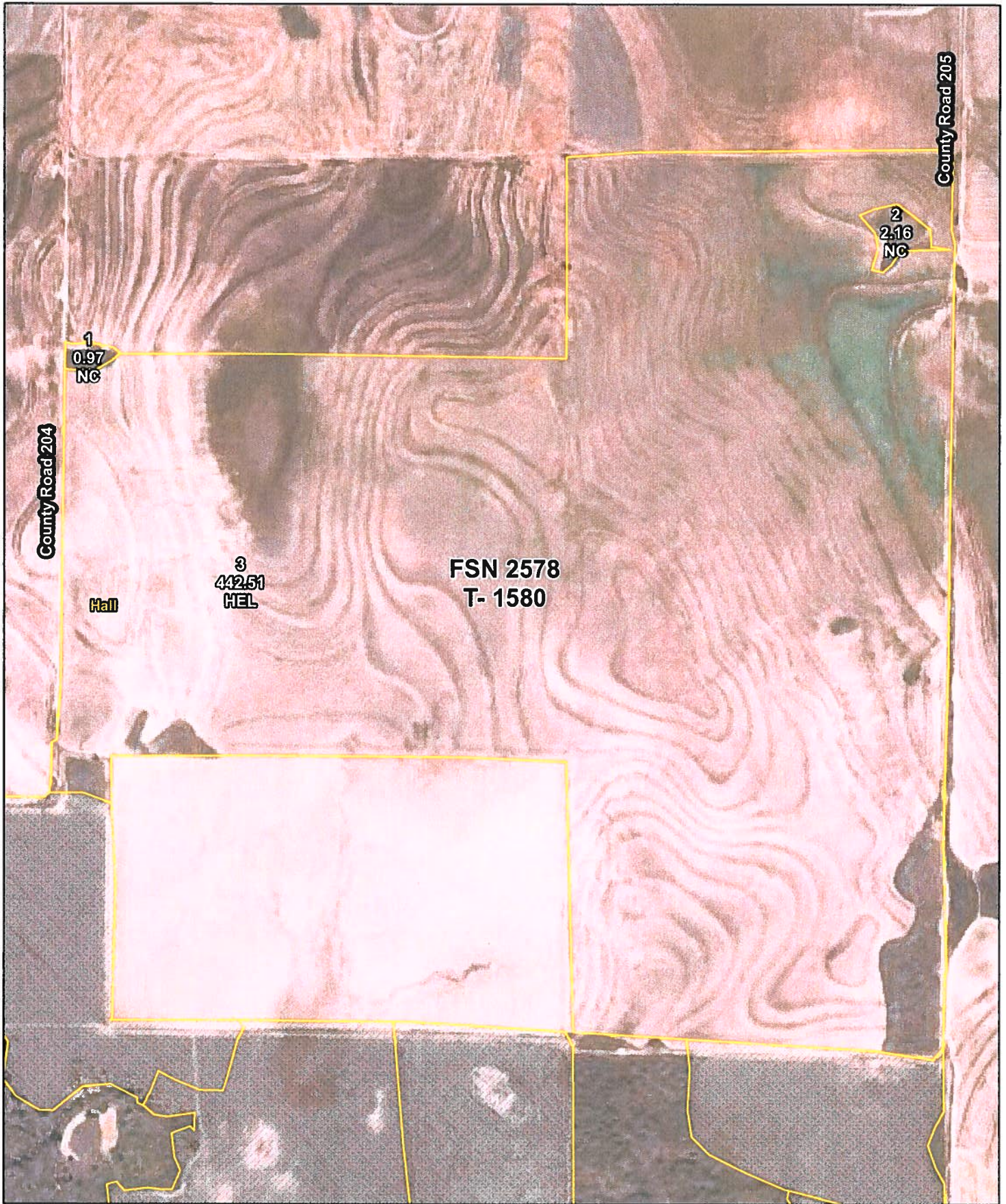

Farm: 2578
Tract: 1580

Hall County

Wetland Determination Identifiers

- Restricted Use
- ▼ Limited Restrictions
- Exempt from Conservation Compliance Provisions

Wetland identifiers do not represent the size, shape, or specific determination of the area. Refer to your original determination (CPA-026 and attached maps) for exact wetland boundaries and labels, or contact NRCS.

Crop Year _____

Map Created: January 15, 2013

0 405 810 Feet

