

# Soils Map - Tillable Acres per Whiteside Co. FSA

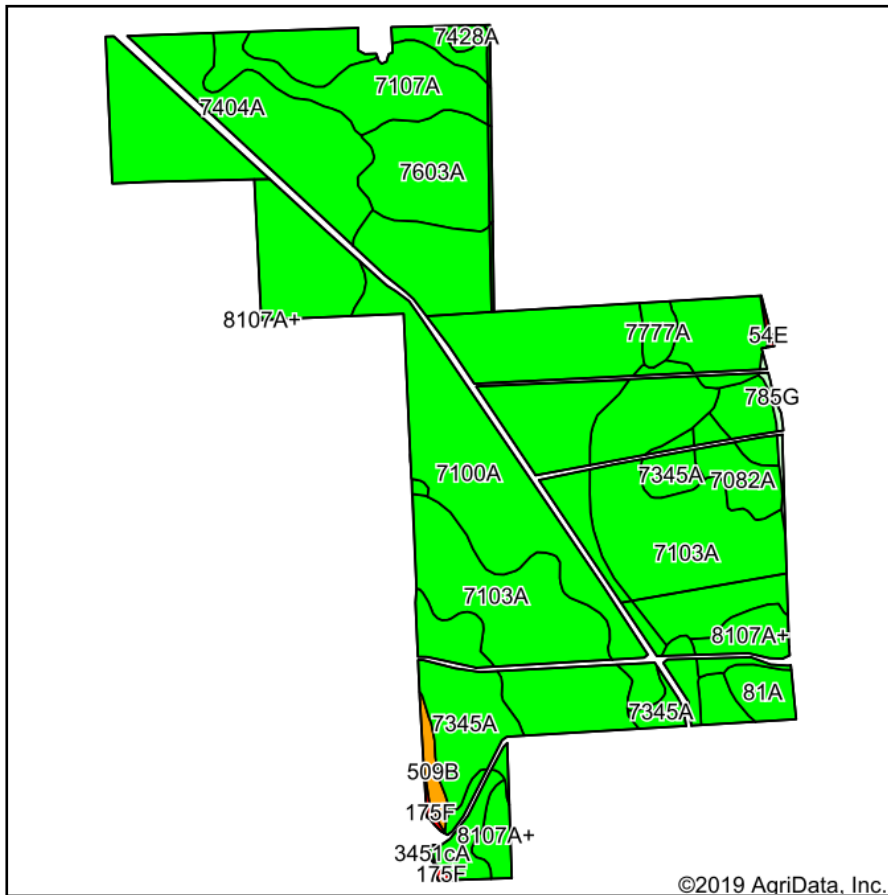

Soils data provided by USDA and NRCS.

©2019 AgriData, Inc.

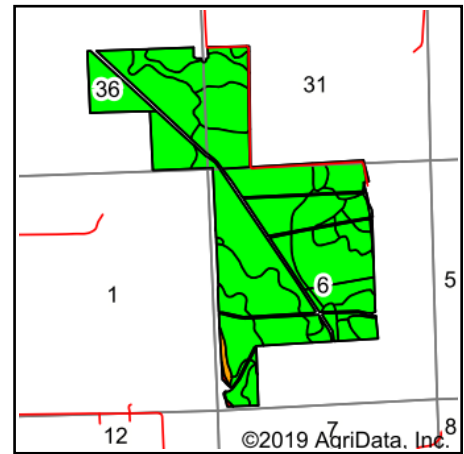

State: **Illinois**  
 County: **Whiteside**  
 Location: **6-21N-4E**  
 Township: **Union Grove**  
 Acres: **472.11**  
 Date: **7/17/2019**

**PC PEOPLES**  
 COMPANY  
 INNOVATIVE. REAL ESTATE. SOLUTIONS.

Maps Provided By:

**surety**  
 CUSTOMIZED ONLINE MAPPING  
 © AgriData, Inc. 2019 www.AgriDataInc.com



Area Symbol: IL195. Soil Area Version: 15

Code	Soil Description	Acres	Percent of field	Il. State Productivity Index Legend	Corn Bu/A	Soybeans Bu/A	Wheat Bu/A	Oats Bu/A	Alfalfa hay, T/A	Crop productivity index for optimum management
7100A	Palms muck, 0 to 2 percent slopes, rarely flooded	131.89	27.9%		161	51	0	0	0.00	118
7103A	Houghton muck, 0 to 2 percent slopes, rarely flooded	111.99	23.7%		175	57	0	0	0.00	130
7404A	Titus silty clay loam, 0 to 2 percent slopes, rarely flooded	76.01	16.1%		158	52	61	75	0.00	118
7603A	Blackoar silt loam, 0 to 2 percent slopes, rarely flooded	38.58	8.2%		178	57	66	88	0.00	131
7345A	Elvers silt loam, 0 to 2 percent slopes, rarely flooded	35.23	7.5%		161	51	61	79	0.00	118
7107A	Sawmill silty clay loam, 0 to 2 percent slopes, rarely flooded	24.81	5.3%		189	60	71	98	0.00	139
81A	Littleton silt loam, 0 to 2 percent slopes	13.63	2.9%		194	61	74	100	0.00	142
8107A+	Sawmill silt loam, 0 to 2 percent slopes, occasionally flooded, overwash	13.42	2.8%		189	60	71	98	0.00	139
7082A	Millington clay loam, 0 to 2 percent slopes, rarely flooded	8.89	1.9%		171	54	65	79	0.00	125
3415A	Orion silt loam, 0 to 2 percent slopes, frequently flooded	6.76	1.4%		180	57	66	89	0.00	131
7777A	Adrian muck, 0 to 2 percent slopes, rarely flooded	3.73	0.8%		146	49	0	0	0.00	110
**509B	Whalan loam, 2 to 5 percent slopes	2.98	0.6%		**122	**39	**50	**64	**2.98	**89
7428A	Coffeen silt loam, 0 to 2 percent slopes, rarely flooded	1.67	0.4%		181	57	68	90	0.00	132
**785G	Lacrescent cobbly loam, 25 to 60 percent slopes	1.35	0.3%		**52	**18	**19	**22	0.00	**40
**175F	Lamont fine sandy loam, 18 to 35 percent slopes	0.72	0.2%		**93	**31	**38	**48	**2.31	**70
**54E	Plainfield sand, 12 to 20 percent slopes	0.37	0.1%		**86	**30	**35	**42	0.00	**66

3451cA	Lawson silt loam, cool mesic, 0 to 2 percent slopes, frequently flooded	0.08	0.0%		190	61	73	97	0.00	140
<b>Weighted Average</b>					<b>168.1</b>	<b>54</b>	<b>30.5</b>	<b>39.7</b>	<b>0.02</b>	<b>124.1</b>

**Table: Optimum Crop Productivity Ratings for Illinois Soil by K.R. Olson and J.M. Lang, Office of Research, ACES, University of Illinois at Champaign-Urbana.** Version: 1/2/2012 Amended Table S2 B811

Crop yields and productivity indices for optimum management (B811) are maintained at the following NRES web site: <http://soilproductivity.nres.illinois.edu/>

\*\* Indexes adjusted for slope and erosion according to Bulletin 811 Table S3

**b** Soils in the southern region were not rated for oats and are shown with a zero "0".

**d** Soils in the poorly drained group were not rated for alfalfa and are shown with a zero "0".

\*c: Using Capabilities Class Dominant Condition Aggregation Method

Soils data provided by USDA and NRCS. Soils data provided by University of Illinois at Champaign-Urbana.