



# GLADES END

## Area Information

### Schools

Colonial Elementary School  
Read Mountain Middle School  
Lord Botetourt High School

### Tax Rate

\$.79 per \$100

### Water

Aqua Virginia Inc.

### Electric

Appalachian Power

[www.botetourtva.gov](http://www.botetourtva.gov)

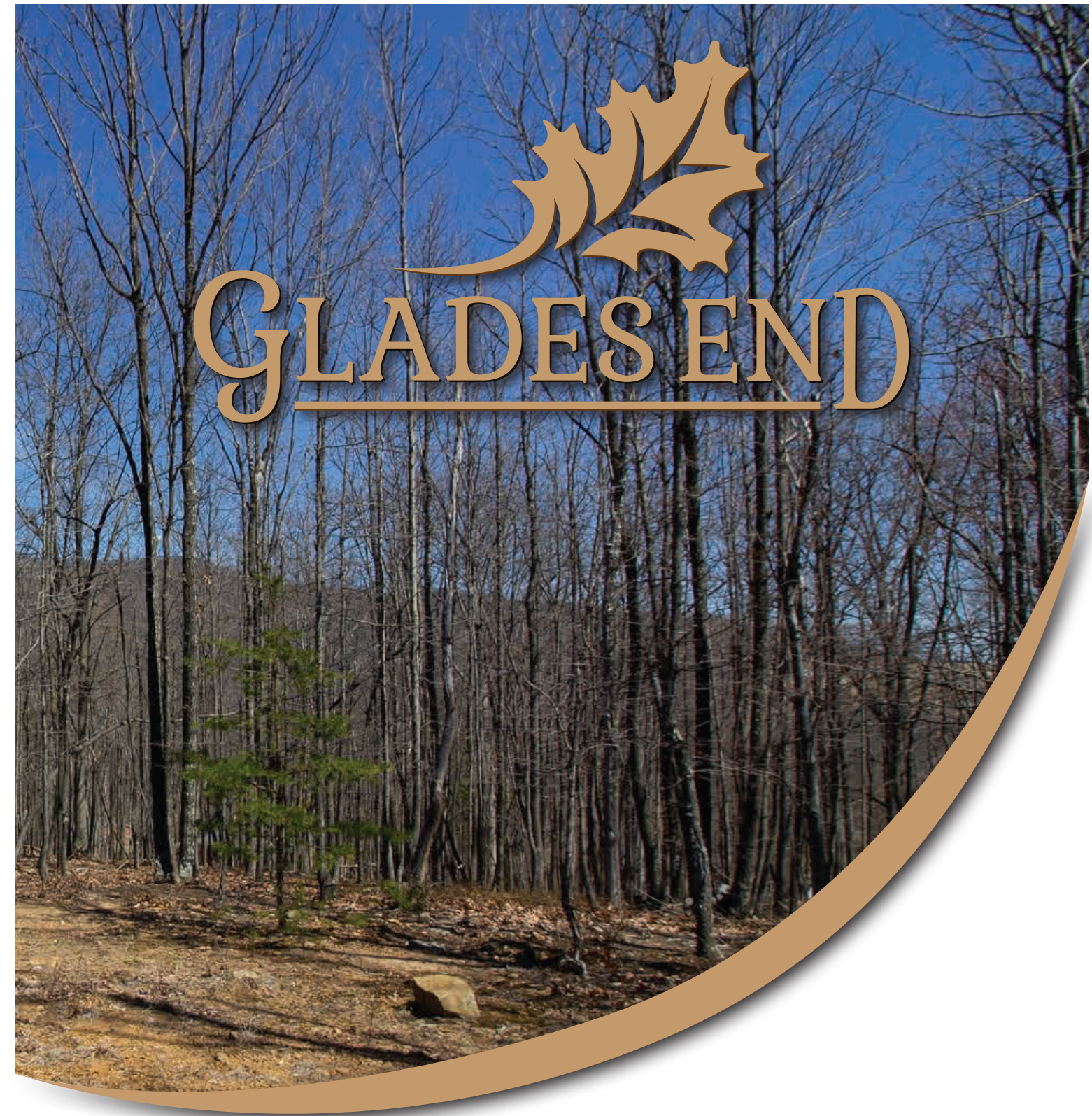

There are restrictive covenants and architectural review;  
call to speak with a salesperson and receive your homebuilder's package today!

## PREMIUM BUILDING SITES IN BOTETOURT COUNTY



OFFERED BY COUNTRYSIDE LAND COMPANY LC  
[virginialanddirect.com](http://virginialanddirect.com) | [land@countrysideinc.biz](mailto:land@countrysideinc.biz) | 540-886-6155



# AVAILABLE FLOOR PLANS



**THE  
PRESTWYCK**



**THE  
ODYSSEY**



**THE  
CHESTNUT  
SPRINGS**



**THE  
LYTHAM**

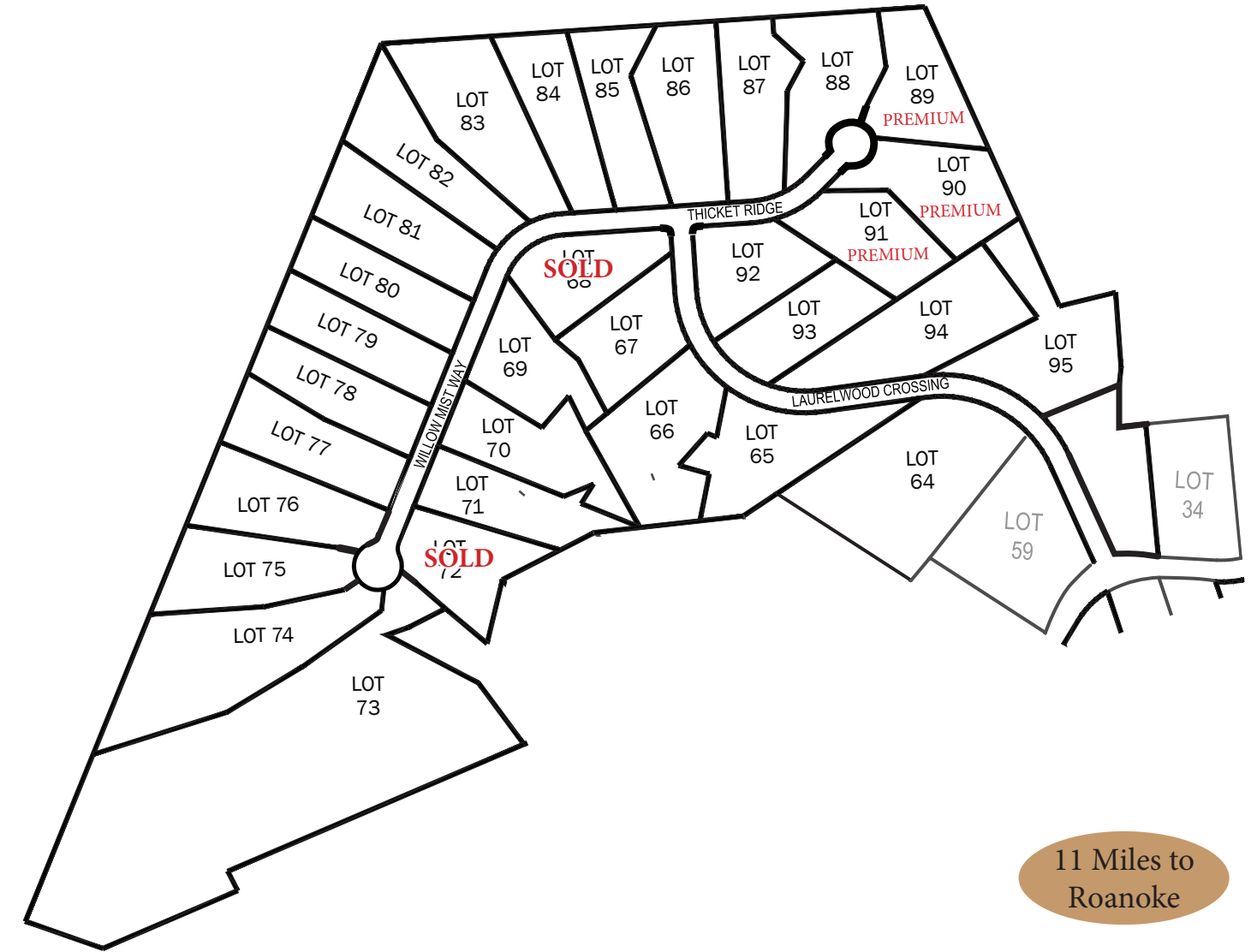

11 Miles to  
Roanoke

Ask about our **Buy Now, Build Later** finance program!

Lot 64	2.93 acres	\$50,000	Lot 75	1.51 acres	\$695,000	Lot 86	1.61 acres	\$60,000
Lot 65	2.91 acres	\$55,000	Lot 76	1.50 acres	\$60,000	Lot 87	1.42 acres	\$65,000
Lot 66	1.64 acres	\$65,000	Lot 77	1.38 acres	\$60,000	Lot 88	1.47 acres	\$85,000
Lot 67	1.26 acres	\$60,000	Lot 78	1.25 acres	\$65,000	Lot 89	1.30 acres	\$110,000
Lot 68	1.25 acres	<b>SOLD</b>	Lot 79	1.29 acres	\$60,000	Lot 90	1.45 acres	\$95,000
Lot 69	1.26 acres	\$65,000	Lot 80	1.26 acres	\$65,000	Lot 91	1.28 acres	\$95,000
Lot 70	1.42 acres	\$65,000	Lot 81	1.54 acres	\$70,000	Lot 92	1.25 acres	\$85,000
Lot 71	1.26 acres	\$60,000	Lot 82	1.50 acres	\$70,000	Lot 93	1.25 acres	\$55,000
Lot 72	1.25 acres	<b>SOLD</b>	Lot 83	2.00 acres	\$80,000	Lot 94	2.03 acres	\$45,000
Lot 73	9.19 acres	\$75,000	Lot 84	1.32 acres	\$65,000	Lot 95	1.93 acres	\$35,000
Lot 74	2.72 acres	\$45,000	Lot 85	1.28 acres	\$70,000			