

TEXAS
KNOX



United States Department of Agriculture
Farm Service Agency

FARM : 1826

Prepared : 8/4/20 10:35 AM

Form: FSA-156EZ

Crop Year : 2020

See Page 2 for non-discriminatory Statements.

Abbreviated 156 Farm Record

Operator Name : GARY TIDWELL FARMS
Farms Associated with Operator : 48-275-436, 48-275-1826, 48-275-3522, 48-275-3559
CRP Contract Number(s) : None
Recon ID : None
Transferred From : None
ARCPLC G//F Eligibility : Eligible

Farm Land Data

Farmland	Cropland	DCP Cropland	WBP	WRP	CRP	GRP	Sugarcane	Farm Status	Number Of Tracts
204.33	204.33	204.33	0.00	0.00	0.00	0.00	0.00	Active	2
State Conservation	Other Conservation	Effective DCP Cropland	Double Cropped		MPL	Acre Election	EWP	DCP Ag.Rel. Activity	Broken From Native Sod
0.00	0.00	204.33	0.00		0.00		0.00	0.00	0.00

Crop Election Choice

ARC Individual	ARC County	Price Loss Coverage
None	None	WHEAT, SUP

DCP Crop Data

Crop Name	Base Acres	CCC-505 CRP Reduction Acres	PLC Yield	HIP
Wheat	69.10	0.00	22	
Seed Cotton	107.36	0.00	1207	
Unassigned Generic Base	26.84	0.00	0	
TOTAL	203.30	0.00		

NOTES

Tract Number : 2676
Description : L/12
FSA Physical Location : TEXAS/KNOX
ANSI Physical Location : TEXAS/KNOX
BIA Unit Range Number :
HEL Status : NHEL: No agricultural commodity planted on undetermined fields
Wetland Status : Tract does not contain a wetland
WL Violations : None
Owners : GARY TIDWELL
Other Producers : CHANCE MYERS, NANCY TIDWELL
Recon ID : None

Tract Land Data

Farm Land	Cropland	DCP Cropland	WBP	WRP	CRP	GRP	Sugarcane
121.81	121.81	121.81	0.00	0.00	0.00	0.00	0.00
State Conservation	Other Conservation	Effective DCP Cropland	Double Cropped	MPL	EWP	DCP Ag. Rel Activity	Broken From Native Sod
0.00	0.00	121.81	0.00	0.00	0.00	0.00	0.00

TEXAS
KNOX
Form: FSA-156EZ



United States Department of Agriculture
Farm Service Agency

FARM : 1826
Prepared : 8/4/20 10:35 AM
Crop Year : 2020

Abbreviated 156 Farm Record

DCP Crop Data

Tract 2676 Continued ...

Crop Name	Base Acres	CCC-505 CRP Reduction Acres	PLC Yield
Wheat	41.20	0.00	22
Seed Cotton	64.00	0.00	1207
Unassigned Generic Base	16.00	0.00	0
TOTAL	121.20	0.00	

NOTES

Tract Number : 2677
Description : L/12
FSA Physical Location : TEXAS/KNOX
ANSI Physical Location : TEXAS/KNOX
BIA Unit Range Number :
HEL Status : NHEL: No agricultural commodity planted on undetermined fields
Wetland Status : Tract does not contain a wetland
WL Violations : None
Owners : MAURYCE HARRIS
Other Producers : CHANCE MYERS, NANCY TIDWELL, GARY TIDWELL
Recon ID : None

Tract Land Data

Farm Land	Cropland	DCP Cropland	WBP	WRP	CRP	GRP	Sugarcane
82.52	82.52	82.52	0.00	0.00	0.00	0.00	0.00
State Conservation	Other Conservation	Effective DCP Cropland	Double Cropped	MPL	EWP	DCP Ag. Rel Activity	Broken From Native Sod
0.00	0.00	82.52	0.00	0.00	0.00	0.00	0.00

DCP Crop Data

Crop Name	Base Acres	CCC-505 CRP Reduction Acres	PLC Yield
Wheat	27.90	0.00	22
Seed Cotton	43.36	0.00	1207
Unassigned Generic Base	10.84	0.00	0
TOTAL	82.10	0.00	

NOTES

In accordance with Federal civil rights law and U.S. Department of Agriculture (USDA) civil rights regulations and policies, the USDA, its Agencies, offices, and employees, and institutions participating in or administering USDA programs are prohibited from discriminating based on race, color, national origin, religion, sex, gender identity (including gender expression), sexual orientation, disability, age, marital status, family/parental status, income derived from a public assistance program, political beliefs, or reprisal or retaliation for prior civil rights activity, in any program or activity conducted or funded by USDA (not all bases apply to all programs). Remedies and complaint filing deadlines vary by program or incident.

Persons with disabilities who require alternative means of communication for program information (e.g., Braille, large print, audiotape, American Sign Language, etc.) should contact the responsible Agency or USDA's TARGET Center at (202) 720-2600 (voice and TTY) or contact USDA through the Federal Relay Service at (800) 877-8339. Additionally, program information may be made available in languages other than English.

To file a program discrimination complaint, complete the USDA Program Discrimination Complaint Form, AD-3027, found online at http://www.ascr.usda.gov/complaint_filing_cust.html and at any USDA office or write a letter addressed to USDA and provide in the letter all of the information requested in the form. To request a copy of the complaint form, call (866) 632-9992. Submit your completed form or letter to USDA by: (1) mail: U.S. Department of Agriculture Office of the Assistant Secretary for Civil Rights 1400 Independence Avenue, SW Washington, D.C. 20250-9410; (2) fax: (202) 690-7442; or (3) e-mail: program.intake@usda.gov. USDA is an equal opportunity provider, employer, and lender.

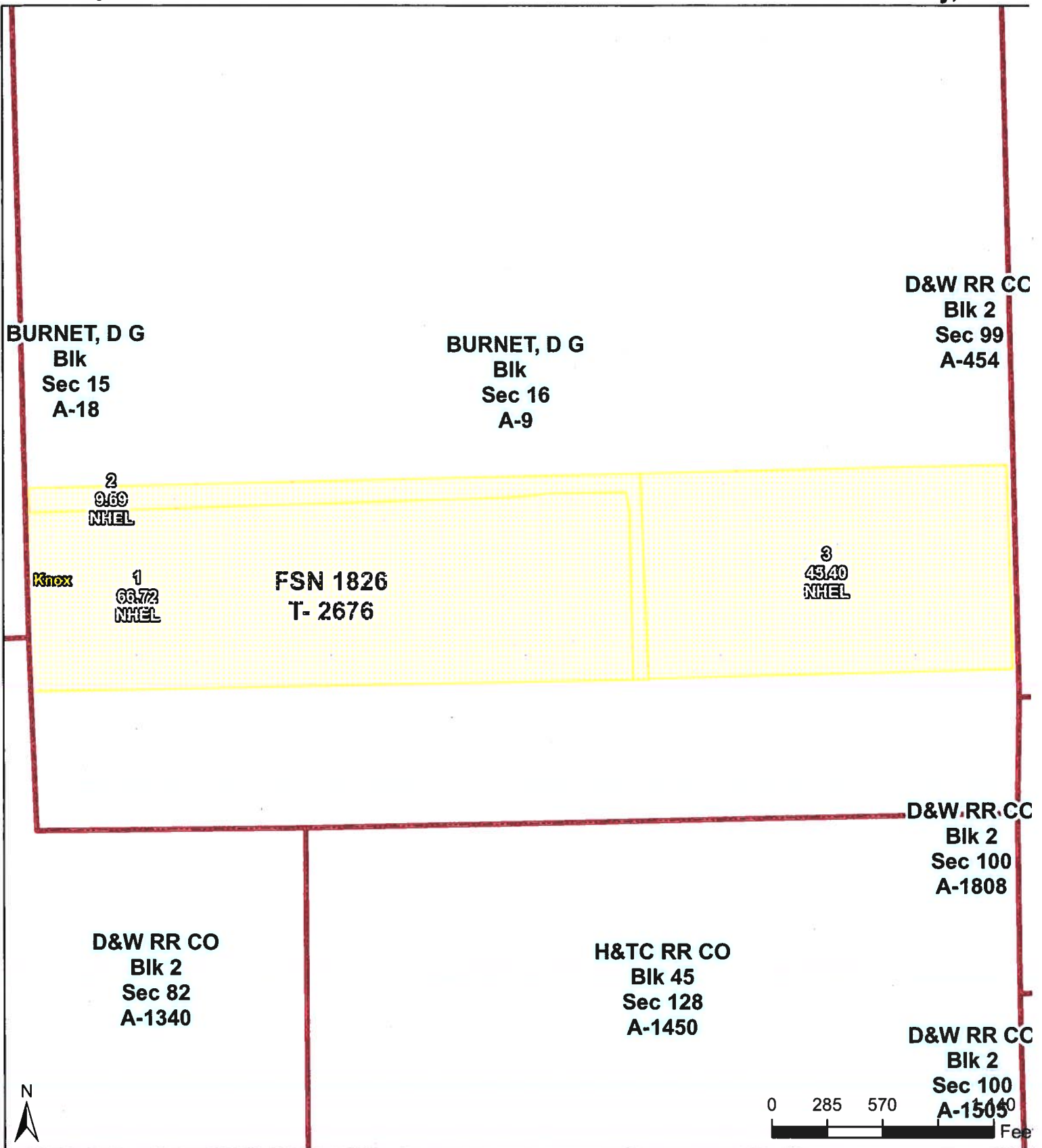

Farm: 1826
Tract: 2676

Wetland Determination Identifiers

- Restricted Use
- ▼ Limited Restrictions
- Exempt from Conservation
- Compliance Provisions

2020 Program Year

Map Created August 04, 202
Image Acquisition Year - 201