

# Soils Map

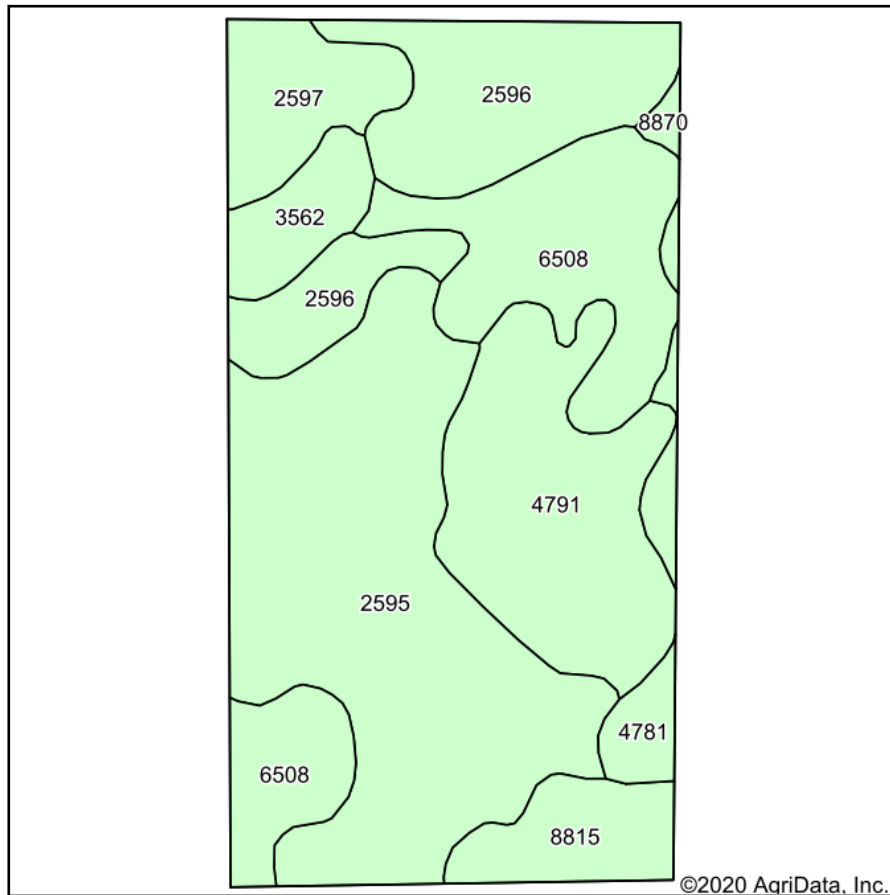

Soils data provided by USDA and NRCS.

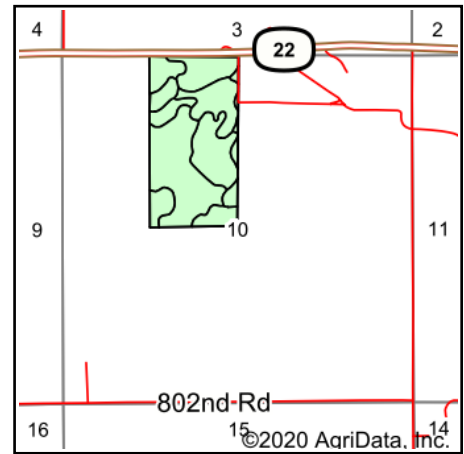

State: **Nebraska**  
 County: **Greeley**  
 Location: **10-17N-12W**  
 Township: **Scotia**  
 Acres: **78.34**  
 Date: **8/5/2020**



Maps Provided By:  
  
 CUSTOMIZED ONLINE MAPPING  
 © AgriData, Inc. 2020 www.AgriDataInc.com



Area Symbol: NE077. Soil Area Version: 18

Cod e	Soil Description	Acres	Percent of field	Non-Irr Class *c	Irr Class *c	SRP G	Alfalfa hay	Alfalfa hay Irrigated	Corn	Corn Irrigated	Grain sorghum	Grain sorghum Irrigated	Winter wheat	*n NCCPI Soybeans
2595	Hersh fine sandy loam, 0 to 3 percent slopes	26.26	33.5%	IIIe	IIIe	57		1	4	17	5	11		47
6508	Blendon fine sandy loam, 0 to 2 percent slopes	13.30	17.0%	Ile	Ile	44	3	6	54	145	62	120	39	40
4791	Valentine fine sand, 3 to 9 percent slopes	12.72	16.2%	VIe	IVe	23	1	2	20	91	25	84	12	21
2596	Hersh fine sandy loam, 3 to 6 percent slopes	11.72	15.0%	IIIe	IIIe	58		1	3	16	4	8		46
2597	Hersh fine sandy loam, 6 to 11 percent slopes	4.54	5.8%	IVe	IVe	54		1	4	18	5	11		46
8815	Cozad silt loam, 0 to 1 percent slopes	3.87	4.9%	IIc	I	70								70
3562	Hobbs silt loam, occasionally flooded, cool	2.91	3.7%	IIw	IIw									74
4781	Valentine fine sand, 0 to 3 percent slopes	2.41	3.1%	VIe	IVe	24	1	3	22	97	30	86	13	21
8870	Hord silt loam, 1 to 3 percent slopes	0.61	0.8%	Ile	Ile	74								72
Weighted Average						46.9	0.7	2	15.1	51.5	18.1	42.2	9	*n 42.9

\*n: The aggregation method is "Weighted Average using all components"

\*c: Using Capabilities Class Dominant Condition Aggregation Method

Soils data provided by USDA and NRCS.