

SUMMARY OF  
WETLAND RESERVE PLAN OF OPERATIONS (WRPO)  
FOR  
BRUCE A. & NORMA JEAN FUELBERTH

State Texas County Ellis

CFSA Farm No. 2070 Tract No. 4384

**Purpose and Function:** The primary purpose of this easement is the restoration and protection of wetlands for wildlife, particularly migratory birds, flood storage, flood velocity reduction, water quality protection and to establish perennial cover for aesthetic quality. Land offered will add value to wetland ecosystem in the local area.

**Summary of Restoration:** Under the Wetland Reserve Program (WRP) contract, Field 9 (363.9 Ac) constitutes the WRP easement area. This area, as shown on attached map, will be restored according to a detailed plan to accomplish the purposes by:

1. Allowing Areas 9a and 9b to regenerate to a savannah through natural processes.
2. Allowing Area 9c to continue its natural progression as an overflow channel to maintain hydrological balance to the wetland complex.
3. Allowing Area 9d which ponds water on a seasonal basis to remain undisturbed and be restored to wetland through natural succession.

The landowner may also undertake other wetland enhancement measures identified in WRPO that are not required to satisfy the terms of the WRP contract and easement.

**Compatible Uses:** The following uses have been determined to be compatible with the purposes for which the WRP easement is established.

1. Hunting and fishing that is fully consistent with State and Federal regulations, including the leasing of such rights to others; however, the commercial harvest of catfish or crawfish is prohibited.
2. Grazing by livestock provided that:
  - a. A 25 percent harvest efficiency is not exceeded in any given year.
  - b. Nesting birds and other wildlife are not adversely effected.
  - c. Adequate regrowth is allowed to provide winter cover and early spring nesting cover according to WRPO.

**Operation and Maintenance:** The easement area will be maintained to protect the wetland functions and values for which it was established:

1. The Trinity River and overflow channel will serve as a natural boundary for the east, south and west sides of the easement area. On the north side of the easement area, the property line fence will serve as the boundary.
2. If vegetation becomes so rank as to affect quality of the wetland habitat, the vegetation will be controlled by grazing, haying, mowing, prescribed burn or other means as specified in the WRPO and concurred in by the USDA-Natural Resources Conservation Service.
3. All chemical use on the easement area will be in accordance with all label requirements and restrictions and as specified in the WRPO.

# CONSERVATION PLAN MAP

UNITED STATES DEPARTMENT OF AGRICULTURE

SOIL CONSERVATION SERVICE



cooperating with

Ellis - Prairie

Conservation District

Owner Bruce A. Fuelberth/Norm Jean Fuelberth  
Operator Same

Plan No. WRP #1 Date 7/6/95  
Scale 1" = 1000' Acres 363.9

County Ellis State TX

Photo No. Overlay of ASCS Photo  
(1981 Flight)

Location (Community, watershed, road & distance, etc.)

## Wetland Reserve Plan of Operations Map (Planned Restoration-Natural)

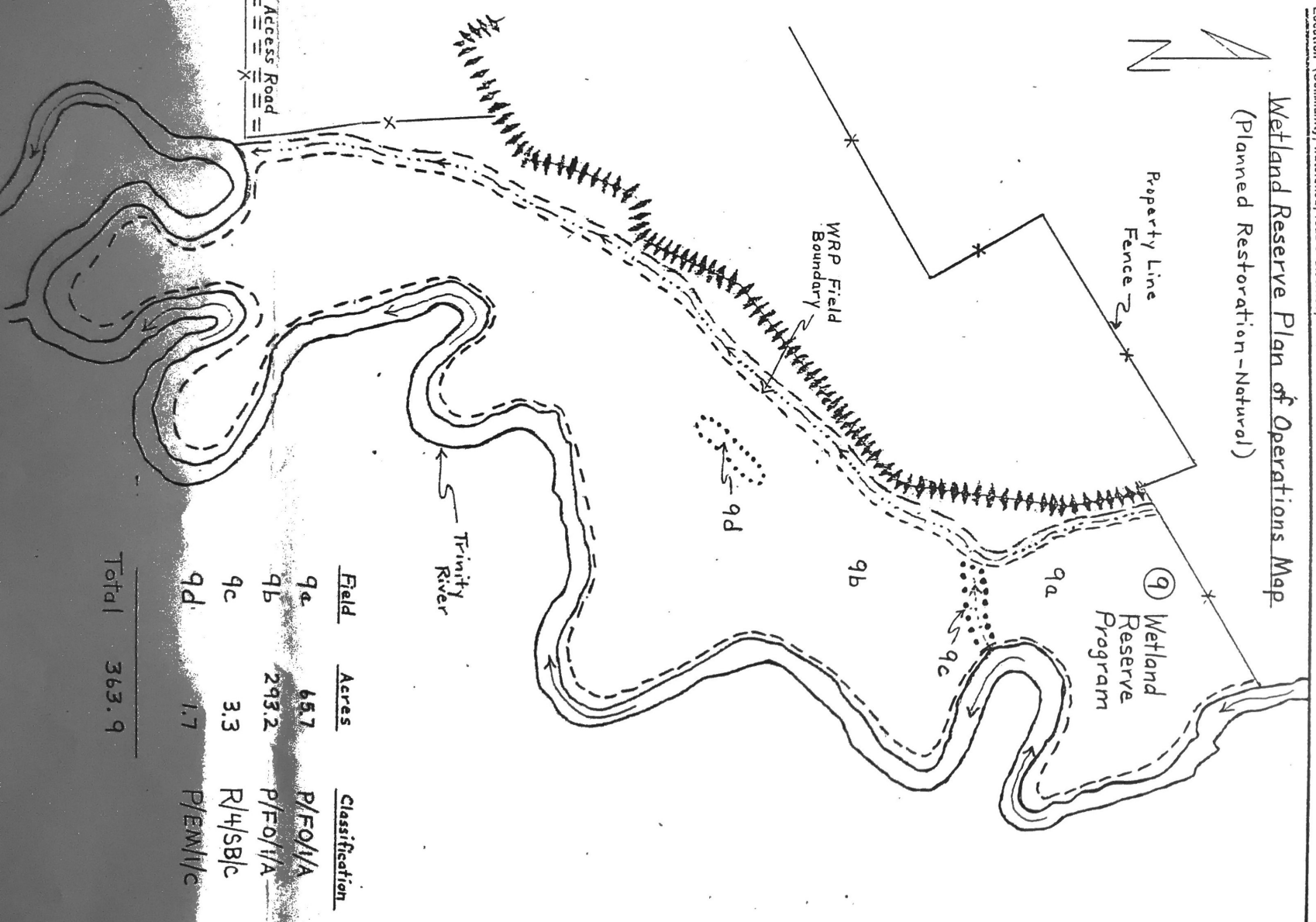

Field	Acres	Classification
9a	65.7	P/EO1/A
9b	293.2	P/EO1/A
9c	3.3	R/4/SB/c
9d	1.7	P/EM1/c

Total 363.9