

WV Department of Health and Human Resources
Bureau for Public Health
Office of Environmental Health Services
ENVIRONMENTAL ENGINEERING DIVISION

SW258

Be
10-22-03

WELL COMPLETION REPORT

Date(s) September 18, 2003 County Hampshire Permit #: DW-14-03-240
Town: Augusta Area Name/Location Little Cacapon Mt. Rd., Cacapon Mt. Retreat #19
Well Owner: Rickie & Catherine Cox Address: 1925 Smith Station Road
Telephone Number: 717-637-7873 Hanover, PA 17331
Well Driller: Miller Bros. Drilling Address: P. O. Box 952
Telephone Number: 304-822-4092 Romney, WV 26757

WELL LOG

DEPTH IN FEET	FORMATIONS: KIND, THICKNESS, AND IF WATER BEARING	REMARKS: <u>Broken area 229' 1" rocks</u>
0 - 3	<u>Lt. red clay & dirt</u>	Type of Well: <u>DW</u> Drilling Method: <u>Air rotary Hammer</u>
3 - 35	<u>Brown shale</u>	Well Diameter: <u>6"</u> Casing O.D.: <u>6 5/8"</u>
35 - 45	<u>Gray shale</u>	Well Depth: <u>240'</u> Date Completed: <u>September 18, 2003</u>
45 - 240	<u>Lt. blue shale</u>	CASING: Length <u>60</u> Feet Height above ground <u>1</u> Feet
		<input checked="" type="checkbox"/> Steel <input type="checkbox"/> Plastic <input type="checkbox"/> Cast Iron
		Other _____ Type _____
		SCREEN
		<input checked="" type="checkbox"/> None Installed
		Type _____ Diameter _____
		Slot/Gauge _____ Length _____
		Set Between _____ Ft. and _____ Ft.

PUMPING OR BAILING TEST

DETAILS	#1	#2	#3
Static Water Level (Ft. Below Grade)	<u>70</u>		
Pumping Rate (GPM)	<u>25</u>		
Pumping Level (Ft Below Grade)	<u>238</u>		
Duration of Test (In Hours)	<u>2</u>		
Recovery Time to Static Level (In Hours)	<u>1</u>		

WELL HEAD

Pitless Adapter: Type, Make, Etc. _____
Well Cap: Type, Make, Etc. Royer - Conduit type
Well Seal: Type, Make, Etc. _____
Well Platform: _____
Length _____ Width _____ Thickness _____
pressure _____
Grouting: ☒ Yes ☐ No
All Public Water Supplies must be grouted.

I hereby certify that this well was drilled and constructed under my supervision, in compliance with all requirements of the referenced permit, and that this record is true to the best of my knowledge and belief.

Jeffrey G. Miller

Name Miller Bros. Drilling Certification No. _____
Registered Business Name Miller Bros. Drilling Date September 18, 2003
Signed _____

SS 177 7/96

INSPECTION TO BE
PRINTED OR TYPED

STATE OF WEST VIRGINIA
HAMPSHIRE HEALTH DEPARTMENT
ON-SITE SEWAGE DISPOSAL SYSTEM
INSPECTION FORM

Permit No.: ST-H-13-286Tax Map: 21 Parcel #: 58

County Road: _____

County: HAMPSHIRE

Name of Owner: RICK & CATHERINE COX Installer: BILLY HART
Address: 1925 SMITH STATION, HANOVER PA, 17331
Property Location: CACAPON MNT RETREAT LOT #19
Type of Facility: HOUSE Facility is: New ☒ Existing () Lot Size: 10.25 Sq. Ft./Acres
Design Loading in gpd/No. Bedrooms: 3 BR Source of Water Supply: WELL

SEWAGE TANK COMPONENT

Capacity in Gallons: 1000 Material: CONCRETE Manufacturer: WILCO
Distance (in feet) of Tank to: Dwelling: 40 Private ()/Public () Water Source: 100' Property Line: 10'

ON-SITE DISPOSAL SYSTEM

Class I Systems: Standard Soil Absorption Trenches () or Bed () Gravelless Pipe (), Diameter: _____ Inches
Chamber Soil Absorption Trenches () or Bed ()
Class II Systems: Pumped/Dosed Soil Absorption Trenches () or Bed () Evapotranspiration Trenches () or Bed ()
Shallow Soil Absorption Trenches () or Bed () Other: _____

No of Lines: 3 Length (in feet) of Each: 48 . 66 . 66
Width of Trenches: 36 inches/feet Depth to Bottom of Field: 24-36 inches
If Bed, Dimensions (in Feet): _____ If Chamber System, Name: INFILTRATOR No. of Units: 20
Approved and Adequate Materials Used? Yes ☒ No () Size Equates to: 900 Square Feet of Standard Gravel Field.
Distance (in feet) of System to: Dwelling: 70' Private ☒/Public () Water Source: WELL Property Line: 10'
Remarks: _____

An inspection indicates that the sewage disposal system described above
DOES MEET ☒
DOES NOT MEET (),
CANNOT BE DETERMINED TO MEET () the minimum standards established by the West Virginia Bureau of Public Health.

To correct a health hazard, modifications to existing systems may be done to improve part of a system. Such modifications may not be able to be designated as a **does meet** system since inadequate information is known.

Although many factors contribute to the successful functioning of a sewage disposal system, this office recommends water conservation and maintaining an even usage of water throughout the week.

Sketch of Installation with Triangulation or Distance to Specific Landmarks:

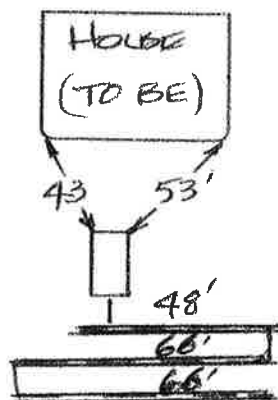
NOT TO SCALEDraw Arrow
toward NorthVisit Date(s) 6-19-02Final Inspection Date: 9-17-03Sanitarian: J. Kander