

Soil Map—Monroe County, Wisconsin

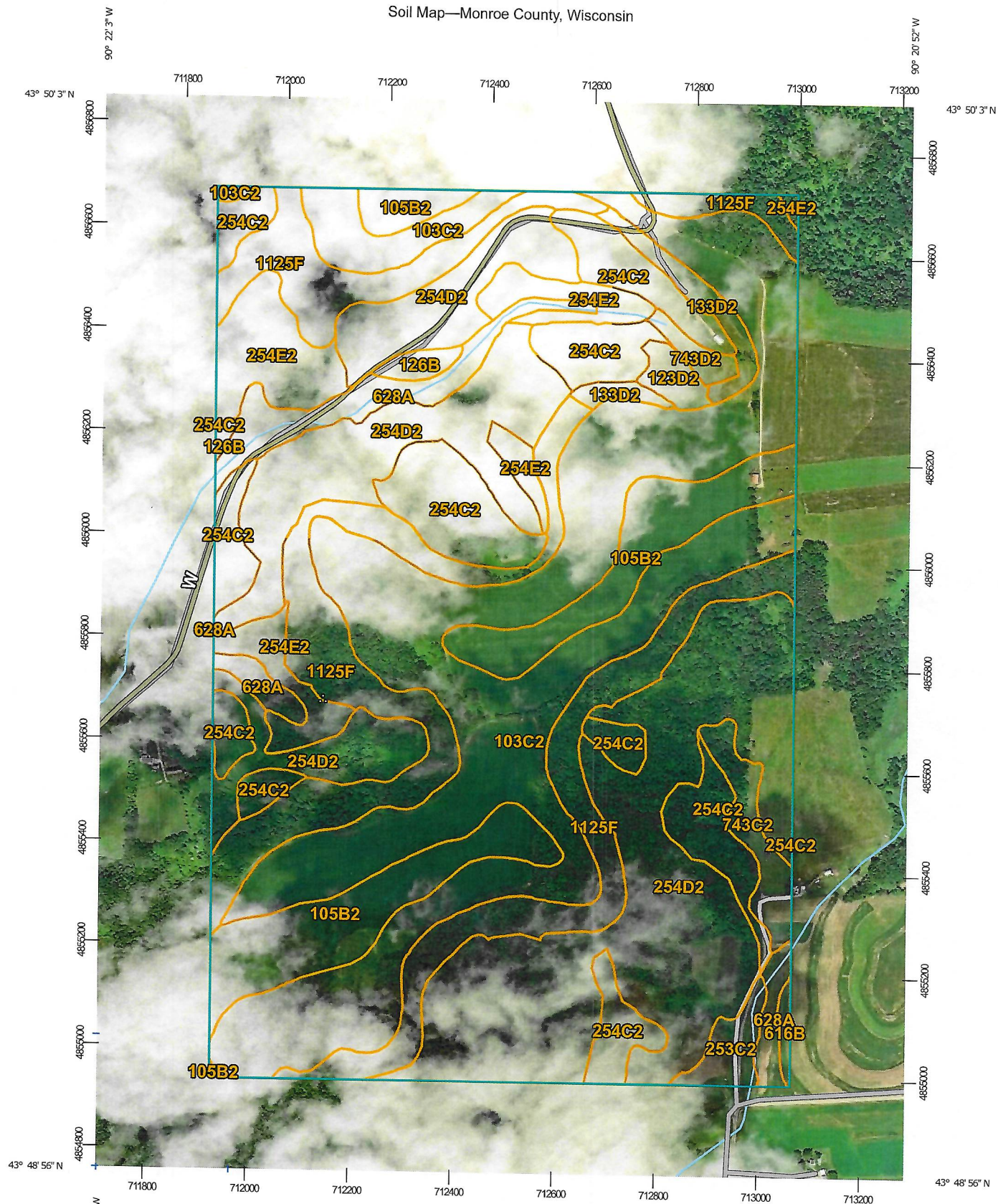

Map Scale: 1:10,200 if printed on A portrait (8.5" x 11") sheet.

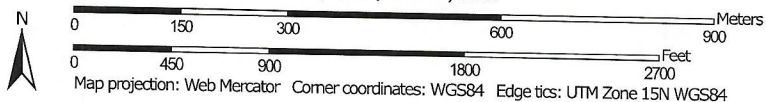

Natural Resources
Conservation Service

Web Soil Survey
National Cooperative Soil Survey

10/9/2020
Page 1 of 3

Map Unit Legend

Map Unit Symbol	Map Unit Name	Acres in AOI	Percent of AOI
103C2	Wildale channery silt loam, 6 to 12 percent slopes, moderately eroded	128.6	26.3%
105B2	Wildale silt loam, 2 to 6 percent slopes, moderately eroded	40.5	8.3%
123D2	Blackhammer silt loam, 12 to 20 percent slopes, moderately eroded	2.8	0.6%
126B	Barremills silt loam, 1 to 6 percent slopes	2.3	0.5%
133D2	Valton silt loam, 12 to 20 percent slopes, moderately eroded	6.3	1.3%
253C2	Greenridge silt loam, 4 to 12 percent slopes, moderately eroded	4.3	0.9%
254C2	Norden silt loam, 6 to 12 percent slopes, moderately eroded	50.3	10.3%
254D2	Norden silt loam, 12 to 20 percent slopes, moderately eroded	129.4	26.4%
254E2	Norden silt loam, 20 to 30 percent slopes, moderately eroded	25.2	5.2%
616B	Chaseburg silt loam, 1 to 4 percent slopes, occasionally flooded	1.0	0.2%
628A	Orion silt loam, 0 to 3 percent slopes, occasionally flooded	15.5	3.2%
743C2	Council fine sandy loam, 6 to 12 percent slopes, moderately eroded	6.6	1.4%
743D2	Council fine sandy loam, 12 to 20 percent slopes, moderately eroded	2.2	0.4%
1125F	Dorerton, very stony-Elbaville complex, 30 to 60 percent slopes	74.3	15.2%
Totals for Area of Interest		489.3	100.0%