

# Soils Map - Tillable Acres

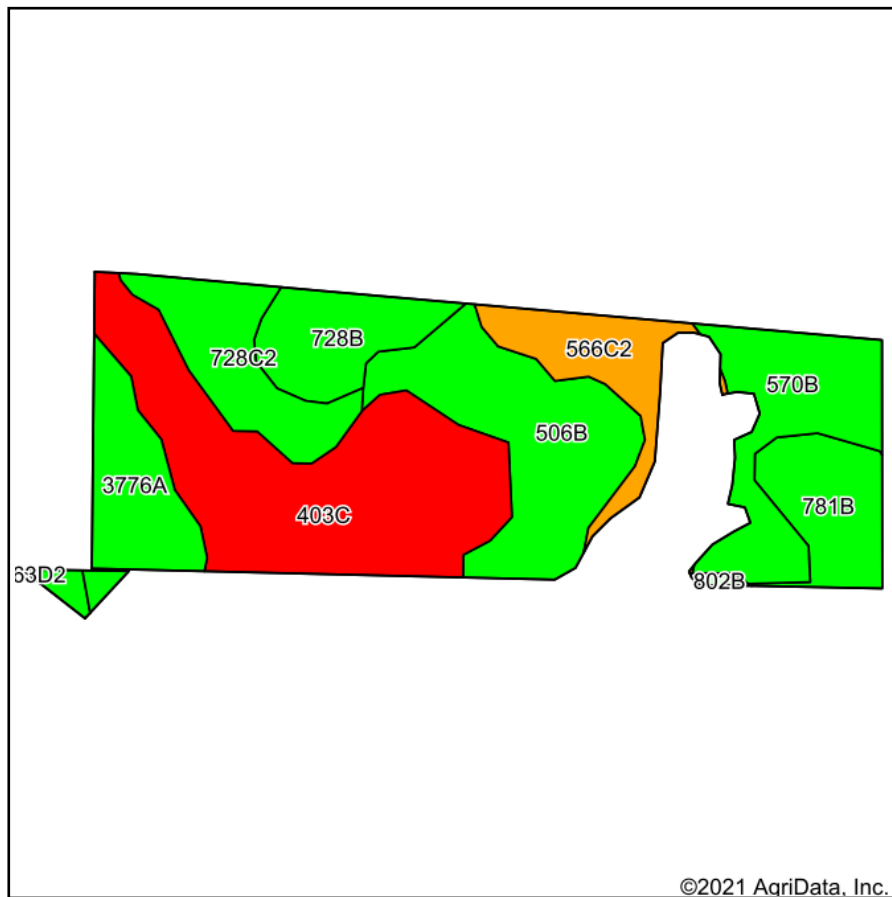

Soils data provided by USDA and NRCS.

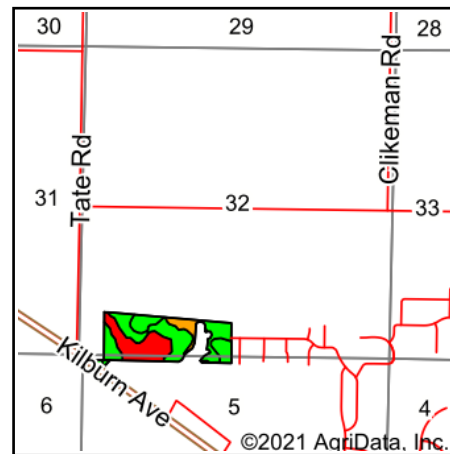

State: **Illinois**  
 County: **Winnebago**  
 Location: **32-45N-1E**  
 Township: **Owen**  
 Acres: **34.05**  
 Date: **2/24/2021**



Maps Provided By:



Code	Soil Description	Acres	Percent of field	Il. State Productivity Index Legend	Corn Bu/A	Soybeans Bu/A	Wheat Bu/A	Oats Bu/A	Alfalfa hay, T/A	Crop productivity index for optimum management
**403C	Elizabeth silt loam, 5 to 10 percent slopes	9.80	28.8%		**76	**27	**32	**36	0.00	**59
**506B	Hitt silt loam, 2 to 5 percent slopes	6.02	17.7%		**156	**52	**62	**82	**4.59	**117
**570B	Martinsville silt loam, 2 to 4 percent slopes	4.13	12.1%		**153	**49	**62	**74	**4.47	**113
**728C2	Winnebago silt loam, 5 to 10 percent slopes, eroded	3.10	9.1%		**153	**50	**61	**78	**4.44	**113
3776A	Comfrey loam, 0 to 2 percent slopes, frequently flooded	2.97	8.7%		185	61	69	89	0.00	138
**781B	Friesland fine sandy loam, 2 to 5 percent slopes	2.60	7.6%		**157	**51	**63	**79	**4.84	**118
**728B	Winnebago silt loam, 2 to 5 percent slopes	2.56	7.5%		**162	**53	**65	**83	**4.72	**121
**566C2	Rockton and Dodgeville soils, 5 to 10 percent slopes, eroded	2.51	7.4%		**126	**43	**56	**68	**3.66	**96
**440B	Jasper silt loam, 2 to 5 percent slopes	0.26	0.8%		**173	**56	**70	**93	**5.71	**129
802B	Orthents, loamy, undulating	0.10	0.3%						.00	
Weighted Average					132.9	44.3	53.6	66.7	2.79	99.9

**Table: Optimum Crop Productivity Ratings for Illinois Soil by K.R. Olson and J.M. Lang, Office of Research, ACES, University of Illinois at Champaign-Urbana.** Version: 1/2/2012 Amended Table S2 B811

Crop yields and productivity indices for optimum management (B811) are maintained at the following NRES web site: <http://soilproductivity.nres.illinois.edu/>

\*\* Indexes adjusted for slope and erosion according to Bulletin 811 Table S3

**b** Soils in the southern region were not rated for oats and are shown with a zero "0".

**d** Soils in the poorly drained group were not rated for alfalfa and are shown with a zero "0".

\*c: Using Capabilities Class Dominant Condition Aggregation Method

Soils data provided by USDA and NRCS. Soils data provided by University of Illinois at Champaign-Urbana.