

Soils Map

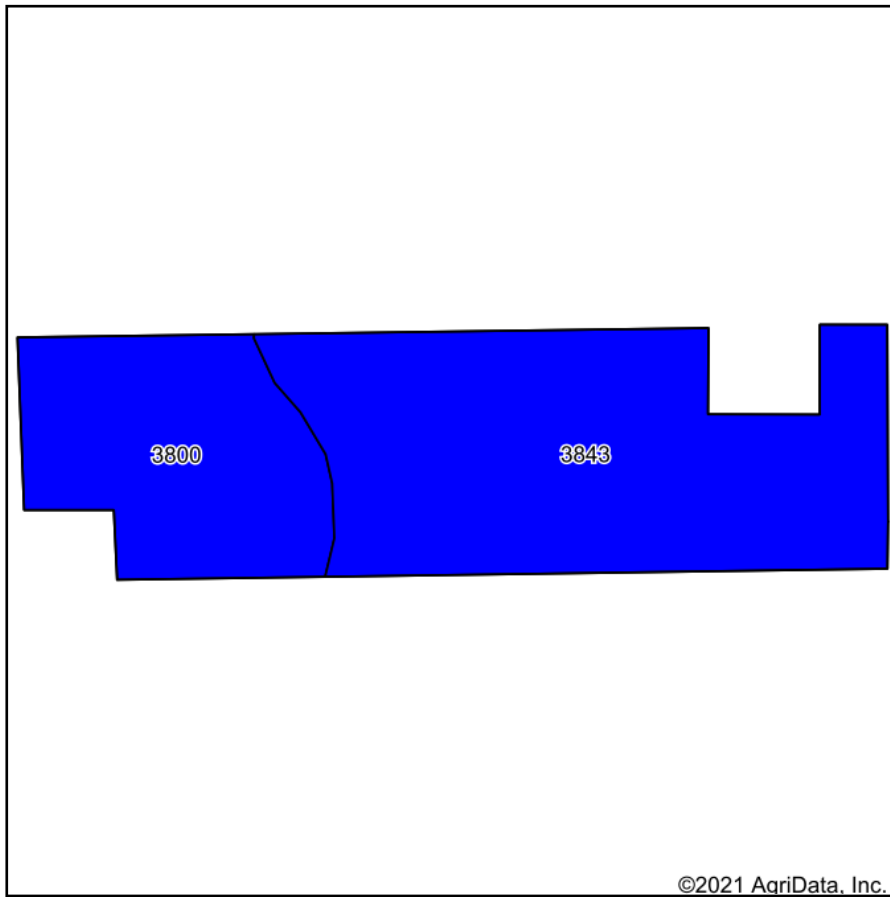

Soils data provided by USDA and NRCS.

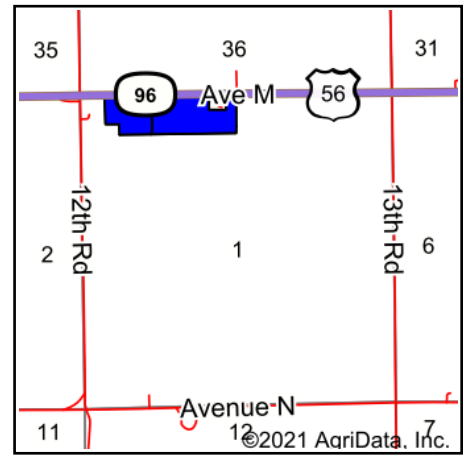

State: **Kansas**
 County: **Rice**
 Location: **1-20S-9W**
 Township: **Center**
 Acres: **29.67**
 Date: **6/3/2021**



COLDWELL BANKER
APW REALTORS®

Maps Provided By:



Area Symbol: KS159, Soil Area Version: 16							
Code	Soil Description	Acres	Percent of field	Non-Irr Class Legend	Non-Irr Class *c	Irr Class *c	*n NCCPI Soybeans
3843	Geary silt loam, 1 to 3 percent slopes	19.98	67.3%		Ile	Ile	72
3800	Crete silt loam, 0 to 1 percent slopes, loess plains and breaks	9.69	32.7%		Ils	Ils	66
Weighted Average							*n 70

*n: The aggregation method is "Weighted Average using all components"

*c: Using Capabilities Class Dominant Condition Aggregation Method

Soils data provided by USDA and NRCS.