

Soils Map

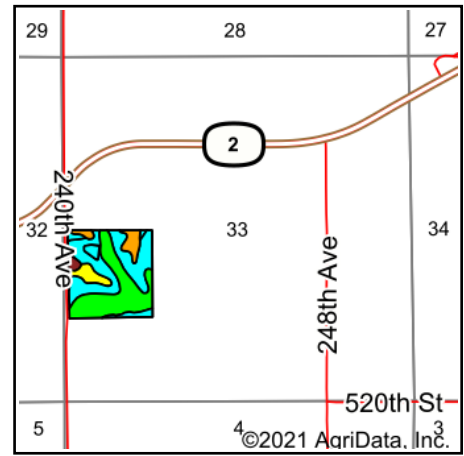

State: **Iowa**
 County: **Appanoose**
 Location: **33-69N-17W**
 Township: **Sharon**
 Acres: **39**
 Date: **6/22/2021**

Hawkeye Farm Mgmt & Real Estate

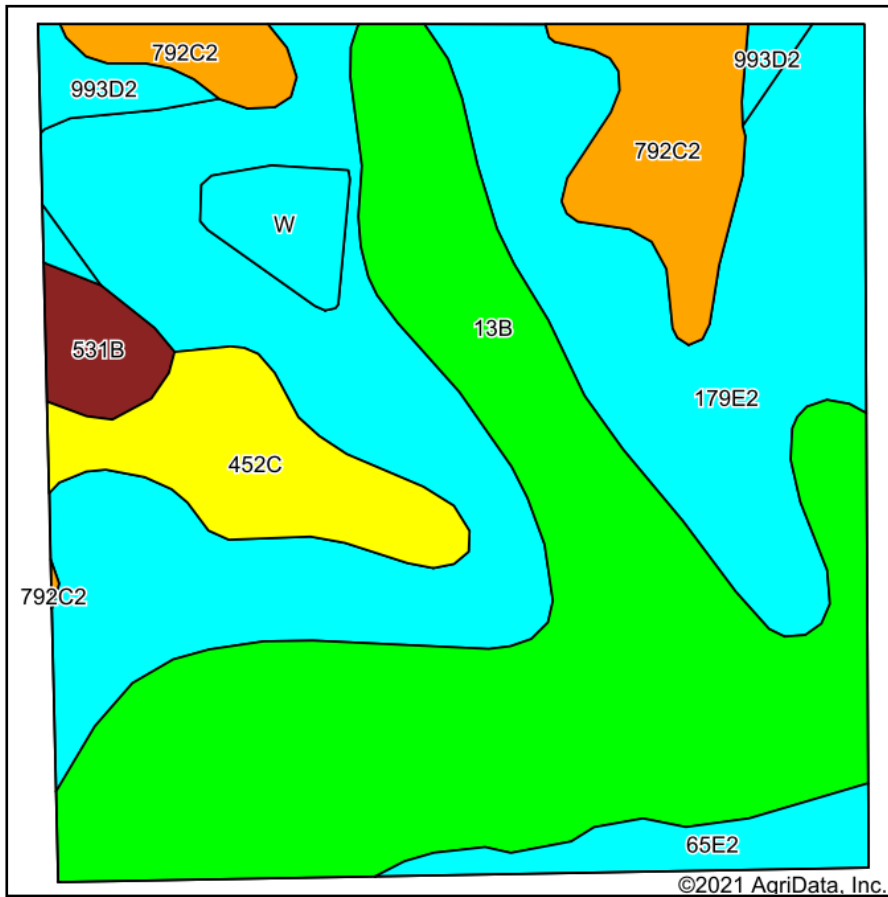

22 N Main, Albion IA Phone: 641-932-7796
 Email: hawkeye@uciowa.com
 On the web: www.uciowa.com
 www.iowawhitetailfarms.com

Maps Provided By:



Area Symbol: IA007, Soil Area Version: 27

Code	Soil Description	Acres	Percent of field	CSR2 Legend	Non-Irr Class *c	CSR2**	CSR	*n NCCPI Soybeans
179E2	Gara loam, 14 to 18 percent slopes, moderately eroded	15.71	40.3%		Vle	24	33	45
13B	Olmitz-Vesser-Colo complex, 2 to 5 percent slopes	14.45	37.1%		Ilw	79	68	80
792C2	Armstrong loam, 5 to 9 percent slopes, moderately eroded	2.78	7.1%		Ille	31	26	48
452C	Lineville silt loam, 5 to 9 percent slopes	2.48	6.4%		Ille	48	35	60
65E2	Lindley loam, 14 to 18 percent slopes, moderately eroded	1.16	3.0%		Vle	29	28	55
W	Water	0.84	2.2%			0	0	
993D2	Armstrong-Gara loams, 9 to 14 percent slopes, moderately eroded complex	0.80	2.1%		Ive	22	20	47
531B	Kniffin silt loam, 2 to 5 percent slopes	0.78	2.0%		Ille	55	58	67
Weighted Average						46.6	45	*n 58.9

**IA has updated the CSR values for each county to CSR2.

*n: The aggregation method is "Weighted Average using all components"

*c: Using Capabilities Class Dominant Condition Aggregation Method

Soils data provided by USDA and NRCS.