

Soils Map

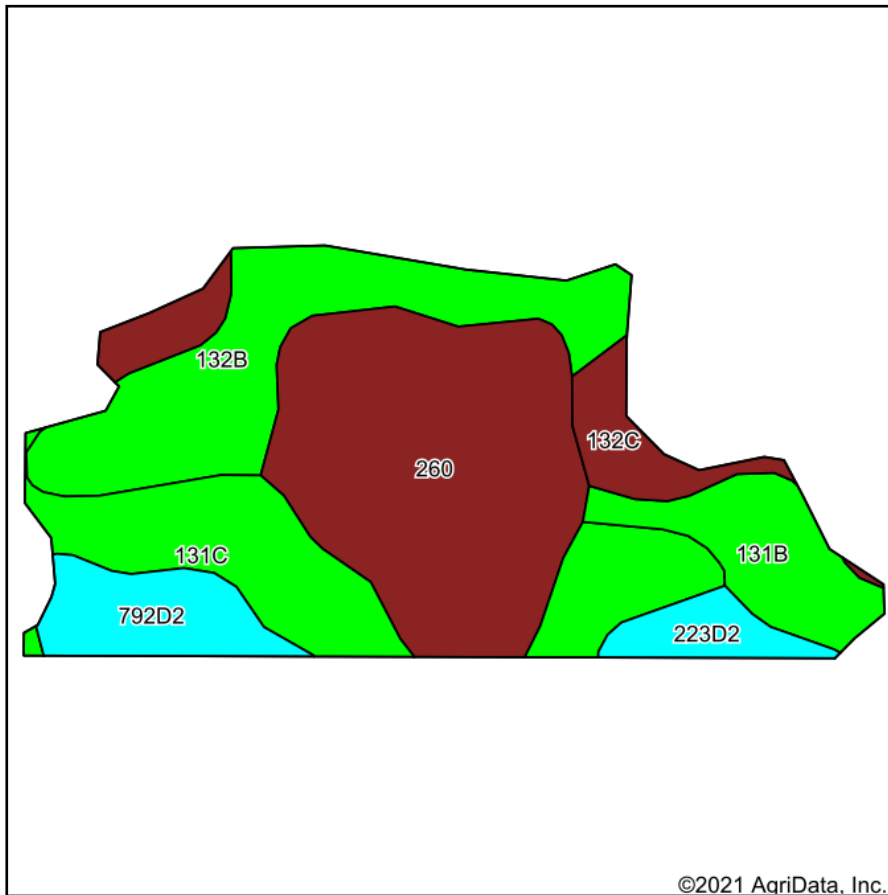

Soils data provided by USDA and NRCS.

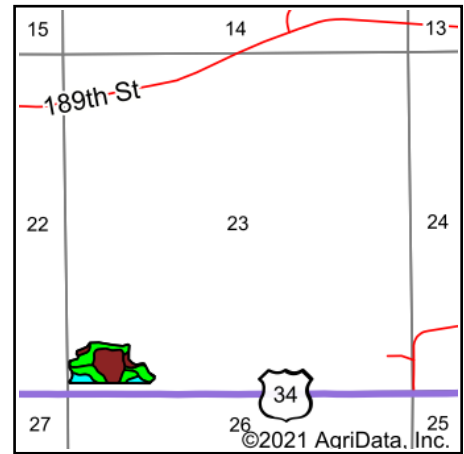

State: **Iowa**
 County: **Monroe**
 Location: **23-72N-16W**
 Township: **Mantua**
 Acres: **14.08**
 Date: **8/2/2021**

Hawkeye Farm Mgmt & Real Estate



22 N Main, Albion IA Phone: 641-932-7796
 Email: hawkeye@uciowa.com
 On the web: www.uciowa.com
 www.iowawhitetailfarms.com

Maps Provided By:



Area Symbol: IA135, Soil Area Version: 28

Code	Soil Description	Acres	Percent of field	CSR2 Legend	Non-Irr Class *c	CSR2**	CSR	*n NCCPI Soybeans
260	Beckwith silt loam, 0 to 2 percent slopes	4.67	33.2%		IIIw	51	56	64
132B	Weller silt loam, 2 to 5 percent slopes	2.89	20.5%		IIIe	67	60	82
131C	Pershing silt loam, 5 to 9 percent slopes	2.68	19.0%		IIIe	65	49	60
131B	Pershing silt loam, 2 to 5 percent slopes	1.26	8.9%		IIIe	70	67	62
132C	Weller silt loam, 5 to 9 percent slopes	1.04	7.4%		IIIe	59	44	75
792D2	Armstrong loam, 9 to 14 percent slopes, moderately eroded	1.02	7.2%		IVe	9	13	44
223D2	Rinda silty clay loam, 9 to 14 percent slopes, moderately eroded	0.52	3.7%		IVe	19	9	44
Weighted Average						55	50.7	*n 65.4

**IA has updated the CSR values for each county to CSR2.

*n: The aggregation method is "Weighted Average using all components"

*c: Using Capabilities Class Dominant Condition Aggregation Method

Soils data provided by USDA and NRCS.