

Soils Map

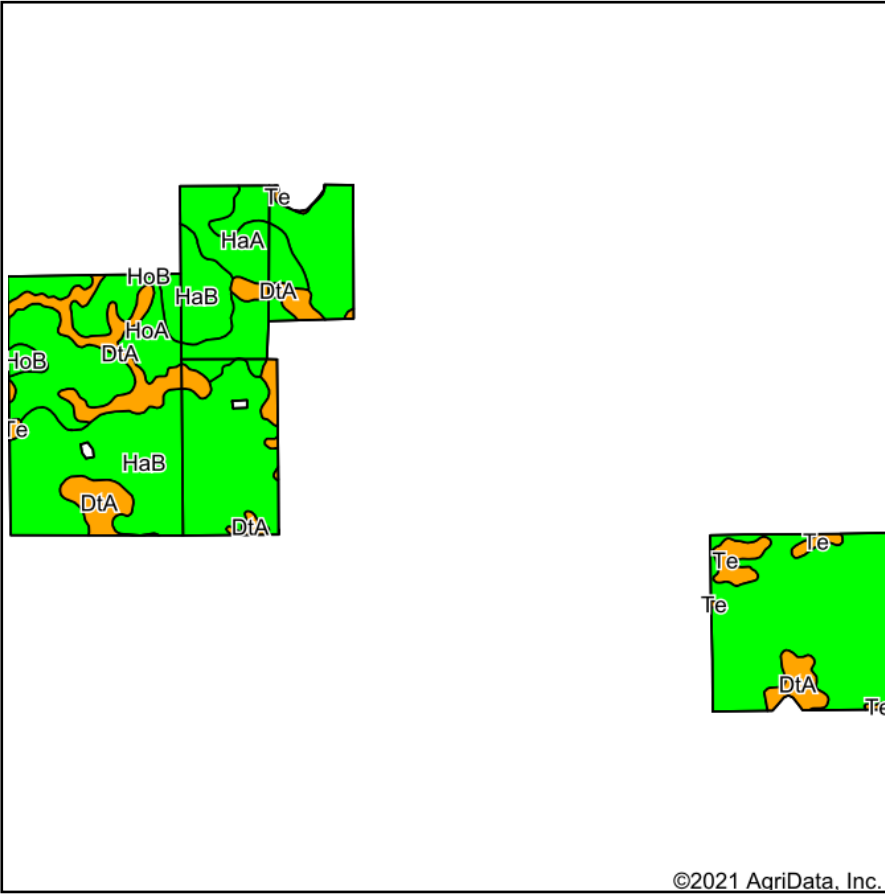

Soils data provided by USDA and NRCS.

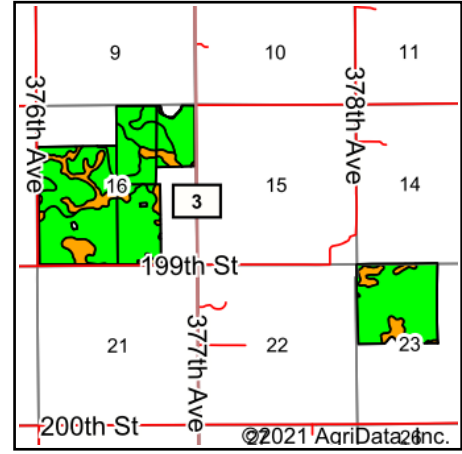

State: **South Dakota**
 County: **Beadle**
 Location: **15-112N-65W**
 Township: **Whiteside**
 Acres: **609.57**
 Date: **8/6/2021**



Maps Provided By:



Area Symbol: SD005, Soil Area Version: 25

Code	Soil Description	Acres	Percent of field	PI Legend	Non-Irr Class *c	Productivity Index	*n NCCPI Overall
HaB	Hand-Bonilla loams, 3 to 6 percent slopes	375.54	61.6%		Ile	79	51
HoA	Houdek-Prosper loams, 0 to 2 percent slopes	104.61	17.2%		IIc	88	64
DtA	Dudley-Tetonka silt loams	74.61	12.2%		IVs	43	24
HaA	Hand-Bonilla loams, 0 to 3 percent slopes	34.82	5.7%		IIc	85	51
Te	Tetonka-Hoven silt loams	15.09	2.5%		IVw	48	11
HoB	Houdek-Prosper loams, 1 to 6 percent slopes	4.90	0.8%		Ile	84	63
Weighted Average						75.8	*n 49

*n: The aggregation method is "Weighted Average using all components"

*c: Using Capabilities Class Dominant Condition Aggregation Method

Soils data provided by USDA and NRCS.