

WV STATE DEPARTMENT OF HEALTH
Office of Environmental Health Services
ENVIRONMENTAL ENGINEERING DIVISION

SW258

WELL COMPLETION REPORT

Date(s) July 27, 93 County Hampshire Permit #: DW-14-07-94-24
Town: LARGENT Area Name/Location CROSSINGS LOT 21
Well Owner: JOHN DAUS Address: 2168 WOLFTRAP COURT
Telephone Number: 703 204-1226 VIENNA, VA 22182
Well Driller: JERRY W ADAMS Address: P.O. Box 952
Telephone Number: 304 822-4092 ROMNEY, WV 26757

WELL LOG

DEPTH IN FEET	FORMATIONS: KIND, THICKNESS, AND IF WATER BEARING	REMARKS:
0-10'	BROWN SHALE - UNCONSOLIDATED	Type of Well: <u>D/W</u> Drilling Method: <u>AIR ROTARY HAMM</u>
10'	SAND & GRAVEL - UNCONSOLIDATED	Well Diameter: <u>6"</u> Casing O.D.: <u>6-5/8"</u>
21'	Limestone - Consolidated	Well Depth: <u>180'</u> Date Completed: <u>7-27-93</u>
31'	limestone - Consolidated	CASING: Length _____ Feet Height above ground _____ Feet
	Set Casing - GROUT	<input checked="" type="checkbox"/> Steel <input type="checkbox"/> Plastic <input type="checkbox"/> Cast Iron
80'	Limestone - Consolidated	Other _____ Type _____
140'	limestone - Consolidated	
165'	limestone - WATER 70 GPM SCREEN	
180'	limestone - Consolidated	<input checked="" type="checkbox"/> None Installed
	TEST Well Yield - Stopped	Type _____ Diameter _____
	DRILLING operation	Slot/Gauge _____ Length _____
		Set Between _____ Ft. and _____ Ft.

PUMPING OR BAILING TEST

DETAILS	#1	#2	#3
Static Water Level (Ft. Below Grade)	<u>60</u>		
Pumping Rate (GPM)	<u>70</u>		
Pumping Level (Ft Below Grade)	<u>155</u>		
Duration of Test (In Hours)	<u>1</u>		
Recovery Time to Static Level (In Hours)	<u>1/2</u>		

WELL HEAD

Pitless Adapter: Type, Make, Etc. To Be installed w/ Pump Syst
Well Cap: Type, Make, Etc. Royer 6-5/8" Conduit - Type
Well Seal: Type, Make, Etc. _____
Well Platform: _____
Length _____ Width _____ Thickness _____
Grouting: ☒ Yes ☐ No
All Public Water Supplies must be grouted.

I hereby certify that this well was drilled and constructed under my supervision, in compliance with all requirements of the referenced permit, and that this record is true to the best of my knowledge and belief.

Jerry W Adams 004
Name H & S Well Drilling Certification No.
Registered Business Name
Signed Jerry W Adams Date 7-28-93

WEST VIRGINIA
SEPTIC TANK INSPECTION FORM

Hampshire County Health Department Installation Permit No. ST-14-93-337
 Name of Owner John Daws
 Address 2168 Wolftrap Ct., Vienna, VA 22182
 Property Address Crossings Lot #21

DESCRIPTION & NUMBER OF UNITS SERVED

Type Facility Served cabin No. Water Closets
 Lot Size 2+ acres sq. ft. Area suitable for sewage disposal installation sq. ft.
 Source of Water Supply well No. Lavatories
 No. Bedrooms 2 No. Showers or Tubs No. Baths
 No. Garbage Grinders No. Automatic Washers

SEPTIC TANK

Material precast Length x Width x Depth = cubic feet
 Liquid Depth ft. Liquid Capacity 1000 gal.
 Distance to: Dwelling 15' Water Supply 50' Nearest Property Line 70'

SOIL ABSORPTION SYSTEM

Type Drain Line Material plastic Trench Width 36 Inches
 Trench Depth 25-27 Inches Total Absorption area in Trench Bottom 900 sq. ft.
 Diameter of Drain Line 4 Inches Type Filter Media gravel - 35 ton
 No. of Drain Lines 3 Depth Filter Media Under Drain Line 10 Inches
 Length of Each Line 100, 100, 100, ft. Depth Filter Media Over Drain Line 2 in
 Distance of Disposal Field to: (a) Dwelling 275'
 (b) Water Supply 280' (c) Nearest Property Line 25'

An inspection of the septic tank system described herein disclosed that said system (MEETS, DOES NOT MEET) the minimum standards established by the West Virginia State Department of Health.

Date

10-15-93

Sanitarian

David Dufort

SKETCH OF SYSTEM TO BE DRAWN ON BACK

Note: Copy of this inspection report must be given to owner and the original filed in the Health Department files, PERMANENT RECORD - DO NOT DESTROY.

JOHN DAVIS
(Vienna, VA)

- * PIN OAK
- * THE CROSSINGS
- * LOT #21
- * ST-14-93-337

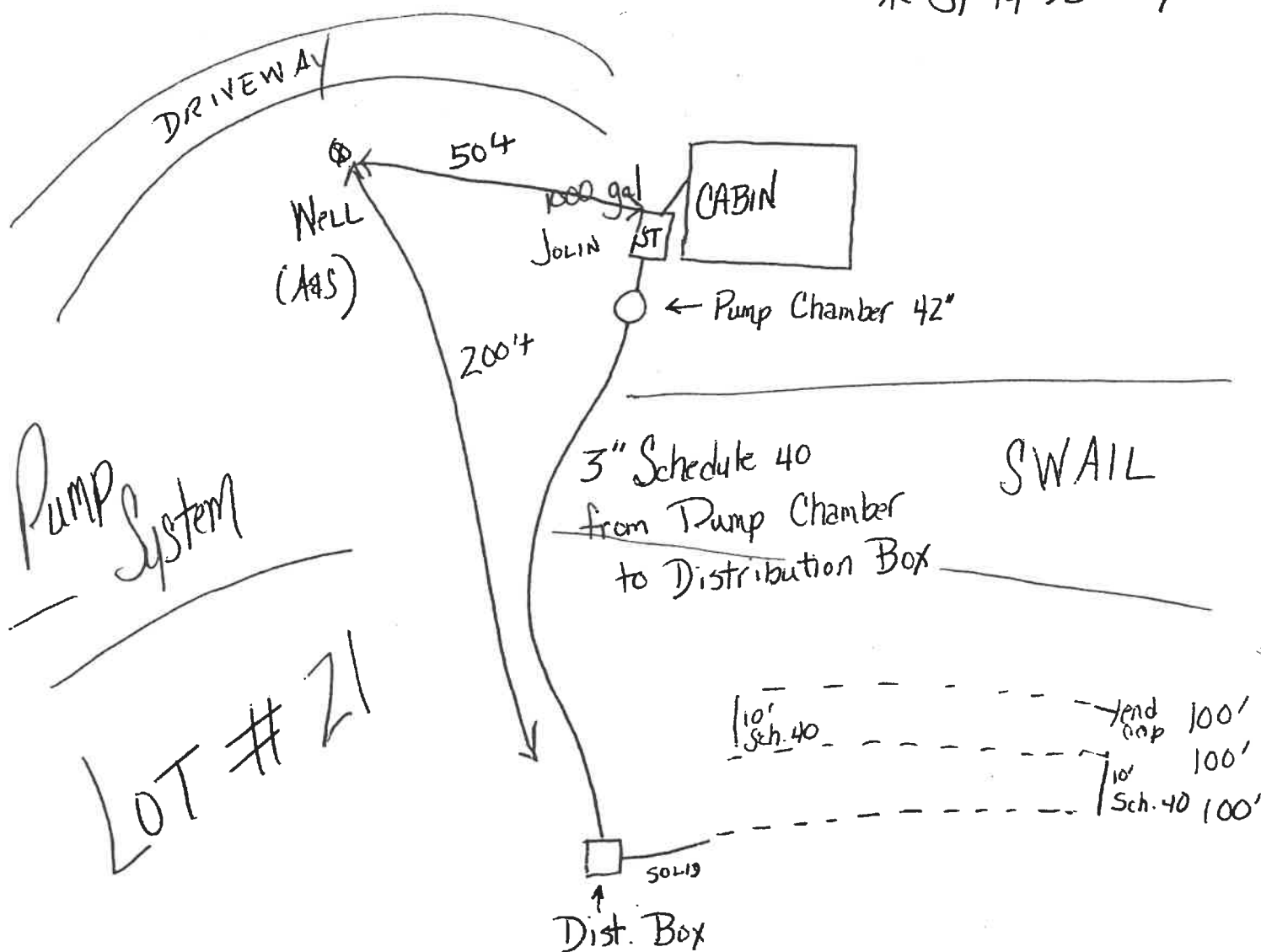

* Pump And Electric to the Pump Installed by
A & S Pump Co.

* All Sewer Lines in Drainfield are level to 2" inches.

* System Installed October 7, 1993.

Installer
Calvin Davis
54-83-124