

Soils Map

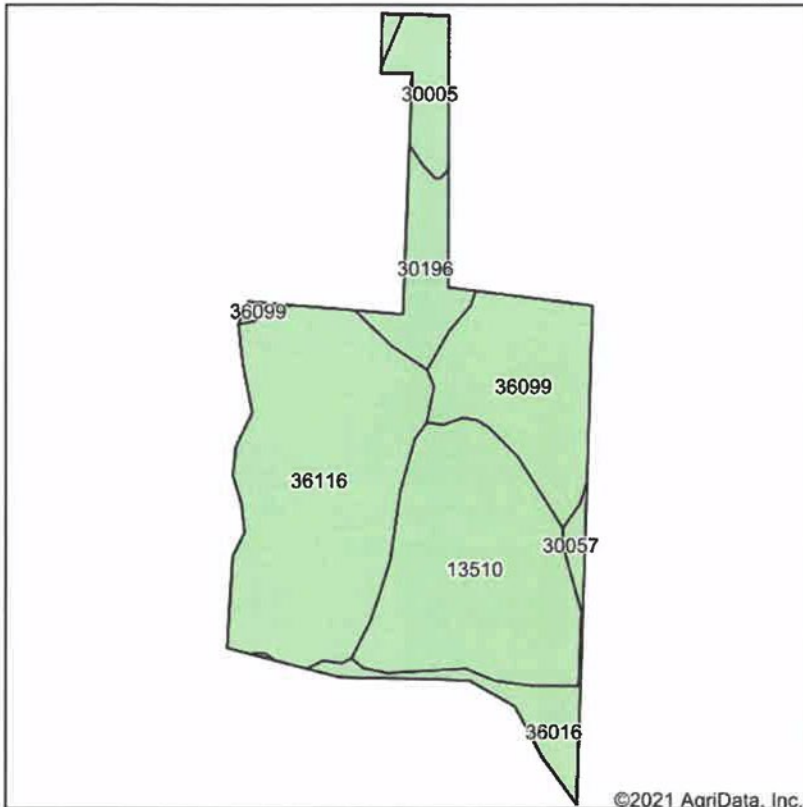

Soils data provided by USDA and NRCS.



State: **Missouri**
 County: **Harrison**
 Location: **6-64N-26W**
 Township: **Trail Creek**
 Acres: **26.47**
 Date: **9/30/2021**

United Country
 NELSON REAL ESTATE

Maps Provided By:

surety
 CUSTOMIZED ONLINE MAPPING
 © AgriData, Inc. 2021 www.AgriDataInc.com



Area Symbol: MO081, Soil Area Version: 24

Code	Soil Description	Acres	Percent of field	Non-Irr Class *c	Alfalfa hay	Caucasian bluestem	Common bermudagrass	Orchardgrass red clover	Tall fescue	Warm season grasses
36116	Zook silty clay loam, heavy till, 0 to 2 percent slopes, occasionally flooded	9.82	37.1%	IIw						
13510	Colo silty clay loam, heavy till, 0 to 2 percent slopes, occasionally flooded	7.55	28.5%	IIw						
36099	Zook-Colo silty clay loams, 1 to 3 percent slopes, frequently flooded	4.42	16.7%	IIIw			8	7	8	9
30196	Shelby clay loam, 9 to 14 percent slopes, severely eroded	1.87	7.1%	IVe						
36016	Humeston silt loam, 0 to 2 percent slopes, occasionally flooded	1.27	4.8%	IIIw						
30005	Adair loam, 3 to 9 percent slopes	1.24	4.7%	IIIe	5	8	7	8	7	8
30057	Gara loam, 14 to 18 percent slopes	0.30	1.1%	VIe						
Weighted Average					0.2	0.4	1.7	1.5	1.7	1.9

*c: Using Capabilities Class Dominant Condition Aggregation Method