

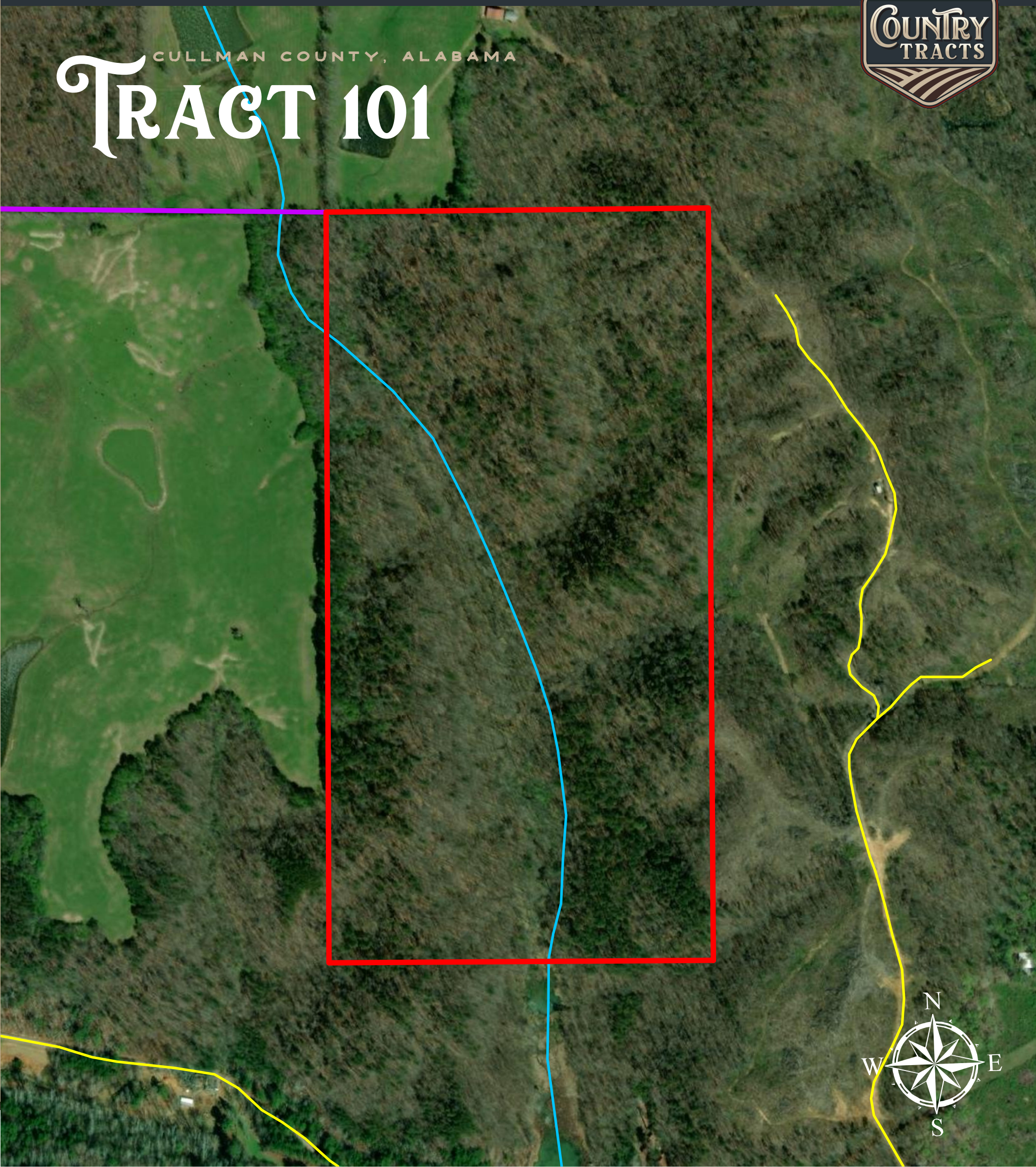

CULLMAN COUNTY, ALABAMA

TRACT 101



LEGEND

-  Road
-  Easement road
-  Creek
-  Parcel boundary

FEATURES

- Convenient to Highway
- Rolling Topography
- Abundant Wildlife
- Unrestricted

83 Acres

WWW.COUNTRYTRACTS.COM