

# Soils Map

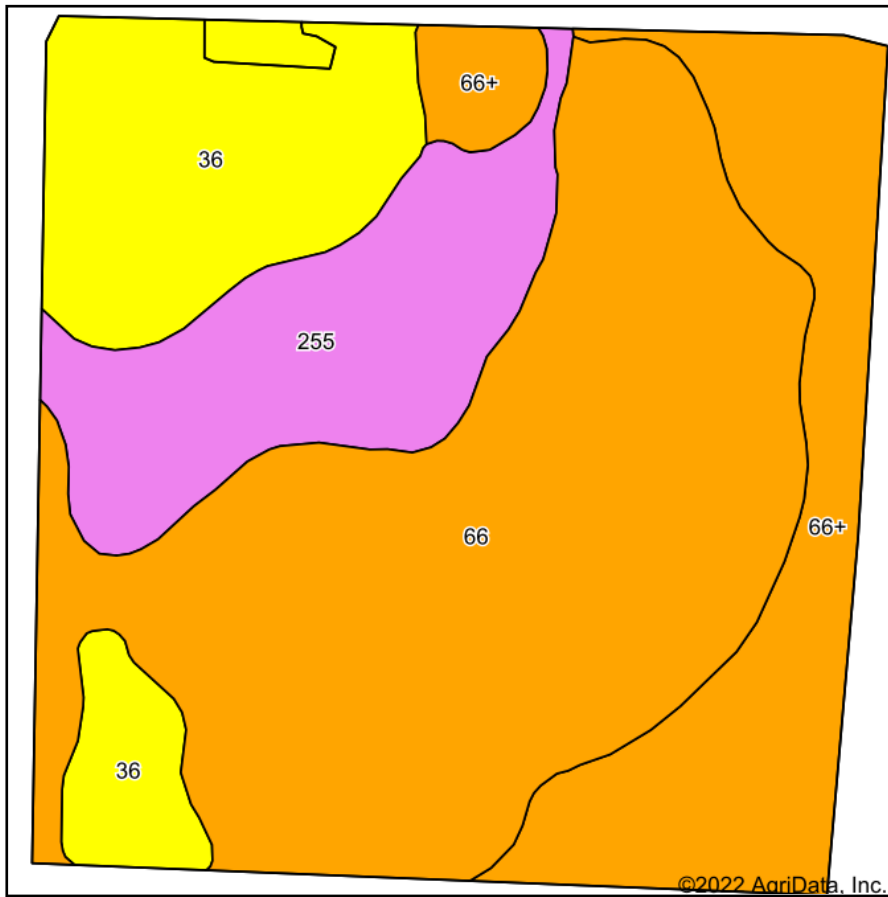

Soils data provided by USDA and NRCS.

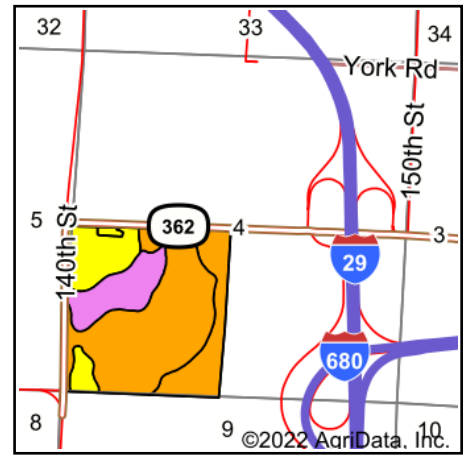

State: **Iowa**  
 County: **Pottawattamie**  
 Location: **4-77N-44W**  
 Township: **Rockford**  
 Acres: **153.16**  
 Date: **1/28/2022**



Maps Provided By:



Area Symbol: IA155, Soil Area Version: 27

Code	Soil Description	Acres	Percent of field	CSR2 Legend	Non-Irr Class *c	CSR2**	CSR	*n NCCPI Soybeans
66	Luton silty clay, 0 to 2 percent slopes	72.92	47.6%		IIIw	54	40	53
66+	Luton silt loam, overwash, 0 to 2 percent slopes	29.83	19.5%		IIIw	53	45	58
36	Salix silty clay loam, 0 to 2 percent slopes	27.18	17.7%		I	100	85	97
255	Cooper silty clay loam, 0 to 2 percent slopes	23.23	15.2%		IIw	82	70	61
<b>Weighted Average</b>					<b>2.49</b>	<b>66.2</b>	<b>53.5</b>	<b>*n 63</b>

\*\*IA has updated the CSR values for each county to CSR2.

\*n: The aggregation method is "Weighted Average using all components"

\*c: Using Capabilities Class Dominant Condition Aggregation Method

Soils data provided by USDA and NRCS.