

**Stand Map**  
**WY - Madison**  
**Parcel # 28089Hb0011**  
 Madison County, MS - approx. 452.0 acres +/-

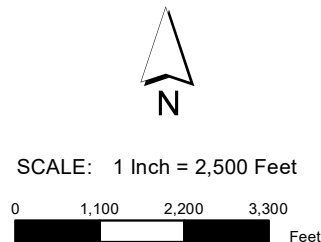
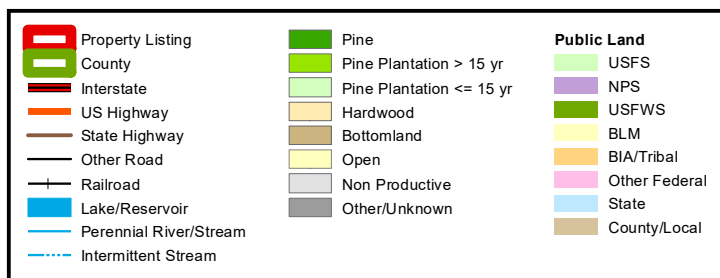

Stand #	Cover Type	Age	Acres
NP	Non Productive	NA	13.3
1	Open	1	259.6
2	Hardwood	69	85.3
5	Hardwood	69	59.7
6	Hardwood	69	22.1
11	Hardwood	69	3.8
16	Pine Plantation > 15 yr	20	5.1

Smaller stands have been excluded to fit in the allowable space