

## New Listing

Maps and additional information at [hciutah.com](http://hciutah.com)

# Cedar Valley Land

160 acres south of Eagle Mountain, Utah County, Utah

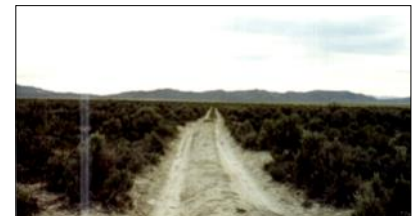
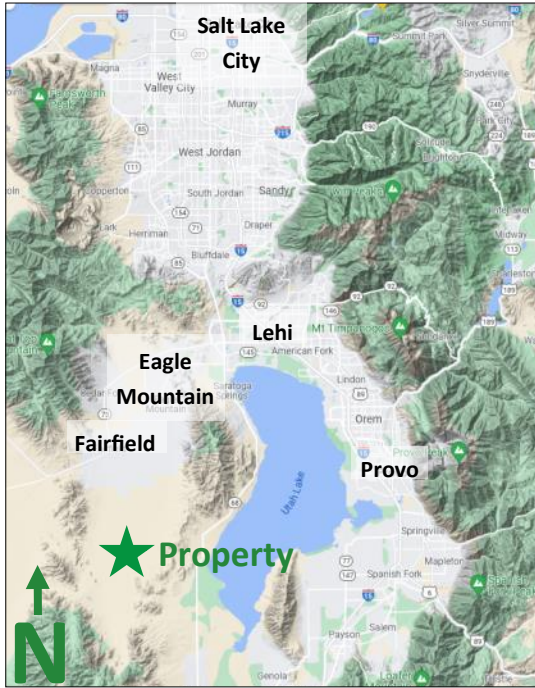

## EXECUTIVE SUMMARY:

**List Price: \$320,000**

**Joe Nelson • [joe@hciutah.com](mailto:joe@hciutah.com)  
801-482-7560 • 801-487-6100**

**Mike Nelson | Gary Nelson**

Notice: This information is believed to be accurate, but no warranty is expressed or implied. Highland Commercial insists that interested parties conduct their own research and investigations. The property is offered subject to prior sale, price change, and withdrawal without notice. No obligations will be created unless a purchase contract is signed by both buyer and seller. We welcome the cooperation of participating brokers; please contact us for our commission-sharing policies. All images and materials are copyright protected and are the property of Highland Commercial.

- 160 acres 4.7 miles south of Eagle Mountain, Utah
- Zoned in Utah County M&G-1 for mining & grazing (50-acre minimum lot size)
- Utah County parcel #: 59-142-0003
- 2021 Taxes: \$1,319.88
- No water rights
- 2.3 miles from Fairfield, Utah
- 4.7 miles from Eagle Mountain, Utah
- 15.5 miles from Lehi, Utah
- 17.2 miles from Provo, Utah
- 38 miles from Salt Lake City, Utah



Highland Commercial, Inc.  
2733 East Parley's Way, Suite 208  
Salt Lake City, UT 84109  
801-487-6100

[www.hciutah.com](http://www.hciutah.com)



