

Soils Map

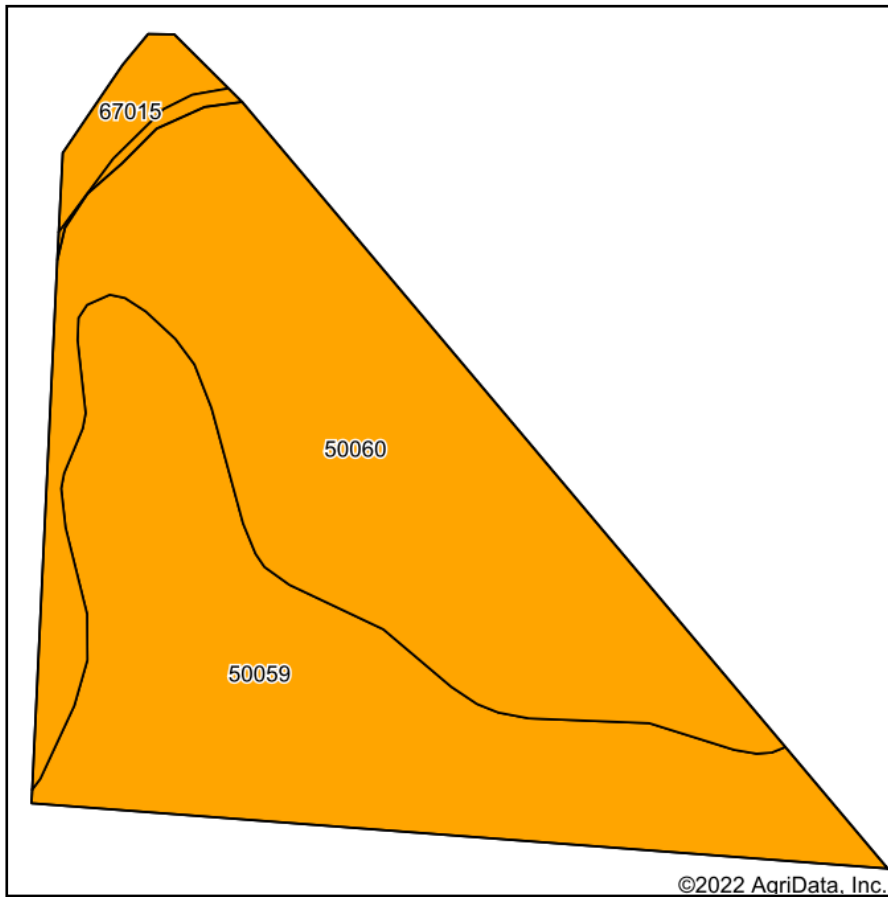

Soils data provided by USDA and NRCS.

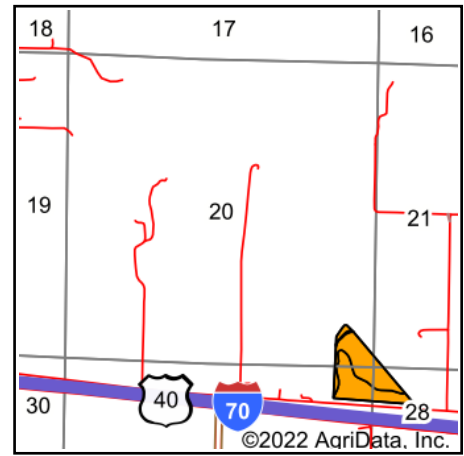

State: **Missouri**
 County: **Montgomery**
 Location: **29-48N-5W**
 Township: **Danville**
 Acres: **23.53**
 Date: **4/4/2022**

TA Tom Anderson
 • REAL ESTATE •

Maps Provided By:

surety
 CUSTOMIZED ONLINE MAPPING
 © AgriData, Inc. 2021 www.AgriDataInc.com



Area Symbol: MO139, Soil Area Version: 21									
Code	Soil Description	Acres	Percent of field	Non-Irr Class Legend	Non-Irr Class *c	*n NCCPI Overall	*n NCCPI Corn	*n NCCPI Small Grains	*n NCCPI Soybeans
50060	Mexico silty clay loam, 1 to 4 percent slopes, severely eroded	12.17	51.7%		IIIe	65	65	57	47
50059	Mexico silt loam, 1 to 4 percent slopes, eroded	10.68	45.4%		IIIe	72	72	62	54
67015	Belknap silt loam, 1 to 3 percent slopes, frequently flooded	0.68	2.9%		IIIw	62	61	54	60
Weighted Average					3.00	*n 68.1	*n 68.1	*n 59.2	*n 50.6

*n: The aggregation method is "Weighted Average using all components"

*c: Using Capabilities Class Dominant Condition Aggregation Method

Soils data provided by USDA and NRCS.