

Tillable Soils Map

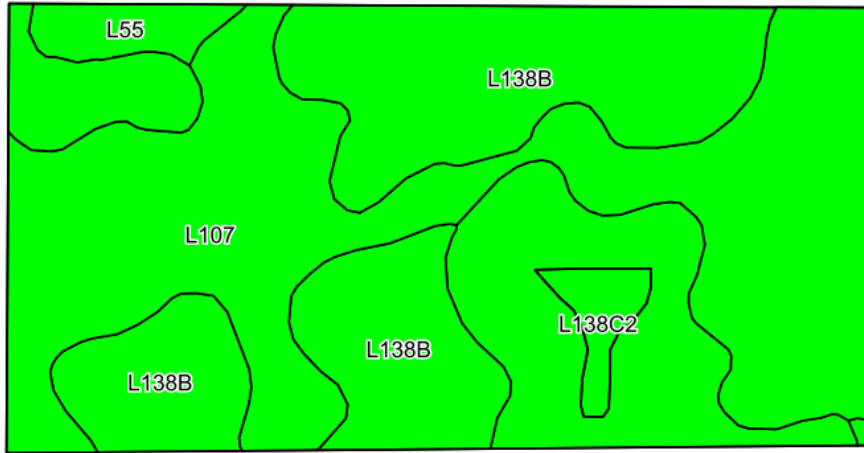

©2022 AgriData, Inc.

Soils data provided by USDA and NRCS.

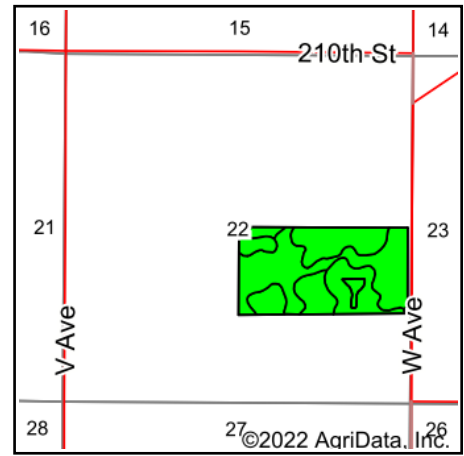

State: **Iowa**
 County: **Dallas**
 Location: **22-80N-26W**
 Township: **Grant**
 Acres: **77.93**
 Date: **6/8/2022**



Maps Provided By:



Area Symbol: IA049, Soil Area Version: 27

Code	Soil Description	Acres	Percent of field	CSR2 Legend	Non-Irr Class *c	*i Corn Bu	*i Soybeans Bu	CSR2**	*n NCCPI Overall
L107	Webster clay loam, Bemis moraine, 0 to 2 percent slopes	34.70	44.5%		IIw	0.0	0.0	88	84
L138B	Clarion loam, Bemis moraine, 2 to 6 percent slopes	28.46	36.5%		IIe	80.0	23.2	88	80
L138C2	Clarion loam, Bemis moraine, 6 to 10 percent slopes, moderately eroded	12.77	16.4%		IIIe	0.0	0.0	83	67
L55	Nicollet loam, 1 to 3 percent slopes	2.00	2.6%		Ie	0.0	0.0	91	85
Weighted Average					2.14	29.2	8.5	87.3	*n 79.8

**IA has updated the CSR values for each county to CSR2.

*i Yield data provided by the ISPAID Database version 8.1.1 developed by IA State University.

*n: The aggregation method is "Weighted Average using all components"

*c: Using Capabilities Class Dominant Condition Aggregation Method

Soils data provided by USDA and NRCS.