

Soils Map

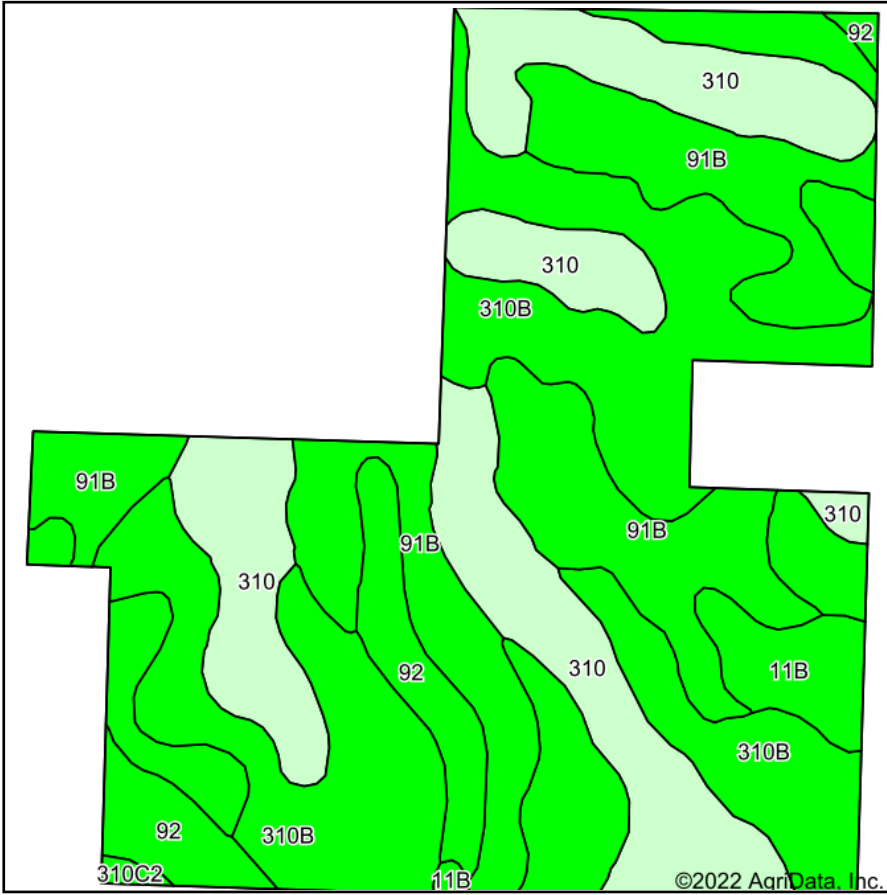

Soils data provided by USDA and NRCS.

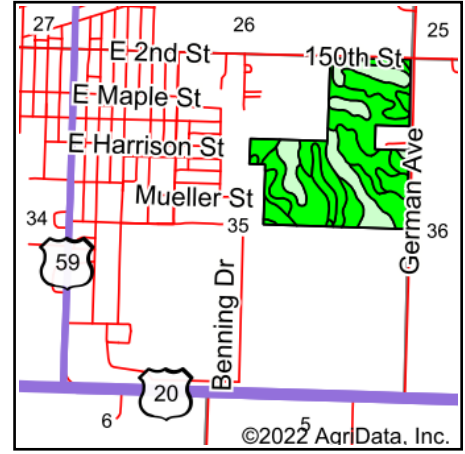







State: **Iowa**
 County: **Ida**
 Location: **35-89N-40W**
 Township: **Griggs**
 Acres: **102.09**
 Date: **7/11/2022**

MIDWEST LAND & REAL ESTATE, INC
 712-262-3110 MANAGEMENT
 Maps Provided By:

 CUSTOMIZED ONLINE MAPPING
 © AgriData, Inc. 2021 www.AgriDataInc.com



Area Symbol: IA093, Soil Area Version: 32

Code	Soil Description	Acres	Percent of field	CSR2 Legend	CSR2**	CSR
310B	Galva silty clay loam, 2 to 5 percent slopes	35.66	34.9%		95	73
91B	Primghar silty clay loam, 2 to 5 percent slopes	29.22	28.6%		95	81
310	Galva silty clay loam, 0 to 2 percent slopes	25.68	25.2%		100	78
92	Marcus silty clay loam, 0 to 2 percent slopes	6.91	6.8%		94	78
11B	Colo-Judson silty clay loams, 0 to 5 percent slopes, occasionally flooded	4.35	4.3%		80	62
310C2	Galva silty clay loam, 5 to 9 percent slopes, eroded	0.27	0.3%		84	55
Weighted Average					95.5	76.4

**IA has updated the CSR values for each county to CSR2.
 Soils data provided by USDA and NRCS.