

(ans)

FIELDNOTE DESCRIPTION

TRACT 5 - 14.20 ACRE TRACT

Being a 14.20 acre tract of land in the Louis F. Marqueratt Survey, Abstract No. 273, Milam County, Texas and being a part of that certain called 50 acre tract of land designated **SECOND TRACT** in a deed to Walter E. Eickenhorst and Evona Eickenhorst, Trustees, recorded in Volume 1006, Page 189 of the Official Records of Milam County, Texas (ORMCT). Said 14.20 acre tract being shown on attached plat and more particularly described by metes and bounds as follows:

Commencing at a 14" elm tree for a fence corner being the northeast corner of above mentioned 50 acre tract, same being the southeast corner of a 79.003 acre tract of land to George Tonn (719/801 ORMCT), in the west line of a 40 acre tract of land to Johanna Doscocil, et al, (1305/567 ORMCT), at or near the east line of said Marqueratt Survey, same being the west line of the John Beal Survey, Abstract No. 86;

Thence along the north line of said 50 acre tract, same being the south line of said 79.003 acre tract, South 59 degrees 07 minutes 40 seconds West, a distance of 562.87 feet to a set ½" iron rod with yellow cap stamped "RPLS 5345" for the **POINT OF BEGINNING**;

THENCE crossing said 50 acre tract, South 30 degrees 52 minutes 20 seconds East, a distance of 1119.44 feet to a set ½" iron rod with yellow cap stamped "RPLS 5345" located on or near the north right-of-way line of County Road 134;

THENCE along or near the north right-of-way line of County Road 134, South 59 degrees 07 minutes 40 seconds West, a distance of 552.46 feet to a set ½" iron rod with yellow cap stamped "RPLS 5345";

THENCE crossing said 50 acre tract, North 30 degrees 52 minutes 20 seconds West, a distance of 1119.44 feet to a set ½" iron rod with yellow cap stamped "RPLS 5345" in the south line of said 79.003 acre tract;

THENCE along the north line of said 50 acre tract, same being the south line of said 79.003 acre tract, North 59 degrees 07 minutes 40 seconds East, a distance of 552.46 feet to the **POINT OF BEGINNING**, containing 14.20 acres of land.

All bearings recited herein are referenced to Geodetic North.

June 16, 2020
Don Randall Hughes
Registered Professional Land Surveyor
Texas No. 5345

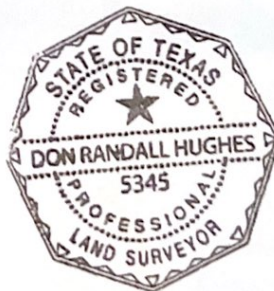
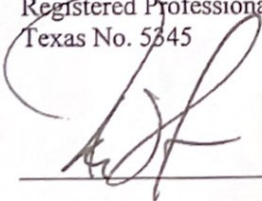

PAL