

# Soils Map

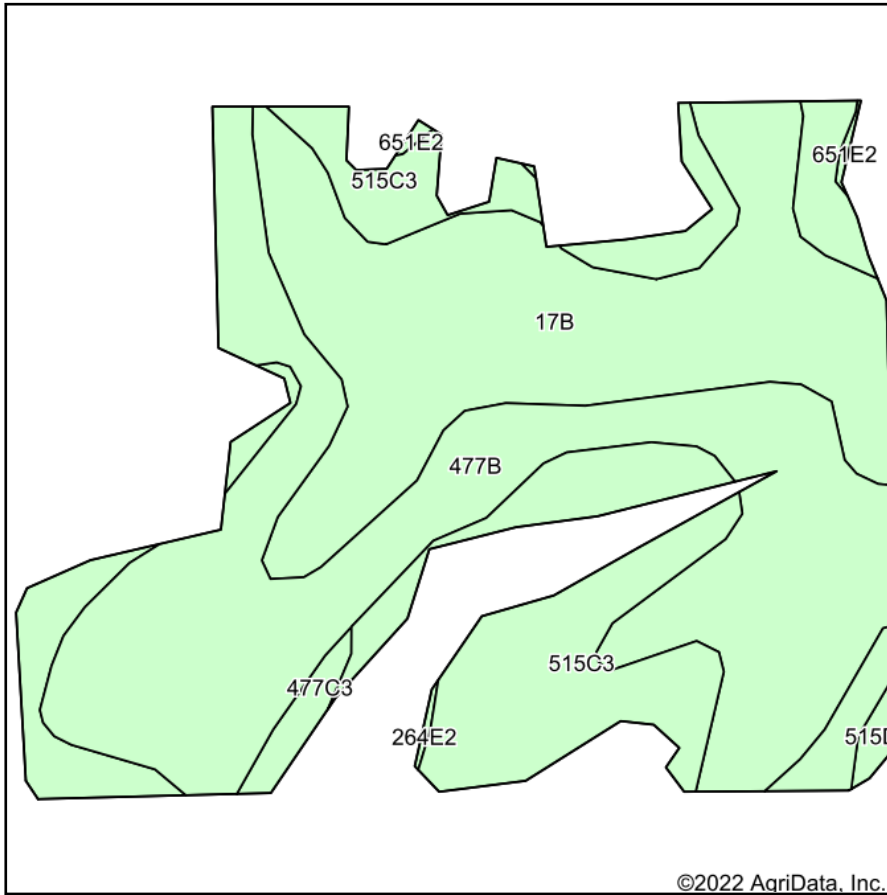

Soils data provided by USDA and NRCS.

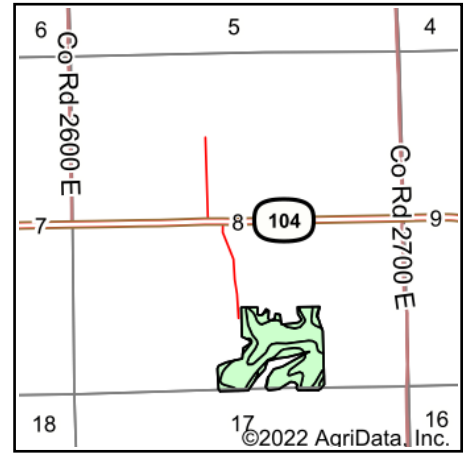

State: **Illinois**  
 County: **Adams**  
 Location: **8-3S-5W**  
 Township: **Beverly**  
 Acres: **36.2**  
 Date: **9/2/2022**

Maps Provided By:  
**surety**  
 CUSTOMIZED ONLINE MAPPING  
 © AgriData, Inc. 2021 www.AgriDataInc.com



Area Symbol: IL001, Soil Area Version: 20

Code	Soil Description	Acres	Percent of field	Subsoil rooting <b>a</b>	Corn Bu/A	Soybeans Bu/A	Wheat Bu/A	Oats Bu/A <b>b</b>	Sorghum <b>c</b> Bu/A	Alfalfa <b>d</b> hay, T/A	Grass-legume <b>e</b> hay, T/A	Crop productivity index for optimum management
**477B	Winfield silt loam, 2 to 5 percent slopes	14.45	39.9%	FAV	**160	**50	**62	0	**122	**4.97	0.00	**118
**17B	Keomah silt loam, 2 to 5 percent slopes	11.10	30.7%	FAV	**159	**50	**64	**82	0	0.00	**5.09	**118
**515C3	Bunkum silty clay loam, 5 to 10 percent slopes, severely eroded	8.44	23.3%	FAV	**126	**43	**48	0	**97	**3.35	0.00	**95
**477C3	Winfield silty clay loam, 5 to 10 percent slopes, severely eroded	1.89	5.2%	FAV	**139	**43	**54	0	**106	**4.32	0.00	**102
**515D3	Bunkum silty clay loam, 10 to 18 percent slopes, severely eroded	0.23	0.6%	FAV	**118	**41	**45	0	**92	**3.15	0.00	**89
**651E2	Keswick loam, 18 to 25 percent slopes, eroded	0.09	0.2%	FAV	**83	**29	**31	**40	0	0.00	**2.63	**63
<b>Weighted Average</b>					<b>150.2</b>	<b>47.9</b>	<b>58.7</b>	<b>25.2</b>	<b>77.4</b>	<b>3.01</b>	<b>1.57</b>	<b>111.5</b>

**Table: Optimum Crop Productivity Ratings for Illinois Soil by K.R. Olson and J.M. Lang, Office of Research, ACES, University of Illinois at Champaign-Urbana.** Version: 1/2/2012 Amended Table S2 B811

Crop yields and productivity indices for optimum management (B811) are maintained at the following NRES web site: <http://soilproductivity.nres.illinois.edu/>

\*\* Indexes adjusted for slope and erosion according to Bulletin 811 Table S3

**a** UNF = unfavorable; FAV = favorable

**b** Soils in the southern region were not rated for oats and are shown with a zero "0".

**c** Soils in the northern region or in both regions were not rated for grain sorghum and are shown with a zero "0".

**d** Soils in the poorly drained group were not rated for alfalfa and are shown with a zero "0".

**e** Soils in the well drained group were not rated for grass-legume and are shown with a zero "0".

Soils data provided by USDA and NRCS. Soils data provided by University of Illinois at Champaign-Urbana.