

Soils Map

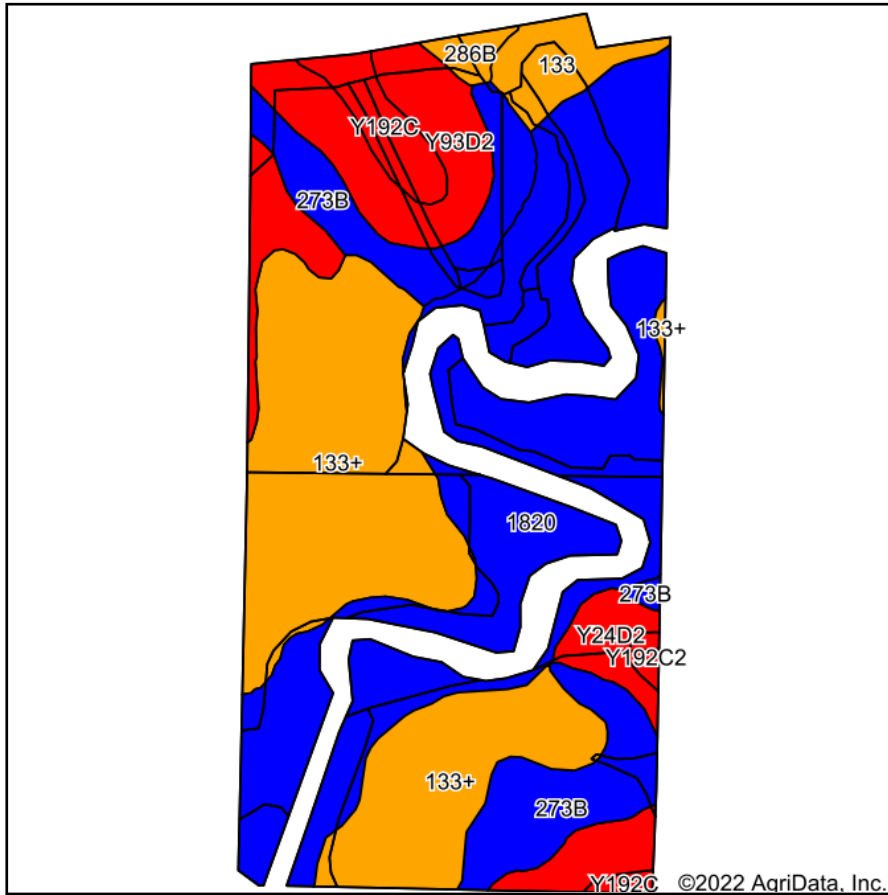

Soils data provided by USDA and NRCS.

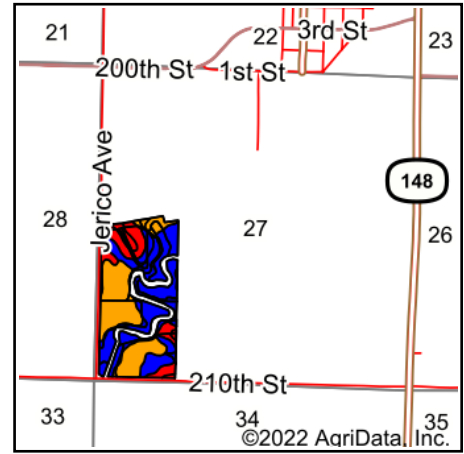

State: **Iowa**
 County: **Taylor**
 Location: **27-69N-34W**
 Township: **Washington**
 Acres: **68.91**
 Date: **8/29/2022**

Maps Provided By:

 CUSTOMIZED ONLINE MAPPING
 © AgriData, Inc. 2021 www.AgriDataInc.com



Area Symbol: IA173, Soil Area Version: 32

Code	Soil Description	Acres	Percent of field	CSR2 Legend	Non-Irr Class *c	CSR2**	CSR
1820	Dockery-Quiver silt loams, 0 to 2 percent slopes, occasionally flooded	23.91	34.7%		IIw	87	
133+	Colo silt loam, deep loess, 0 to 2 percent slopes, overwash, occasionally flooded	21.34	31.0%		IIw	78	85
273B	Olmitz loam, 2 to 5 percent slopes	8.69	12.6%		Ile	89	72
Y93D2	Shelby-Adair clay loams, dissected till plain, 9 to 14 percent slopes, eroded	5.15	7.5%		IIIe	35	
Y24D2	Shelby clay loam, dissected till plain, 9 to 14 percent slopes, eroded	3.08	4.5%		IIIe	49	
133	Colo silty clay loam, deep loess, 0 to 2 percent slopes, occasionally flooded	2.10	3.0%		IIw	78	80
Y192C	Adair clay loam, dissected till plain, 5 to 9 percent slopes	2.02	2.9%		IIIe	36	
248	Wabash silty clay loam, 0 to 1 percent slopes	1.71	2.5%		IIIw	37	60
286B	Colo-Judson-Nodaway complex, 0 to 5 percent slopes	0.63	0.9%		IIw	80	65
Y192C2	Adair clay loam, dissected till plain, 5 to 9 percent slopes, eroded	0.28	0.4%		IIIe	33	
Weighted Average					2.18	75.6	*-

**IA has updated the CSR values for each county to CSR2.

*- CSR weighted average cannot be calculated on the current soils data, use prior data version for csr values.

*c: Using Capabilities Class Dominant Condition Aggregation Method

Soils data provided by USDA and NRCS.