

Still Waters A - 18.5 Acres

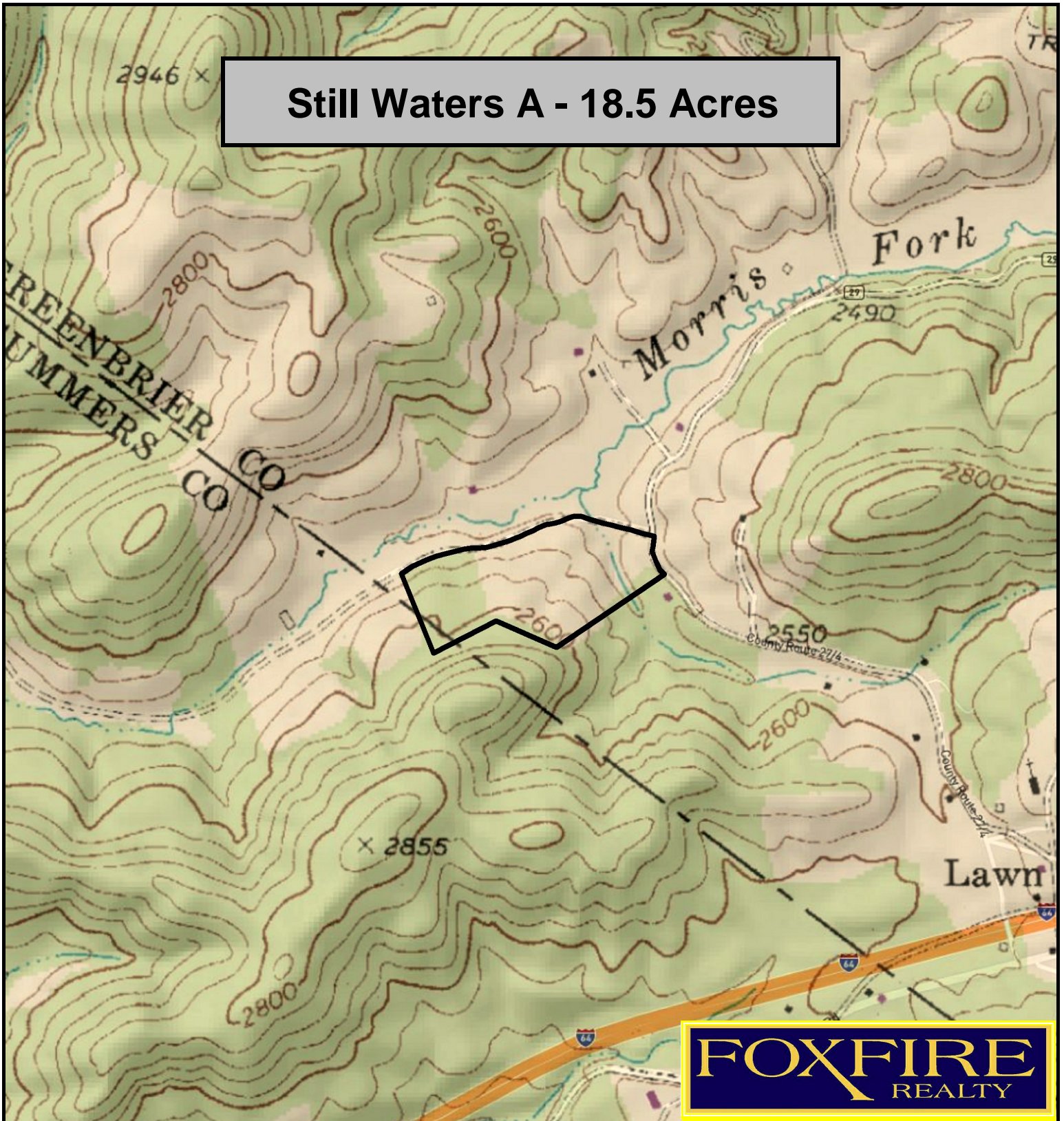

FOXFIRE
REALTY

Still Waters A, Greenbrier County, WV
TOPOGRAPHIC MAP
Elevation Range: 2485' - 2648' +/- Google Coordinates:
LAT 37.845979 (N), LON -80.761113 (W)
This map is for general location purposes only. Consult a licensed
land surveyor for actual boundary location and acreage.

RICHARD GRIST, Broker - Auctioneer - Forester
304.646.8837 Richard@Foxfirenation.com
WWW.FOXFIRENATION.COM



FOR TOPO MAP

SCALE 1:9600

1 INCH = 800 FT.

