

# County Department of Public Health

Permit Number MM11802-1

Improvement Permit 2-13-07 Expiration Date -- Transferable

Authorization for Wastewater System Construction (Expires five years from date of issuance of Improvement Permit)

Operation Permit IIa System Classification Type \_\_\_\_\_ Authorization to Connect to Wastewater System

X PIN NUMBER: 165923Z1

APPLICANT NAME: PASCHAL

MARY

## PROPERTY INFORMATION

## OWNER INFORMATION

Road Name: MASSEY ROAD

Subd/Park:

Section :

Lot # :

MASSEY THOMAS

1078 GARRISON RD

REIDSVILLE

NC 27320

Lot Size : 10AC

Water Supply : PRIVATE WELL

87 S GROOMS RD, R ON MASSEY RD - SITE ON L NEAR END OF RD

X House 3 #bedrooms  
Singlewide 4 #people  
Doublewide X basement  
Commercial \_\_\_\_\_ basement w/  
Food Service \_\_\_\_\_ plumbing  
Seats \_\_\_\_\_ addition  
Other \_\_\_\_\_

### TYPE SYSTEM

X New \_\_\_\_\_ Repair \_\_\_\_\_ Expansion  
X Conventional \_\_\_\_\_ Existing  
L.P.P. \_\_\_\_\_ Pump  
Saprolite .1956(6) \_\_\_\_\_  
Innovative \_\_\_\_\_  
Other \_\_\_\_\_

IMP NAME DATE

Rockingham Septic  
INSTALLER

INSTALLATION CONDITIONS

\* Repair = Conventional

\* Move driveway and  
gutters away from septic  
system areas.

\* INSTALL ON CONTOUR\*  
\* LANDSCAPE PROMPTLY\*

LAYOUT	SPECIFICATIONS	INSTALLED
1000gal	Septic Tank	zabel Filter 1275-03 RST-770
-	Pump Tank	9 1/2" Fall from Tank
1310 ft <sup>2</sup>	Drainfield sq ft	
P. well	Water Supply	
1	# of lines	3
440'	Total length of lines	150', 160', 130'
24"	Trench depth	✓
36"	Trench width	✓
6"	Depth of rock below pipe	✓
12"	Total rock depth	✓
75'	Distance to foundation	42'
710'	Distance to property lines	710'
7106'	Distance to well	
-	Watershed	

### AUTHORIZATION FOR WASTEWATER SYSTEM CONSTRUCTION

### OPERATION PERMIT

2/4/04 - Driveway moved to left side of property.  
OK to move drainlines 30' closer  
to Road to avoid Knoll.

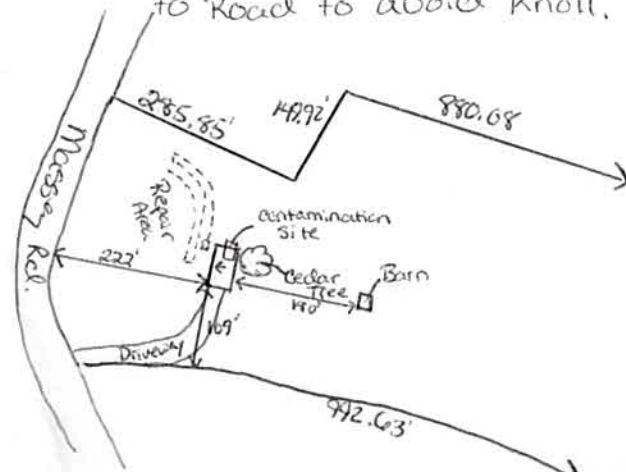

\*Installed as shown  
with 15' stepdown.

\* 9 1/2" fall from Tank to  
Drainlines.

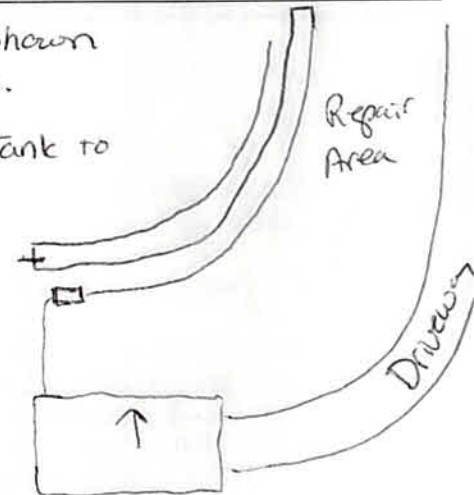

Signed: Margaret McDevine Date: 11/18/02

Signed: Margaret McDevine Date: 3-3-04

APPEALS: By written petition to the Office of Administrative Hearings, 6714 Mail Service Ctr., Raleigh, North Carolina 27699-6714. In accordance with GS.150B-23(a) THIS PERMIT may be suspended or revoked upon a finding that a violation of ...this Chapter, The Rules... or a condition imposed upon the permit has occurred...Also upon a finding that its issuance was based on incorrect or inadequate information...GS.130A-23(a)(c)(d). Septic Tanks require effluent filters, and access devices... GS.130A-335.1.