



**PERMIT TO CONSTRUCT
Onsite Wastewater System**

File Nbr: **2022060013**
County: Kershaw

Name: DELTA LANDS, LLC

Type Facility: HOUSE

Subdivision:

Block: Lot: 6

Address: PO BOX 1432
CAMDEN, SC 29020

Site: 2935 MCRAE RD
CAMDEN, SC 29020

Program Code 360

System Code: 100

TM No.: 274-00-00-010

Water Supply: PUBLIC

PERMIT TO CONSTRUCT SYSTEM SPECIFICATIONS

Daily Flow (gpd): 480

Tank Sizes (gal): Septic Tank: 1000

Pump Chamber:

Grease Trap:

LTAR: .60

Trenches: Length (ft): 267 Width (in): 36 Max. Depth (in): 28 Agg. Depth (in): 14

Min Pump Capacity: gpm at ft. of Head Alternative Product:

SPECIAL INSTRUCTIONS/CONDITIONS

THIS PERMIT IS SITE SPECIFIC. ANY CHANGES TO THE SYSTEM MUST BE APPROVED BY DHEC. ALTERNATIVE TRENCH PRODUCTS APPROVED UNDER STATE RULES AND REGULATIONS MAY BE SUBSTITUTED. ANY UNAPPROVED CHANGES WILL VOID THIS PERMIT.

Installers must contact the local Environmental Affairs office by 10:00 AM the day before installation to schedule a time for the final inspection. If a Department representative does not arrive within 30 minutes of the schedule time, the installer may complete the final inspection. When a contractor self-inspection occurs, the installer must complete the DHEC form 3978, Approval to Operate Contractor Self-Inspection. The installer must submit the DHEC form 3978 to the Department within 2 business days of completion of the installation.

- All applicable setbacks set forth in Regulation 61-56 apply.
- Maximum Trench Depth not to exceed 28 inches. Place lines on contour and use serial distribution if needed.
- Do not install under wet soil conditions. Minimum 9" cover over system after installation.
- This system is designed for specific quantities of domestic wastewater ONLY.
- Do not cut, fill, bulldoze, scrape or change the grade of the natural soils in the septic system area.
- No parking, driving, building or paving over the area of septic system before or after installation.

PERMIT TO CONSTRUCT SYSTEM DIAGRAM

(NTS)

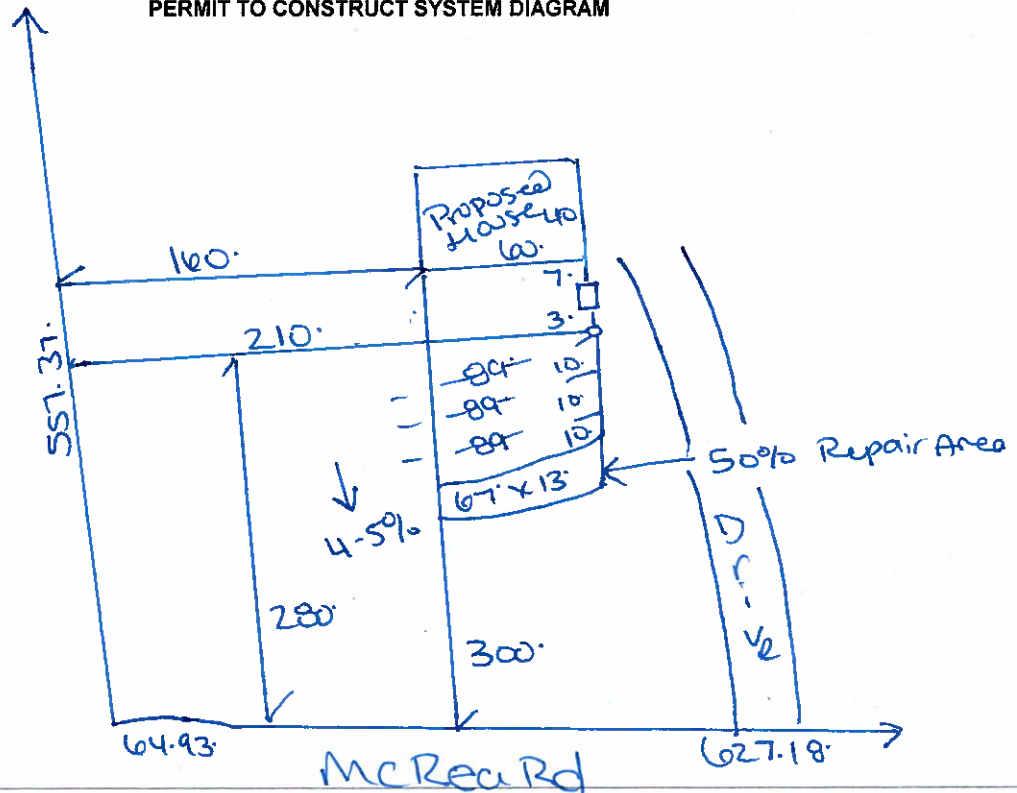

Issued/Revised By:

Cindy Taylor

Date:

9/6/22

DHEC 1781 (01/2014)

This Permit is Appealable Under the Administrative Procedures Act.

This permit will expire and become null and void five (5) years from the issuance date.

There may be an Additional Fee for Changes in this Permit that Require a Site Reevaluation.

Personal information provided on this form is subject to public scrutiny or release.