

**SURVEYOR'S STATEMENT**

THIS MAP WAS PREPARED BY ME OR UNDER MY DIRECTION AND IS BASED UPON A FIELD SURVEY IN CONFORMANCE WITH THE REQUIREMENTS OF THE SUBDIVISION MAP ACT AND LOCAL ORDINANCE AT THE REQUEST OF JOHN J. BELZA IN AUGUST, 2006. I HEREBY STATE THAT THIS TRACT MAP SUBSTANTIALLY CONFORMS TO THE APPROVED OR CONDITIONALLY APPROVED TENTATIVE MAP, IF ANY. I CERTIFY THAT ALL MONUMENTS ARE OF THE CHARACTER AND OCCUPY THE POSITIONS INDICATED AND THAT SAID MONUMENTS ARE SUFFICIENT TO ENABLE THE SURVEY TO BE RETRACED.

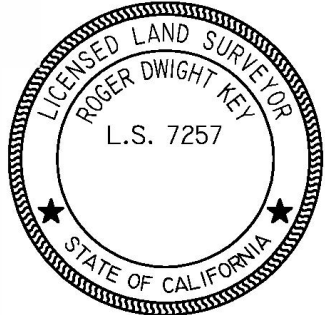

ROGER D. KEY L.S. 7257  
DATE

**COUNTY SURVEYOR'S STATEMENT**

THIS MAP HAS BEEN EXAMINED BY ME AND I AM SATISFIED THAT THE MAP IS TECHNICALLY CORRECT. I HEREBY STATE THAT THE SUBDIVISION AS SHOWN IS SUBSTANTIALLY THE SAME AS IT APPEARED ON THE TENTATIVE MAP AND ANY APPROVED ALTERATIONS THEREOF AND THAT ALL PROVISIONS OF THE SUBDIVISION MAP ACT AND LOCAL ORDINANCES APPLICABLE AT THE TIME OF APPROVAL OF THE TENTATIVE MAP HAVE BEEN COMPLIED WITH.

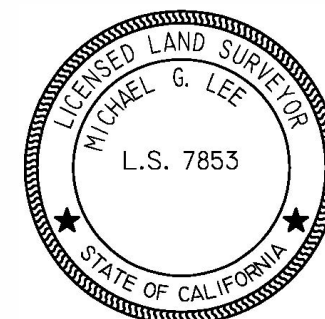

MICHAEL G. LEE L.S. 7853  
COUNTY SURVEYOR, YUBA COUNTY  
DATE

**SUBDIVISION TRACT MAP NO.2005-0044**

FOR JOHN JOSEPH BELZA, LAURA DIANE HARNEY AND JOHN DOMINIQUE BELZA BEING A DIVISION OF LOT "A" OF L.L.A. 2005-0034. SAID PROPERTY BEING A PORTION OF "THE RIDGE", AN UNINCORPORATED AREA OF THE COUNTY OF YUBA, STATE OF CALIFORNIA. TRACT MAP NO. 2000-586, BOOK 77 PAGE 15, WITHIN A PORTION OF SECTION 21 T.16N., R.5E., M.D.B.&M.

PREPARED BY: KEY AND ASSOCIATES (530) 674-1565 JOB # 05-7048  
MAY, 2017 SHEET 1 OF 1

- LEGEND**  
(R1) BOOK 77 PAGE 15, "THE RIDGE" TRACT MAP NO. 2000-586  
(R2) LLA 2005-0034, 2007R-013997, YUBA COUNTY RECORDS  
(R3) WATERLINE EASEMENT PER 2007R-013998.  
■ FOUND MONUMENT AS NOTED  
● SET 5/8" REBAR STAMPED L.S. 7257, OR AS NOTED.  
■ FOUND 5/8" REBAR STAMPED R.C.E. 18842 PER R1  
○ CALCULATED POINT ONLY, NOTHING FOUND OR SET  
( ) EMBRACES RECORD DATA.  
M MEASURED

LINE TABLE(R1,R2)		
LINE	LENGTH	BEARING
L1	30.37'	N00°40'40"W
L2	50.00'	S80°25'41"E
L3	50.00'	S00°19'36"W
L4	55.41'	N77°32'42"W
L5	93.73'	S63°35'28"E
L6	30.56'	N47°00'41"E
L7	146.28'	N68°44'05"E

CURVE TABLE(R1,R2)					
CURVE	LENGTH	RADIUS	DELTA	CHORD	CHORD DIR.
C1	47.29'	3441.69'	0°47'14"	47.29'	N61°13'07"W
C2	72.81'	350.00'	11°55'11"	72.88'	S55°39'08"E
C3	133.41'	1000.00'	7°38'38"	133.31'	N53°30'52"W
C4	70.54'	200.00'	20°12'31"	70.18'	S67°26'27"E
C5	48.71'	200.00'	13°57'14"	48.59'	S70°34'05"E
C6	30.65'	200.00'	8°46'51"	30.62'	S59°12'03"E
C7	127.55'	200.00'	36°32'29"	125.40'	N65°16'56"E
C8	64.66'	250.00'	14°49'05"	64.48'	S76°08'38"W

**BASIS OF BEARINGS (B.O.B.)**  
THE BASIS OF BEARINGS FOR THIS MAP IS THE SOUTH LINE OF LOTS 1 & 2 TAKEN AS S89°24'16"W BETWEEN FOUND MONUMENTS AS SHOWN PER R1.

**TRACT MAP APPROVAL STATEMENT**

THE UNDERSIGNED OFFICER ON BEHALF OF THE COUNTY OF YUBA PURSUANT TO AUTHORITY CONFERRED BY SECTION 11.41.050, CHAPTER 11.15 OF TITLE XI OF THE YUBA COUNTY DEVELOPMENT CODE, HEREBY FINDS THE FINAL MAP FOR TRACT MAP NO. 2005-0044, TO BE IN ACCORDANCE WITH THE CONDITIONALLY APPROVED TENTATIVE MAP AND THEREFORE HEREBY APPROVES THE WITHIN FINAL MAP.

MICHAEL G. LEE L.S. 7853  
COUNTY DIRECTOR, YUBA COUNTY

**NOTE:**

OWNERS STATEMENT; A STATEMENT OF TAX STATUS; AND ADDITIONAL INFORMATION DOCUMENT FOR PM 2005-0044 FOR JOHN J. BELZA, LAURA DIANE HARNEY, AND JOHN D. BELZA, CONTAINING INFORMATION NOT INTENDED TO EFFECT RECORD TITLE INTEREST BUT WHICH REFLECTS CERTAIN CONDITIONS OF APPROVAL FOR THIS MAP ARE BEING CONCURRENTLY RECORDED AT DOCUMENT NUMBER OFFICIAL RECORDS OF YUBA COUNTY.

**RECORDER'S CERTIFICATE**

FILED THIS \_\_\_ DAY OF \_\_\_\_\_ 2017, AT \_\_\_\_\_ M, IN BOOK \_\_\_\_\_ OF MAPS AT PAGE \_\_\_\_\_ AT THE REQUEST OF JOHN J. BELZA.

FEE PAID \_\_\_\_\_ TERRY A. HANSEN  
YUBA COUNTY RECORDER  
DOCUMENT No. \_\_\_\_\_ BY \_\_\_\_\_  
DEPUTY