

You are driving on Highway 375. Go past the A'lien Inn in Rachel, NV. Continue on Highway 375 approximately 5 miles. You will go past Penoyer Farm Road. Watch for Gunderson Road. There is an old Lincoln Estates Sign on the left. Turn left on Gunderson Road.

Watch for a Lincoln Estates Sign on the Left. Turn left off Highway 375 on Gunderson Road.

Follow Gunderson Road. You will see an old RV trailer and a pump house on your left.

Turn left and follow the power line to Winchester Road. Turn right on Winchester Road. The power line runs down Winchester Road.

You will come to a farm road to the pivot sprinklers to the east. The 2+ Acre Parcels start here.

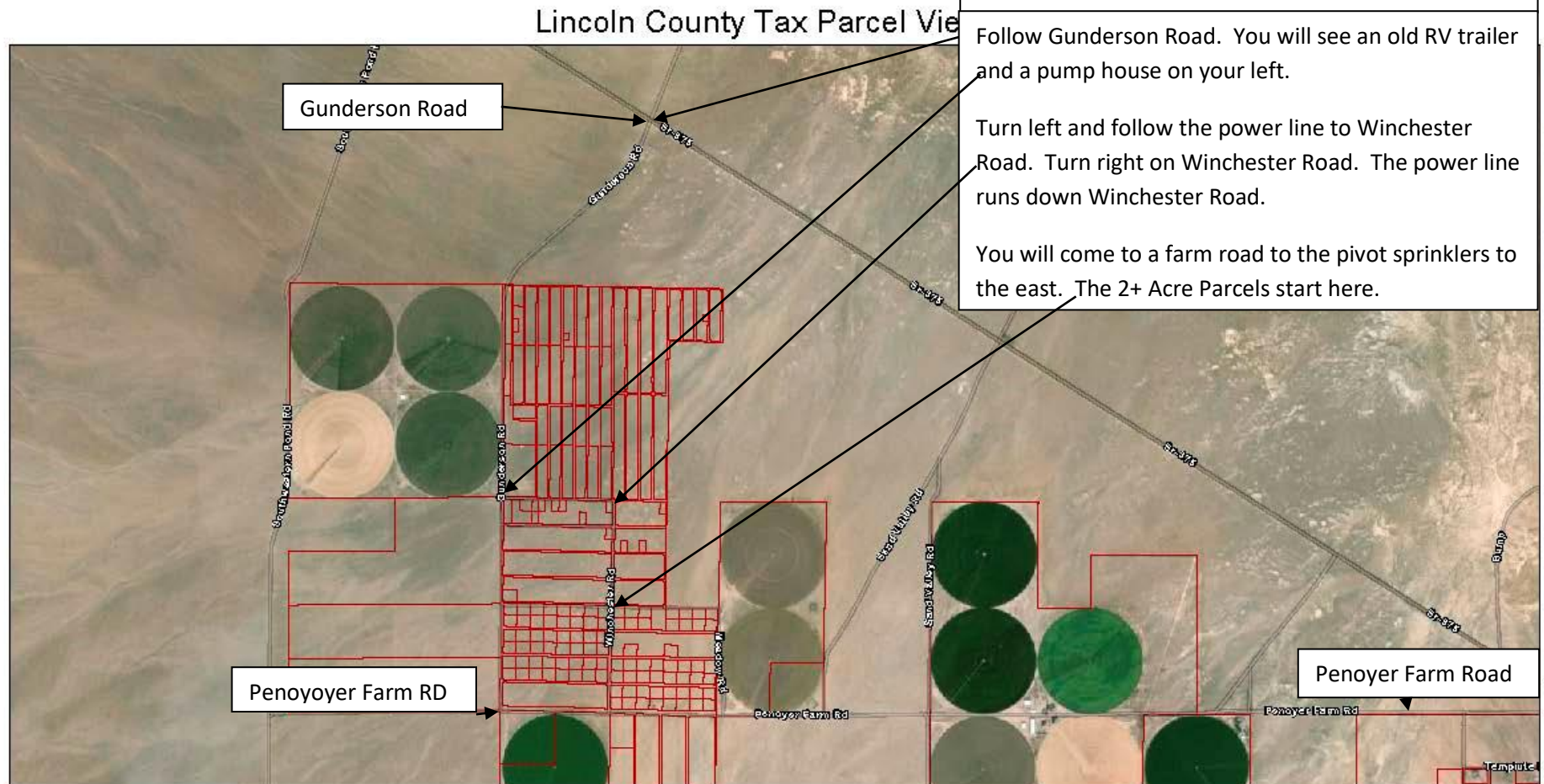

8/6/2020, 2:53:52 PM

- Lincoln County Assessor - Tax Parcels
- Nevada State Boundary
- County Boundary

**ALL BOUNDARIES ARE APPROXIMATE.**

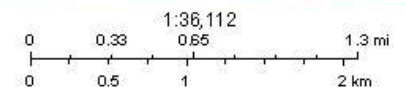

Source: Esri, Maxar, GeoEye, Earthstar Geographics, CNES/Airbus DS, USDA, USGS, AeroGRID, IGN, and the GIS User Community, Sunrise Cloud SMART GIS™, Sources: Esri, HERE, Garmin, FAO, NOAA, USGS, © OpenStreetMap contributors, and the GIS User

**This information has been secured from sources we believe to be reliable, but we make no representations or warranties, expressed or implied, as to the accuracy of the information. Buyer must verify the information and bears all risk for any inaccuracies.**

**Jan Cole, land-water.com, 702-270-9194**