

Missouri
Shelby

U.S. Department of Agriculture
Farm Service Agency

FARM: 2703

Prepared: 12/15/22 11:04 AM

Crop Year: 2023

Report ID: FSA-156EZ

Abbreviated 156 Farm Record

Page: 1 of 1

DISCLAIMER: This is data extracted from the web farm database. Because of potential messaging failures in MIDAS, this data is not guaranteed to be an accurate and complete representation of data contained in the MIDAS system, which is the system of record for Farm Records.

Operator Name Farm Identifier
DIV OF 288

Farms Associated with Operator:

ARC/PLC G/WF Eligibility: Eligible

CRP Contract Number(s): None

Farmland	Cropland	DCP Cropland	WBP	WRP	EWP	CRP Cropland	GRP	Farm Status	Number of Tracts
100.56	29.7	29.7	0.0	0.0	0.0	0.0	0.0	Active	1
State Conservation	Other Conservation	Effective DCP Cropland	Double Cropped	MPL/FWP					
0.0	0.0	29.7	0.0	0.0					

Tract Number: 7430 Description S12 T57N R10W

FSA Physical Location : Shelby, MO

ANSI Physical Location: Shelby, MO

BIA Range Unit Number:

HEL Status: HEL: conservation system is being actively applied

Wetland Status: Wetland determinations not complete

WL Violations: None

Farmland	Cropland	DCP Cropland	WBP	WRP	EWP	CRP Cropland	GRP
100.56	29.7	29.7	0.0	0.0	0.0	0.0	0.0
State Conservation	Other Conservation	Effective DCP Cropland	Double Cropped	MPL/FWP			
0.0	0.0	29.7	0.0	0.0			

Owners: JAVAUX, DENNY J.

Other Producers: None

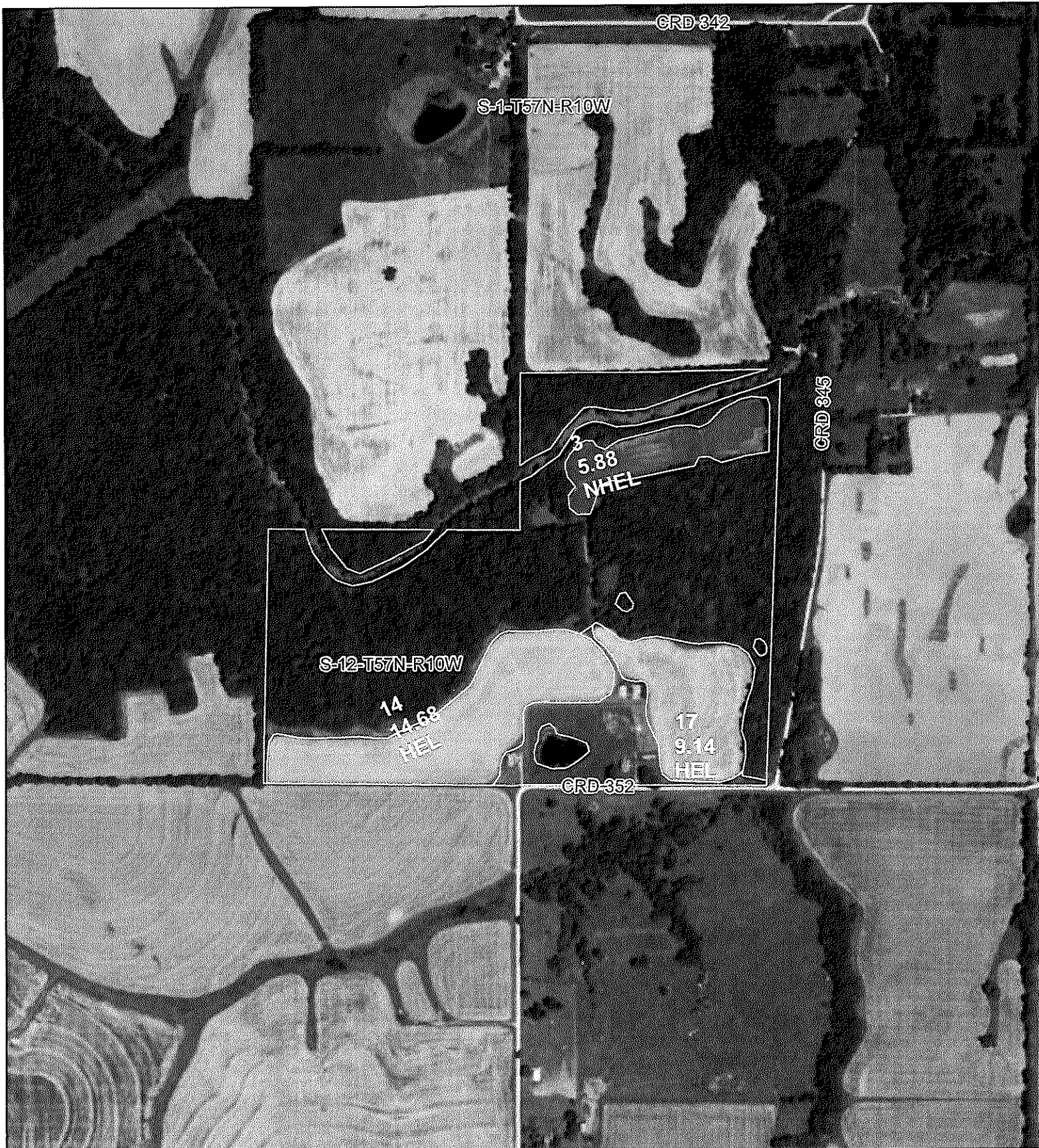

All Measurements are
For FSA Programs Only

Wetland Determination Identifiers

- Restricted Use
- ▽ Limited Restrictions
- Exempt from Conservation Compliance Provisions

Disclaimer: Wetland identifiers do not represent the size, shape or specific determination of the area. Refer to your original determination (CPA-026 and attached maps) for exact wetland boundaries and determinations, or contact NRCS.

Shelby Co. FSA

C=Corn-Yel-Gr-NI SB=Soybeans-COM-Gr-NI
 Milo=Grain Sorghum - GRS - Gr - NI
 WHT = Wheat - SRW - Gr - NI
 DCSB=Double Crop Soybeans-Com-Gr-NI
 RYE=COVRC-CEG-CO-NI Gr L/S=Grass-FTA-LS
 Past/GZ=MIXFG-IGS-GZ Hay/FG=MixFg-IGS-FG
 Timber Past=GRASS-FTA-GZ-IV
 *Unless notated on Map

1:7,920

Program Year: 2023

Created: 10/14/2022

Flown: 2022-6-20

- clu
- crp
- plss

Farm 2703
Tract 7430