

Rec 11-6-97
ZVM

SW258

WV STATE DEPARTMENT OF HEALTH
Office of Environmental Health Services
ENVIRONMENTAL ENGINEERING DIVISION

WELL COMPLETION REPORT

Date(s) Oct. 24, 1997 County Hampshire Permit #: DW-14-09-98-086
Town: Paw Paw Area Name/Location Rt. 9 & 29 intersection between Pin Oak and Paw Paw
Well Owner: Wayne Bradfield Address: Rt. 1 Box 78
Telephone Number: 304-947-7984 Paw Paw, WV 25434
Well Driller: Randal C. Miller Address: P. O. Box 952
Telephone Number: 304-822-4092 Romney, WV 26757

WELL LOG

DEPTH IN FEET	FORMATIONS: KIND, THICKNESS, AND IF WATER BEARING	REMARKS:
225'	Tested Water Yield (1 GPM)	Drilled Deeper (deepened by 100') Type of Well: <u>DW</u> Drilling Method: <u>Air Rotary Hammer</u> Well Diameter: <u>5"</u> Casing O.D.: <u>6"</u> Well Depth: <u>325'</u> Date Completed: <u>10-24-97</u> CASING: Length <u>?</u> Feet Height above ground <u> </u> Feet <input type="checkbox"/> Steel <input type="checkbox"/> Plastic <input type="checkbox"/> Cast Iron Other <u> </u> Type <u> </u>
	Began Drilling	
225 - 240'	Limestone (Water 3 GPM)	
240 - 300'	Red Sandstone (Water 8 GPM)	
300 - 325'	Red Sandstone (consolidated)	
	Stopped Drilling Operation	
		SCREEN <input checked="" type="checkbox"/> None Installed Type <u> </u> Diameter <u> </u> Slot/Gauge <u> </u> Length <u> </u> Set Between <u> </u> Ft. and <u> </u> Ft.

PUMPING OR BAILING TEST

DETAILS	#1	#2	#3
Static Water Level (Ft. Below Grade)	100		
Pumping Rate (GPM)	12		
Pumping Level (Ft Below Grade)	310		
Duration of Test (In Hours)	2		
Recovery Time to Static Level (In Hours)	3		

WELL HEAD

Pitless Adapter: Type, Make, Etc.
Well Cap: Type, Make, Etc.
Well Seal: Type, Make, Etc.
Well Platform:
Length Width Thickness
Grouting: ☐ Yes ☐ No
All Public Water Supplies must be grouted.

I hereby certify that this well was drilled and constructed under my supervision, in compliance with all requirements of the referenced permit, and that this record is true to the best of my knowledge and belief.

Randal C. Miller	432
Name <u>A & S Well Drilling and Pump Co.</u>	Certification No. <u> </u>
Registered Business Name <u>Randal C. Miller</u>	<u>10-24-97</u>
Signed <u>Randal C. Miller</u>	Date <u> </u>

WEST VIRGINIA
SEPTIC TANK INSPECTION FORMHAMPSHIRE COUNTY

Health Department

Installation Permit No. 2-185

Name of Owner

WAYNE E. BRADFELD

Address

RFD 1, PAW PAW, W. VA.

Property Address

WOODROW - BACK OF BLOOM'S STORE.

DESCRIPTION & NUMBER OF UNITS SERVED

Type Facility Served

NEW HOME

No. Water Closets

1Lot Size 1 ACRE sq. ft.Area suitable for sewage disposal installation 4000 sq. ft.

Source of Water Supply

DRIILLED WELL

No. Lavatories

1

No. Bedrooms

3

No. Showers or Tubs

2

No. Baths

1 1/2

No. Garbage Grinders

0

No. Automatic Washers

0

SEPTIC TANK

Material

CONCRETE

Length

Width

Depth

=

cubic feet

Liquid Depth

ft.

Liquid Capacity

1,000

gal.

Distance to: Dwelling

15

Water Supply

70'

Nearest Property Line

10

SOIL ABSORPTION SYSTEM

Type Drain Line Material

PLASTIC

Trench Width

36

Inches

Trench Depth

30

Inches

Total Absorption area in Trench Bottom

600

sq. ft.

Diameter of Drain Line

4

Inches

Type Filter Media

6

No. of Drain Lines

2

Depth Filter Media Under Drain Line

2

In.

Length of Each Line

90, 90,

ft.

Depth Filter Media Over Drain Line

in.

Distance of Disposal Field to:

(a) Dwelling

30'

(b) Water Supply

85'

(c) Nearest Property Line

20

An inspection of the septic tank system described herein disclosed that said system (MEETS, DOES NOT MEET) the minimum standards established by the West Virginia State Department of Health.

MARCH 29, 1972
DateC. E. Bright
Sanitarian

SKETCH OF SYSTEM TO BE DRAWN ON BACK

NOTE: Copy of this inspection report must be given to owner and the original filed in the Health Department files. PERMANENT RECORD - DO NOT DESTROY.

BLOOM'S
STORE

PLOT LAYOUT - SKETCH

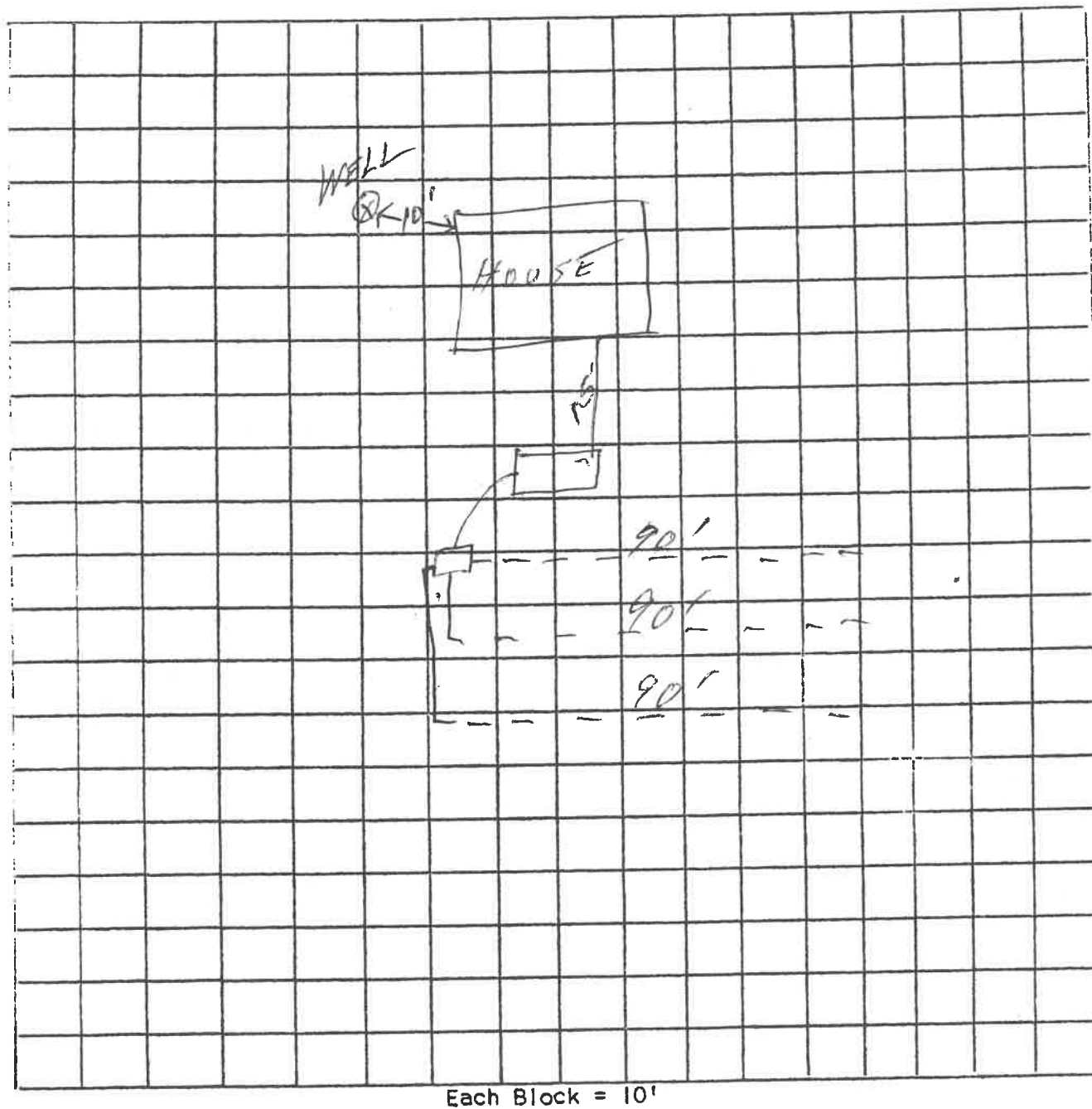

* Symbols:

□ House

⊗ Water Supply

⊙ Swamp Area

||||| Trees

▭ Septic Tank

- - - - Soil Absorption Field

→ Slope Ground

* Within 200 feet radius of soil absorption field.