



Columbia Assessment and Taxation Web Query

[← Back](#)
[Forward →](#)
[Search Page](#)
[Logoff](#)

[Help](#)
[Detail Help](#)

Account #	5311	Tax Status	ASSESSABLE
Map #	3N1W170000200	Account Status	ACTIVE
Code - Tax #	0108-5311	Subtype	NORMAL
Owner	LOOS CH REV TR CRT SHELTER BY PASS FUND		
Agent			
Mailing Address	35800 RIVERSIDE LN SCAPPOOSE, OR 97056		

Reports

[Summary Report](#)

[Ledger Report](#)

[Tax Summary](#)

[Tax Statement](#)

[Names](#)

Improvements

Link	Site	Bldg #	Stat Class	Code Area	Year Built	Eff Year Built	Description	Size
I	1	1	134	0108	1903	1895	Two story with basement	3600
I	2	2	131	0108	1949	1949	One story	1112
I	3	3	131	0108	1940	1940	One story	850
I	1	4	355	0108		1940	LOFT BARN	2400
I	1	5	325	0108		1974	GP BUILDING	1512
I	1	7	320	0108	1987	1974	FREE STALL BARN	24888
I	1	8	335	0108		1999	HAY COVER	12665
I	1	9	335	0108	1987	1974	HAY COVER	2100
I	1	11	320	0108	1982	1974	FREE STALL BARN	34335
I	1	12	320	0108	1982	1974	FREE STALL BARN	14580
I	1	13	370	0108		1980	MILKING PARLOR	1456
I	1	14	310	0108		1974	BUNKER SILO	4800
I	1	15	310	0108		1944	BUNKER SILO	6000
I	1	16	380	0108		1970	SILOS	6
I	1	17	380	0108		1970	SILOS	6

STATE OF OREGON
COUNTY OF COLUMBIA
CERTIFICATE OF WATER RIGHT

THIS CERTIFICATE ISSUED TO

CASE LOOS
35800 RIVERSIDE LANE
SCAPPOOSE, OREGON 97056

confirms the right to use ANIMAL WASTEWATER STORED IN THE RESERVOIR CONSTRUCTED UNDER PERMIT R-8505, a tributary of JACKSON CREEK, for the purpose of PRIMARY IRRIGATION OF 67.1 ACRES AND SUPPLEMENTAL IRRIGATION OF 117.6 ACRES.

The right has been perfected under Permit 47049. The date of priority is AUGUST 24, 1982. The right is limited to not more than 3.9 ACRE FEET OF STORED WATER, or its equivalent in case of rotation, measured at the point of diversion from the source.

The point of diversion is located as follows:

NE 1/4 SW 1/4, SECTION 8, T 3 N, R 1 W, W.M.; 1500 FEET NORTH AND 2200 FEET EAST FROM THE SW CORNER OF SECTION 8.

The amount of water used for irrigation, together with the amount secured under any other right existing for the same lands, is limited to a diversion of not to exceed 2.5 acre-feet per acre for each acre irrigated during the irrigation season of each year from storage. The right is limited to any deficiency in the available supply of any prior right for the same land and shall not exceed the limitation allowed herein.

The right shall conform to such reasonable rotation system as may be ordered by the proper state officer.

A description of the place of use under the right, and to which such right is appurtenant, is as follows:

	<u>PRIMARY</u>	<u>SUPPLEMENTAL</u>
SE 1/4 SE 1/4 SECTION 7	0.8 ACRE	
LOT 3 (SW 1/4 NW 1/4)	10.6 ACRES	
SE 1/4 NW 1/4	1.7 ACRES	
NE 1/4 SW 1/4	17.1 ACRES	
LOT 4 (NW 1/4 SW 1/4)	0.7 ACRE	
LOT 5 (SW 1/4 SW 1/4)	19.5 ACRES	4.6 ACRES
SE 1/4 SW 1/4	16.7 ACRES	21.2 ACRES
SW 1/4 SE 1/4		25.2 ACRES
SE 1/4 SE 1/4		2.2 ACRES
SECTION 8		
TOWNSHIP 3 NORTH, RANGE 1 WEST, W.M.		

SEE NEXT PAGE

LOT 1 (NE 1/4 NE 1/4)	11.0 ACRES
LOT 2 (NW 1/4 NE 1/4)	23.8 ACRES
LOT 3 (NE 1/4 NW 1/4)	27.0 ACRES
NW 1/4 NW 1/4	2.6 ACRES

SECTION 17

TOWNSHIP 3 NORTH, RANGE 1 WEST, W.M.

The right to the use of the water for the above purpose is restricted to beneficial use on the lands or place of use described. The right is subject to minimum flows established by the Water Resources Commission with an effective date prior to this right.

WITNESS the signature of the Water Resources Director, affixed this date JUNE 25, 1990.

/s/ WILLIAM H. YOUNG

Water Resources Director

Recorded in State Record of Water Right Certificates numbered 64420.

63942.ZFS

STATE OF OREGON
COUNTY OF COLUMBIA
CERTIFICATE OF WATER RIGHT

THIS CERTIFICATE ISSUED TO

CASE LOOS
35800 RIVERSIDE LANE
SCAPPOOSE, OREGON 97056

confirms the right to store the waters of ANIMAL WASTEWATER, a tributary of JACKSON CREEK appropriated under Permit 47049, for the purpose of IRRIGATION AND SUPPLEMENTAL IRRIGATION.

The right to store these waters has been perfected under Reservoir Permit R-8505. The date of priority is AUGUST 24, 1982. The amount of water entitled to be stored each year under such right is not more than 3.9 ACRE-FEET.

The reservoir is located as follows:

NE 1/4 SW 1/4
SECTION 8
TOWNSHIP 3 NORTH, RANGE 1 WEST, W.M.

The right to store and use the water for the above purpose is restricted to beneficial use at the place of use described.

WITNESS the signature of the Water Resources Director, affixed this date JUNE 25, 1990.

/s/ WILLIAM P. YOUNG

Water Resources Director

Recorded in State Record of Water Right Certificates numbered 64419.

R-63941.ZFS

T.3 N., R.1 W., W.M.

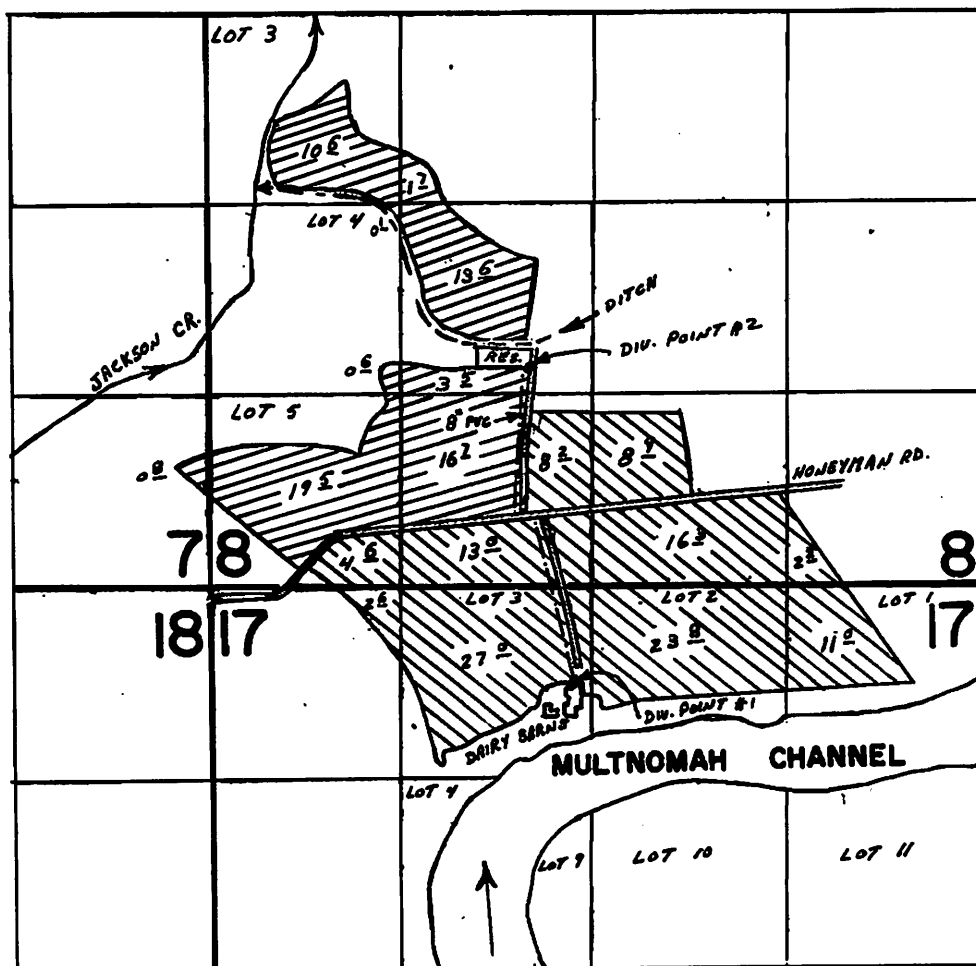

DIV. POINT #1 : 65° S. & 2500' E FROM NW CORNER SECTION 17
 DIV. POINT #2 : 150° N. & 2200' E FROM NW CORNER SECTION 17



PRIMARY



SUPPLEMENTAL

FINAL PROOF SURVEY UNDER

R-63941

R-8505

Application No. **63942** Permit No. **47049**
 IN NAME OF

CASE **LOOS**

Surveyed **AUG. 25, 1988**, by **Z. SALEH**

N

SCALE 1" = 1320'

AAA-000.
 AAA-001
 12-22-88 Z.F.S.

STATE OF OREGON
COUNTY OF COLUMBIA
CERTIFICATE OF WATER RIGHT

This Is to Certify, That **WALLACE JOHNSON** **97741**
of Route 2, Box 1269 Madras, State of Oregon, has made proof
to the satisfaction of the STATE ENGINEER of Oregon, of a right to the use of the waters of
Multnomah Channel

a tributary of Columbia River for the purpose of
irrigation of 117.6 acres

under Permit No. 36516 of the State Engineer, and that said right to the use of said waters
has been perfected in accordance with the laws of Oregon; that the priority of the right hereby
confirmed dates from May 15, 1972

that the amount of water to which such right is entitled and hereby confirmed, for the purposes
aforesaid, is limited to an amount actually beneficially used for said purposes, and shall not exceed
1.47 cubic feet per second

or its equivalent in case of rotation, measured at the point of diversion from the stream.
The point of diversion is located in the Lot 2 (NW $\frac{1}{4}$ NE $\frac{1}{4}$), Section 17, T. 3 N., R. 1 W.,
W.M., 3600 feet South and 3160 feet East from W $\frac{1}{2}$ Corner, Section 8.

The amount of water used for irrigation, together with the amount secured under any other
right existing for the same lands, shall be limited to one-eightieth of one cubic foot per second
per acre, or its equivalent for each acre irrigated and shall be further limited to
a diversion of not to exceed 2 $\frac{1}{2}$ acre feet per acre for each acre irrigated during
the irrigation season of each year;

and shall
conform to such reasonable rotation system as may be ordered by the proper state officer.

A description of the place of use under the right hereby confirmed, and to which such right is
appurtenant, is as follows:

4.6 acres Lot 5 (SW $\frac{1}{4}$ SW $\frac{1}{4}$)
21.2 acres SE $\frac{1}{4}$ SW $\frac{1}{4}$
25.2 acres SW $\frac{1}{4}$ SE $\frac{1}{4}$
2.2 acres SE $\frac{1}{4}$ SE $\frac{1}{4}$
Section 8

11.0 acres Lot 1 (NE $\frac{1}{4}$ NE $\frac{1}{4}$)
23.8 acres Lot 2 (NW $\frac{1}{4}$ NE $\frac{1}{4}$)
27.0 acres Lot 3 (NE $\frac{1}{4}$ NW $\frac{1}{4}$)
2.6 acres NW $\frac{1}{4}$ NW $\frac{1}{4}$
Section 17
T. 3 N., R. 1 W., W. M.

The right to the use of the water for the purposes aforesaid is restricted to the lands or place of
use herein described.

WITNESS the signature of the State Engineer, affixed
this date, December 5, 1975

James E. Sexson
Water Resources Director ~~State Engineer~~

1974-L