

Soils Map

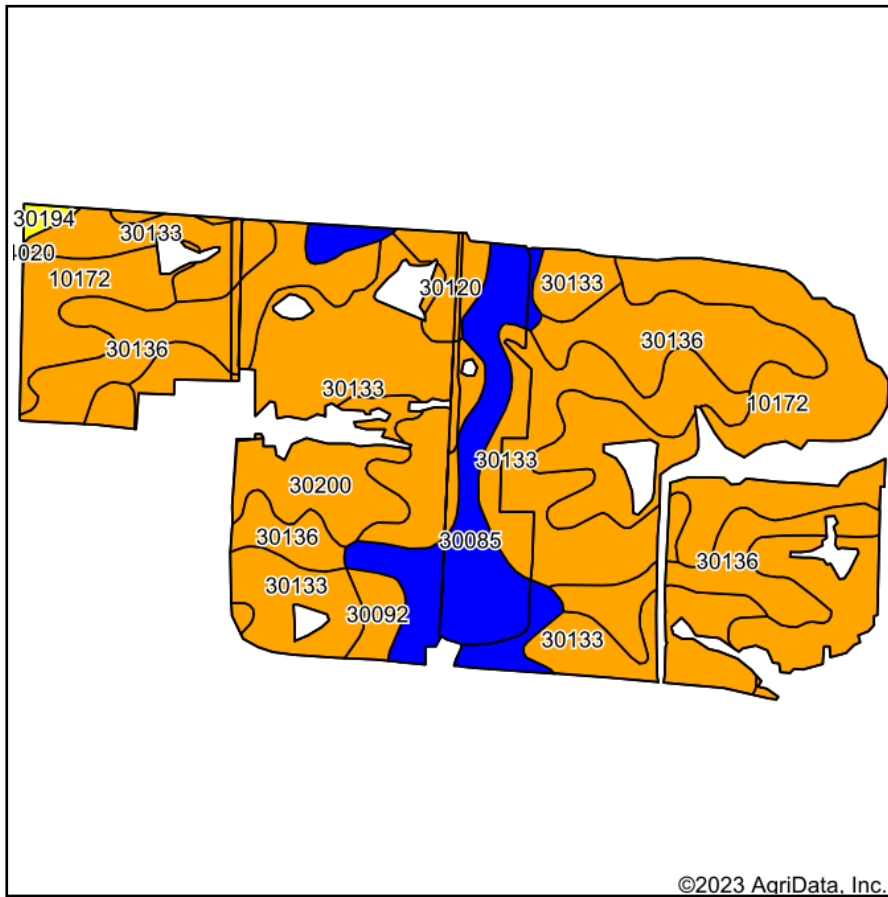

Soils data provided by USDA and NRCS.

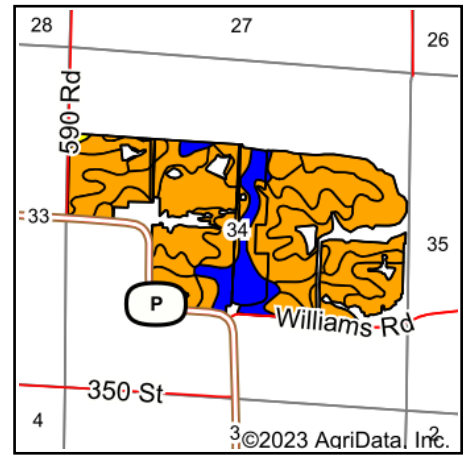

State: **Missouri**
County: **Gentry**
Location: **34-63N-30W**
Township: **Athens**
Acres: **242.53**
Date: **5/2/2023**



Maps Provided By:



Area Symbol: MO075, Soil Area Version: 25

Code	Soil Description	Acres	Percent of field	Non-Irr Class Legend	Non-Irr Class *c	Alfalfa hay Tons	Caucasian bluestem Tons	Common bermudagrass Tons	Orchardgrass red clover Tons	Tall fescue Tons	Warm season grasses Tons	*n NCCPI Overall	*n NCCPI Corn	*n NCCPI Soybeans
30133	Lamoni clay loam, 5 to 9 percent slopes, eroded	88.97	36.7%		IIle							58	58	46
10172	Shelby clay loam, 9 to 14 percent slopes, moderately eroded	57.30	23.6%		IIle							68	68	52
30136	Lamoni loam, 5 to 9 percent slopes	48.69	20.1%		IIle	5	8	7	8	7	8	62	56	58
30085	Grundy silt loam, 2 to 5 percent slopes	26.26	10.8%		Ile							74	74	63
30200	Shelby loam, 9 to 14 percent slopes	12.37	5.1%		IIle							72	72	61
30120	Lagonda silty clay loam, 5 to 9 percent slopes, eroded	4.83	2.0%		IIle	5	8	7	8	7	8	69	67	58
30092	Grundy silty clay loam, 5 to 9 percent slopes, moderately eroded	3.11	1.3%		IIle							71	71	64

30194	Shelby clay loam, 14 to 18 percent slopes, moderately eroded	1.00	0.4%		Ive							64	64	48
Weighted Average					2.90	1.1	1.8	1.5	1.8	1.5	1.8	*n 64	*n 62.8	*n 52.9

*n: The aggregation method is "Weighted Average using all components"

*c: Using Capabilities Class Dominant Condition Aggregation Method

Soils data provided by USDA and NRCS.