

Soils Map

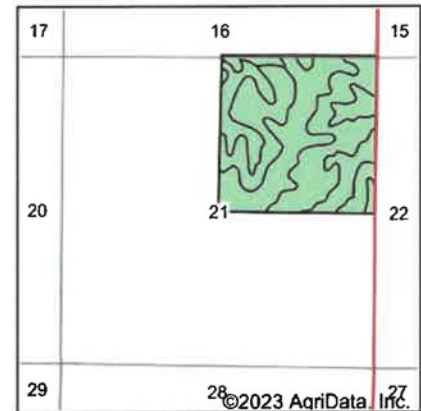

State: **Missouri**
 County: **Harrison**
 Location: **21-66N-29W**
 Township: **Lincoln**
 Acres: **160.91**
 Date: **8/14/2023**

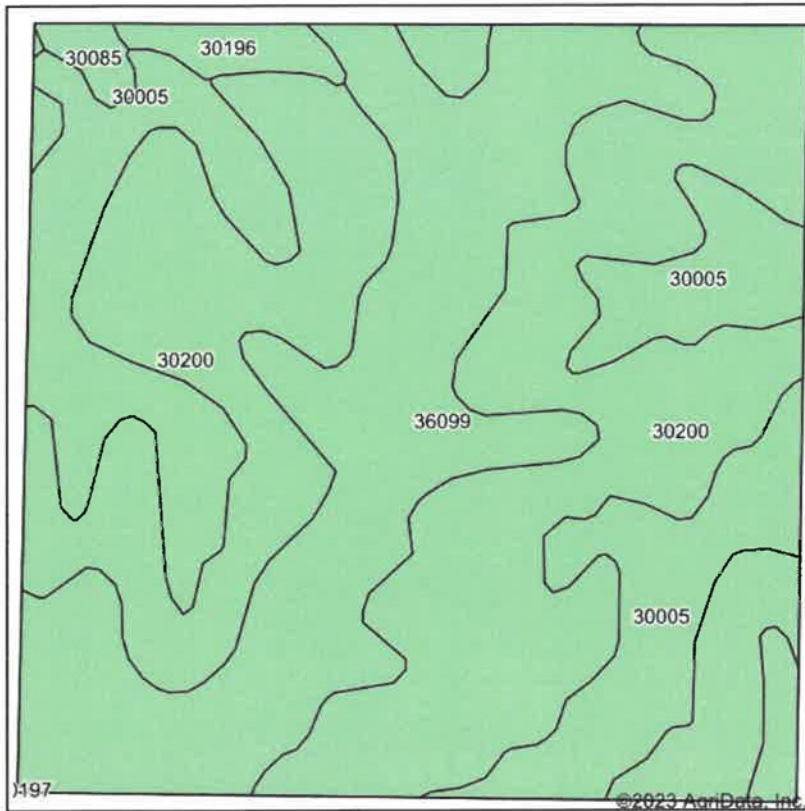

Maps Provided By:



Area Symbol: MO081, Soil Area Version: 26

Code	Soil Description	Acres	Percent of field	Non-Irr Class *c	Alfalfa hay Tons	Caucasian bluestem Tons	Common bermudagrass Tons	Orchardgrass red clover Tons	Tall fescue Tons	Warm season grasses Tons
30200	Shelby loam, 9 to 14 percent slopes	76.66	47.6%	Ille						
36099	Zook-Colo silty clay loams, 1 to 3 percent slopes, frequently flooded	43.94	27.3%	Illw			8	7	8	9
30005	Adair loam, 3 to 9 percent slopes	35.20	21.9%	Ille	4	7	6	7	6	7
30196	Shelby clay loam, 9 to 14 percent slopes, severely eroded	3.79	2.4%	IVe						
30085	Grundy silt loam, 2 to 5 percent slopes	1.32	0.8%	Ile						
Weighted Average				3.02	0.9	1.5	3.5	3.4	3.5	4

*c: Using Capabilities Class Dominant Condition Aggregation Method