

LAND FOR SALE

80 +/- ACRES | KINGMAN COUNTY, KANSAS

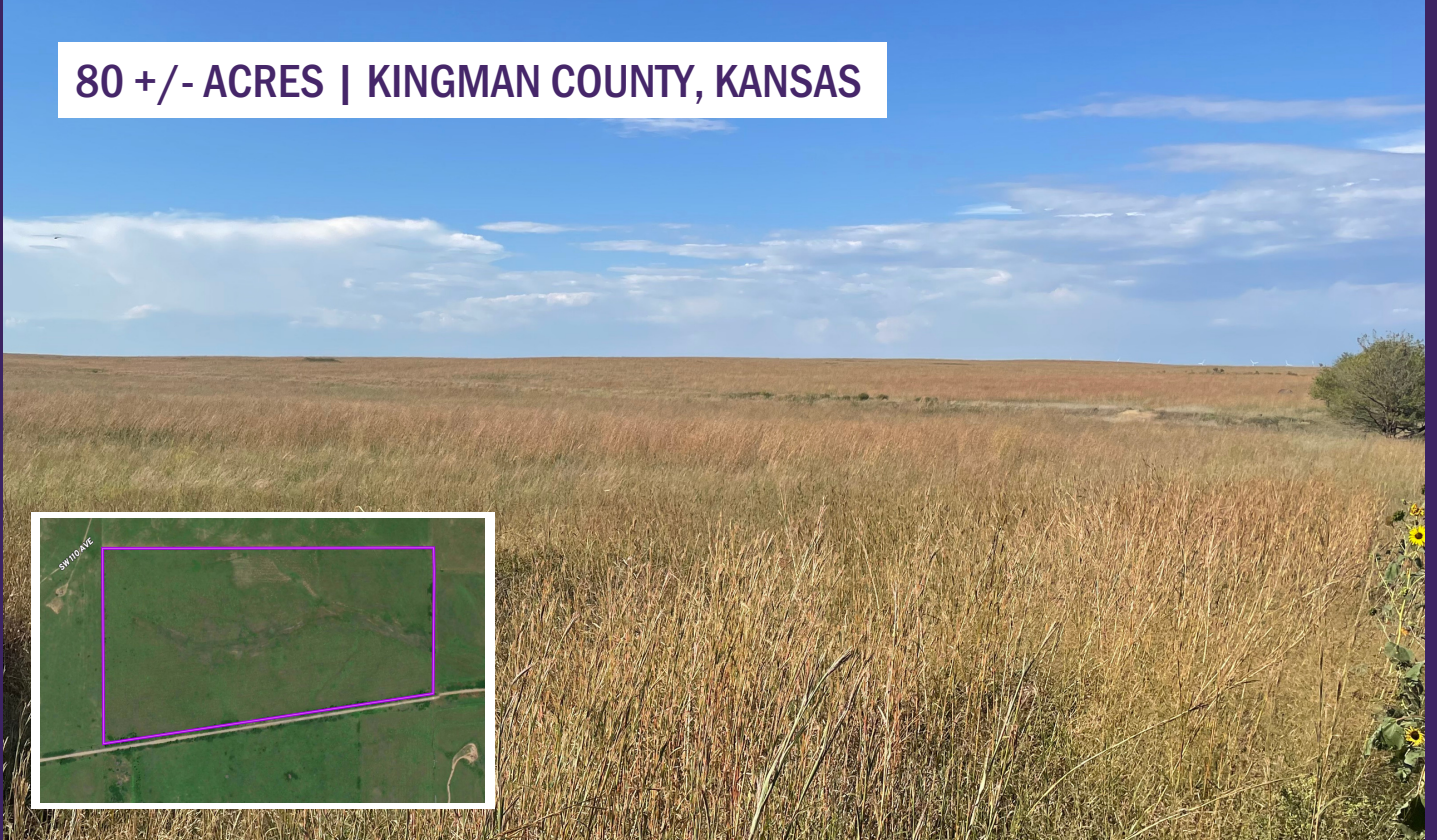

Legal Description: N ½ SE ¼ of 9-30-9W in Kingman County, KS

Location: Located 1 mile west of Zenda, KS

Description: This 80-acre property offers a prime opportunity for those seeking quality CRP grassland in the heart of Kansas. Situated just 1 mile west of Zenda, this land boasts an advantageous location. The property is well-fenced on the north and west sides, ensuring security and ease of management. The presence of CRP grass signifies a commitment to conservation and can provide a source of income. There are 8 CRP payments left per the contract which the buyer will receive at \$52 per acre.

Minerals: Previous owners reserved their mineral interest for their lives and the reservation shall pass to the Buyer.

Taxes: \$500 - 2022 (Estimated taxes will be prorated to the date of closing).

Possession: Buyer will receive possession upon closing.

Listed at \$144,000

Ralph Lilja - REALTOR®

12140 W. K-42 Hwy · Wichita, KS 67227

(620) 243-3244 · ralph@genefrancis.com

**GENE
FRANCIS
& ASSOCIATES**

REAL ESTATE BROKERS & AUCTIONEERS