

Soils Map

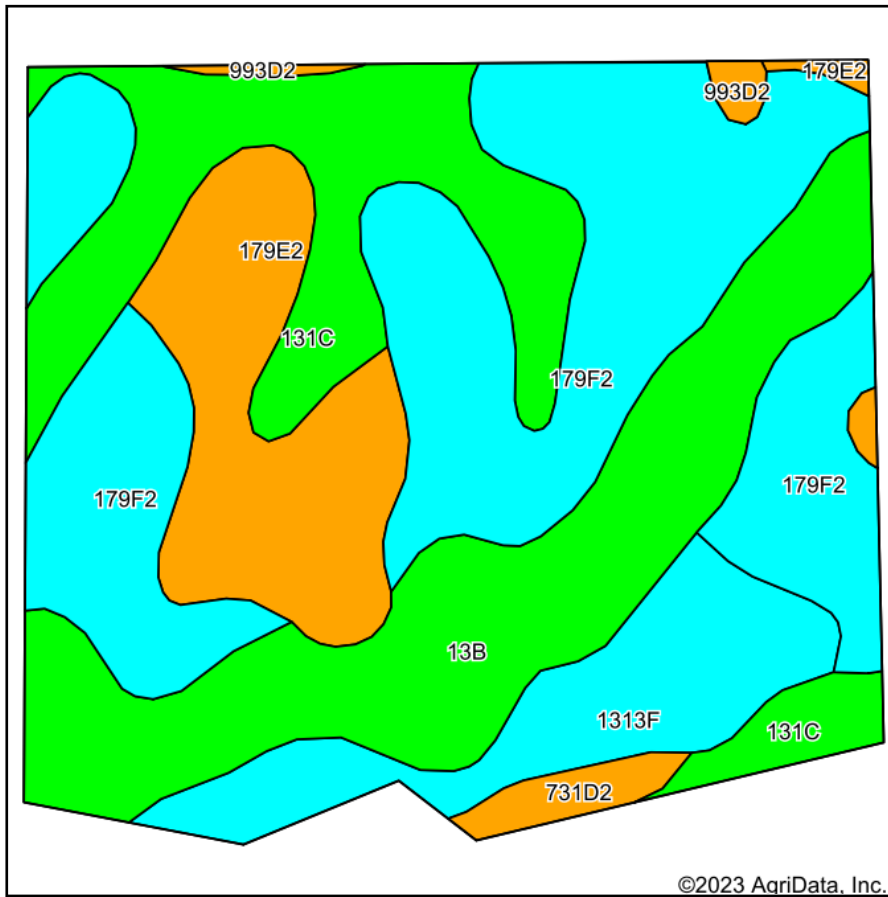

Soils data provided by USDA and NRCS.

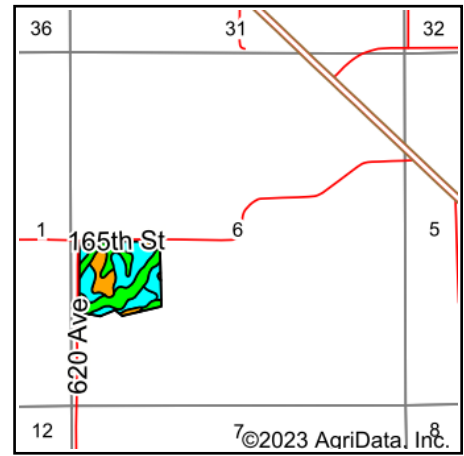

State: **Iowa**
 County: **Monroe**
 Location: **6-72N-17W**
 Township: **Troy**
 Acres: **32.76**
 Date: **10/25/2023**

Hawkeye Farm Mgmt & Real Estate



22 N Main, Albion IA Phone: 641-932-7796
 Email: hawkeye@uciowa.com
 On the web: www.uciowa.com
 www.iowawhitetailfarms.com

Maps Provided By:



© AgriData, Inc. 2023

www.AgriDataInc.com



Area Symbol: IA135, Soil Area Version: 31

Code	Soil Description	Acres	Percent of field	CSR2 Legend	Non-Irr Class *c	CSR2**	CSR	*n NCCPI Corn	*n NCCPI Soybeans
179F2	Gara loam, 18 to 24 percent slopes, moderately eroded	11.98	36.6%		Vle	12	13	54	36
13B	Olmitz-Colo-Vesser complex, 2 to 5 percent slopes	6.98	21.3%		Ilw	82	60	70	71
131C	Pershing silt loam, 5 to 9 percent slopes	5.53	16.9%		Ille	65	49	72	58
179E2	Gara loam, 14 to 18 percent slopes, moderately eroded	4.19	12.8%		Vle	35	33	68	51
1313F	Munterville silt loam, 18 to 25 percent slopes	3.27	10.0%		Vlle	11	5	49	33
731D2	Pershing silty clay loam, 9 to 14 percent slopes, moderately eroded	0.49	1.5%		IVe	38	31	63	53
993D2	Gara-Armstrong loams, 9 to 14 percent slopes, moderately eroded	0.32	1.0%		IVe	35	20	66	48
Weighted Average					4.69	39.3	31.2	*n 62	*n 49.2

**IA has updated the CSR values for each county to CSR2.

*n: The aggregation method is "Weighted Average using all components"

*c: Using Capabilities Class Dominant Condition Aggregation Method

Soils data provided by USDA and NRCS.