

Soils Map

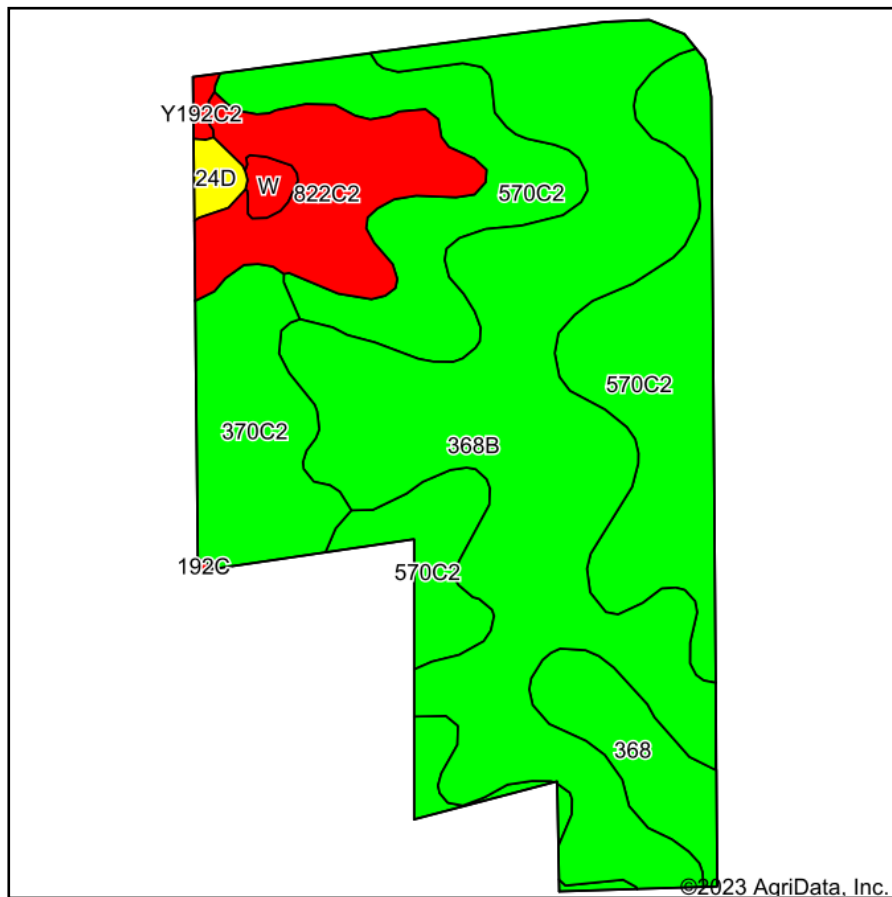

Soils data provided by USDA and NRCS.

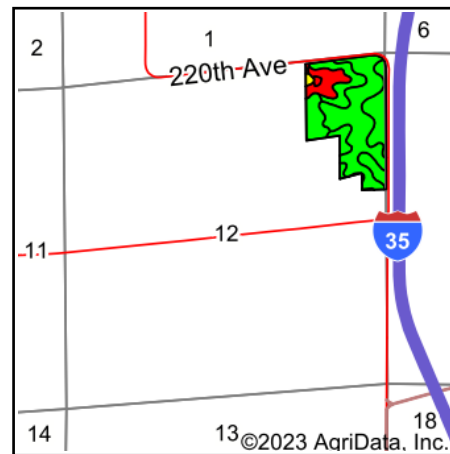

State: **Iowa**
 County: **Clarke**
 Location: **12-73N-26W**
 Township: **Washington**
 Acres: **49.83**
 Date: **12/8/2023**



Maps Provided By:



© AgriData, Inc. 2023

www.AgriDataInc.com



Area Symbol: IA039, Soil Area Version: 29

Code	Soil Description	Acres	Percent of field	CSR2 Legend	Non-Irr Class *c	CSR2**	CSR	*n NCCPI Overall	*n NCCPI Corn	*n NCCPI Small Grains	*n NCCPI Soybeans
368B	Macksburg silty clay loam, 2 to 5 percent slopes	21.71	43.6%		Ile	89	90	87	87	79	78
570C2	Nira silty clay loam, dissected till plain, 5 to 9 percent slopes, eroded	15.36	30.8%		Ille	81	64	84	84	69	69
822C2	Lamoni clay loam, 5 to 9 percent slopes, eroded	4.70	9.4%		Ille	31	30	59	59	53	47
370C2	Sharpsburg silty clay loam, 5 to 9 percent slopes, eroded	4.54	9.1%		Ille	80	67	82	82	68	66
368	Macksburg silty clay loam, 0 to 2 percent slopes	2.54	5.1%		Iw	93	95	87	87	79	79
24D	Shelby loam, 9 to 14 percent slopes	0.45	0.9%		Ille	55	45	72	72	60	61
W	Water	0.36	0.7%			0	0				
Y192C2	Adair clay loam, dissected till plain, 5 to 9 percent slopes, eroded	0.17	0.3%		Ille	33		63	63	56	46
Weighted Average					*-	79.3	*-	*n 82.1	*n 82.1	*n 71.6	*n 70.4

**IA has updated the CSR values for each county to CSR2.

*- CSR weighted average cannot be calculated on the current soils data, use prior data version for csr values.

*n: The aggregation method is "Weighted Average using all components"

*c: Using Capabilities Class Dominant Condition Aggregation Method

*- Non Irr Class weighted average cannot be calculated on the current soils data due to missing data.

Soils data provided by USDA and NRCS.