

CRP Soils Map

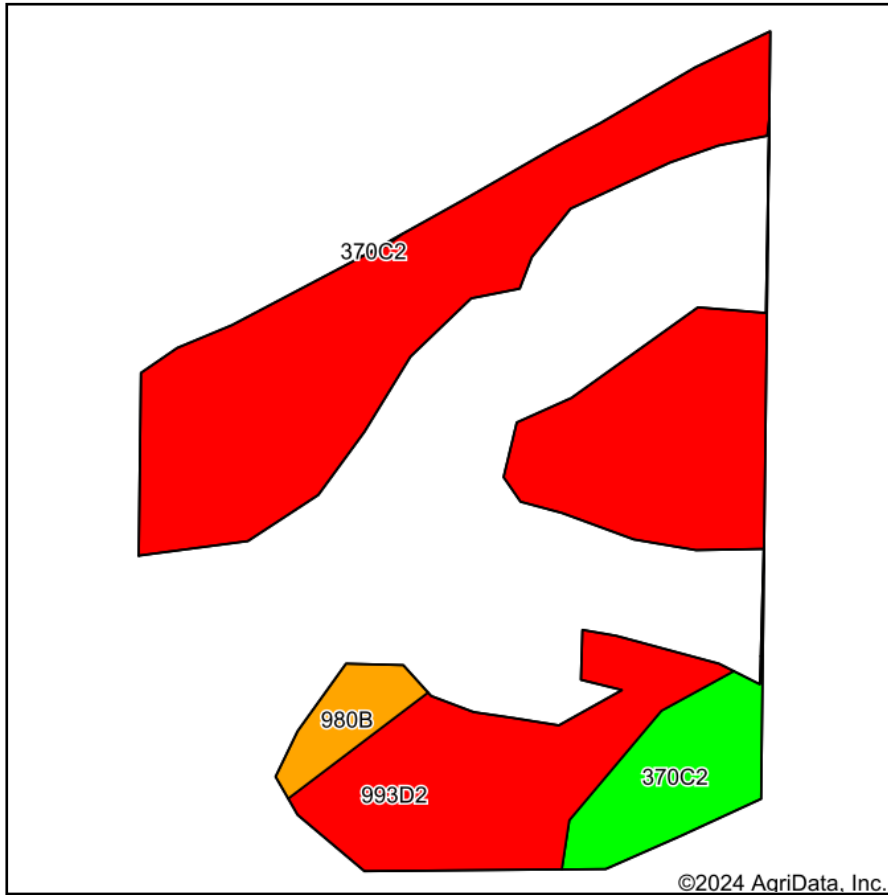

Soils data provided by USDA and NRCS.

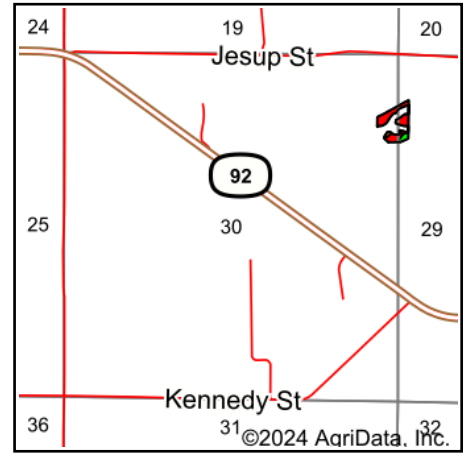

State: **Iowa**
 County: **Warren**
 Location: **30-76N-24W**
 Township: **Lincoln**
 Acres: **2.94**
 Date: **1/29/2024**

PC PEOPLES
 COMPANY
 INTEGRATED LAND SOLUTIONS

Maps Provided By:

 CUSTOMIZED ONLINE MAPPING
 © AgriData, Inc. 2023 www.AgriDataInc.com



Area Symbol: IA181, Soil Area Version: 29

Code	Soil Description	Acres	Percent of field	CSR2 Legend	Non-Irr Class *c	CSR2**	CSR	*n NCCPI Overall	*n NCCPI Corn	*n NCCPI Small Grains	*n NCCPI Soybeans
993D2	Armstrong-Gara loams, 9 to 14 percent slopes, moderately eroded	2.51	85.4%		IVe	23	20	67	67	53	48
370C2	Sharpsburg silty clay loam, 5 to 9 percent slopes, eroded	0.31	10.5%		IIIe	80	67	82	82	68	66
980B	Gullied land-Ely-Colo, occasionally flooded, complex, 2 to 5 percent slopes	0.12	4.1%		VIIe	42	25	10	10	9	9
Weighted Average					4.02	29.8	25.2	*n 66.3	*n 66.3	*n 52.8	*n 48.3

**IA has updated the CSR values for each county to CSR2.

*n: The aggregation method is "Weighted Average using all components"

**IA has updated the CSR values for each county to CSR2.*c: Using Capabilities Class Dominant Condition Aggregation Method

Soils data provided by USDA and NRCS.