

# Soils Map

Boundary Lines Are Approximate

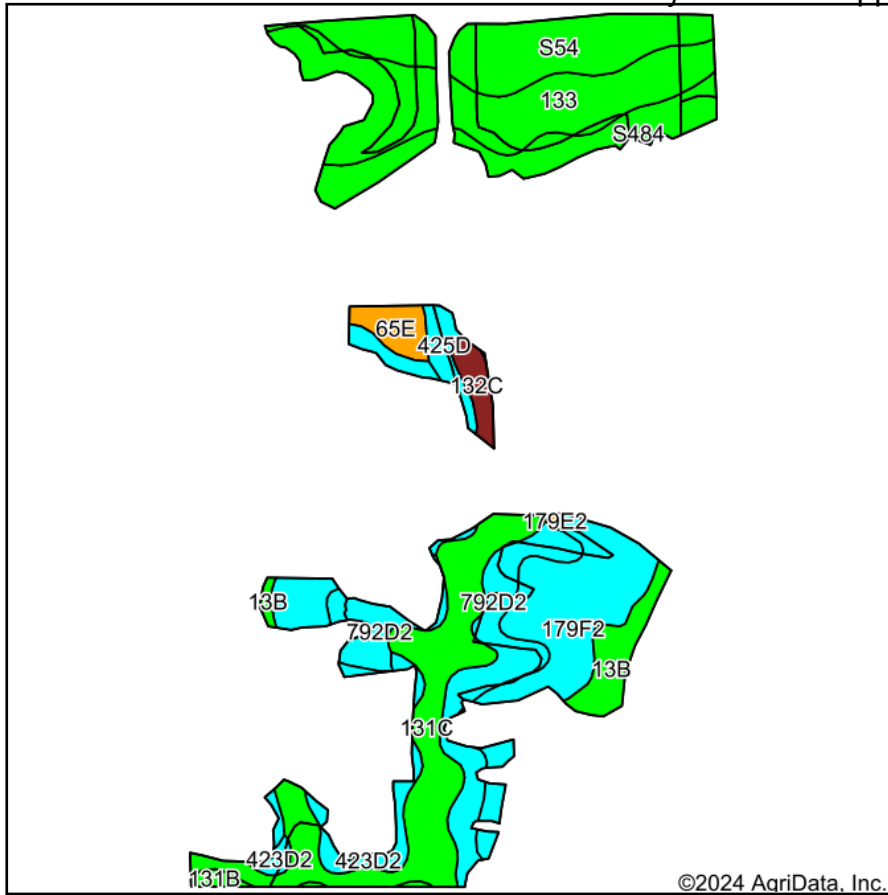

Soils data provided by USDA and NRCS.

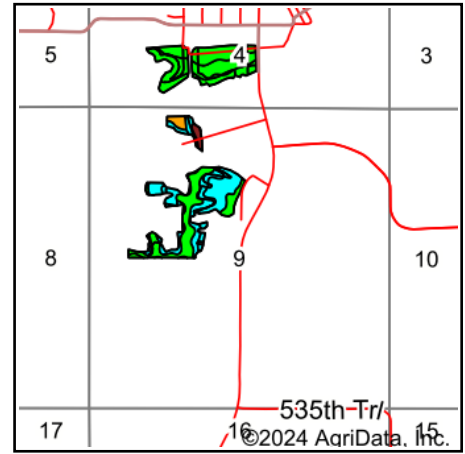

State: **Iowa**  
 County: **Monroe**  
 Location: **9-71N-19W**  
 Township: **Jackson**  
 Acres: **55.83**  
 Date: **2/13/2024**

**Hawkeye Farm Mgmt & Real Estate**

**United Country Real Estate**  
 22 N Main, Albion IA Phone: 641-932-7796  
 Email: hawkeye@uciowa.com  
 On the web: www.uciowa.com; www.iowawhitehallfarms.com

Maps Provided By:  
**surety**  
 CUSTOMIZED ONLINE MAPPING  
 © AgriData, Inc. 2023 www.AgriDataInc.com



Area Symbol: IA135, Soil Area Version: 31

Code	Soil Description	Acres	Percent of field	CSR2 Legend	Non-Irr Class *c	CSR2**	CSR	*n NCCPI Corn	*n NCCPI Soybeans
133	Colo silty clay loam, heavy till, 0 to 2 percent slopes, occasionally flooded	9.87	17.7%		Ilw	78	85	94	86
131C	Pershing silt loam, 5 to 9 percent slopes	9.73	17.4%		Ille	65	49	72	58
S54	Zook silty clay loam, heavy till, 0 to 2 percent slopes, occasionally flooded	7.72	13.8%		Ilw	68		74	67
179F2	Gara loam, 18 to 24 percent slopes, moderately eroded	7.39	13.2%		Vle	12	13	54	36
792D2	Armstrong loam, 9 to 14 percent slopes, moderately eroded	6.50	11.6%		IVe	9	13	62	43
S484	Lawson silt loam, heavy till, 0 to 2 percent slopes, occasionally flooded	4.59	8.2%		Ilw	86		88	93
13B	Olmitz-Colo-Vesser complex, 2 to 5 percent slopes	2.20	3.9%		Ilw	82	60	70	71
65G	Lindley loam, 18 to 40 percent slopes	2.13	3.8%		Vlle	6	5	21	11
423D2	Bucknell silty clay loam, 9 to 14 percent slopes, moderately eroded	1.82	3.3%		IVe	6	13	62	48
65E	Lindley loam, 14 to 18 percent slopes	1.26	2.3%		Vle	33	30	71	60
425D	Keswick loam, 9 to 14 percent slopes	1.13	2.0%		IVe	8	16	62	48
132C	Weller silt loam, 5 to 9 percent slopes	0.97	1.7%		Ille	59	44	85	73
131B	Pershing silt loam, 2 to 5 percent slopes	0.42	0.8%		Ille	70	67	74	59
179E2	Gara loam, 14 to 18 percent slopes, moderately eroded	0.10	0.2%		Vle	35	33	68	51
Weighted Average					3.36	50.4	*-	*n 71.6	*n 60.9

Soils data provided by USDA and NRCS.

Maps Provided By:



© AgriData, Inc. 2023

www.AgriDataInc.com

\*\*IA has updated the CSR values for each county to CSR2.

\*\*IA has updated the CSR values for each county to CSR2.\*- CSR weighted average cannot be calculated on the current soils data, use prior data version for csr values.

\*n: The aggregation method is "Weighted Average using all components"

\*\*IA has updated the CSR values for each county to CSR2.\*- CSR weighted average cannot be calculated on the current soils data, use prior data version for csr values.\*c: Using Capabilities Class Dominant Condition Aggregation Method