

Soils Map

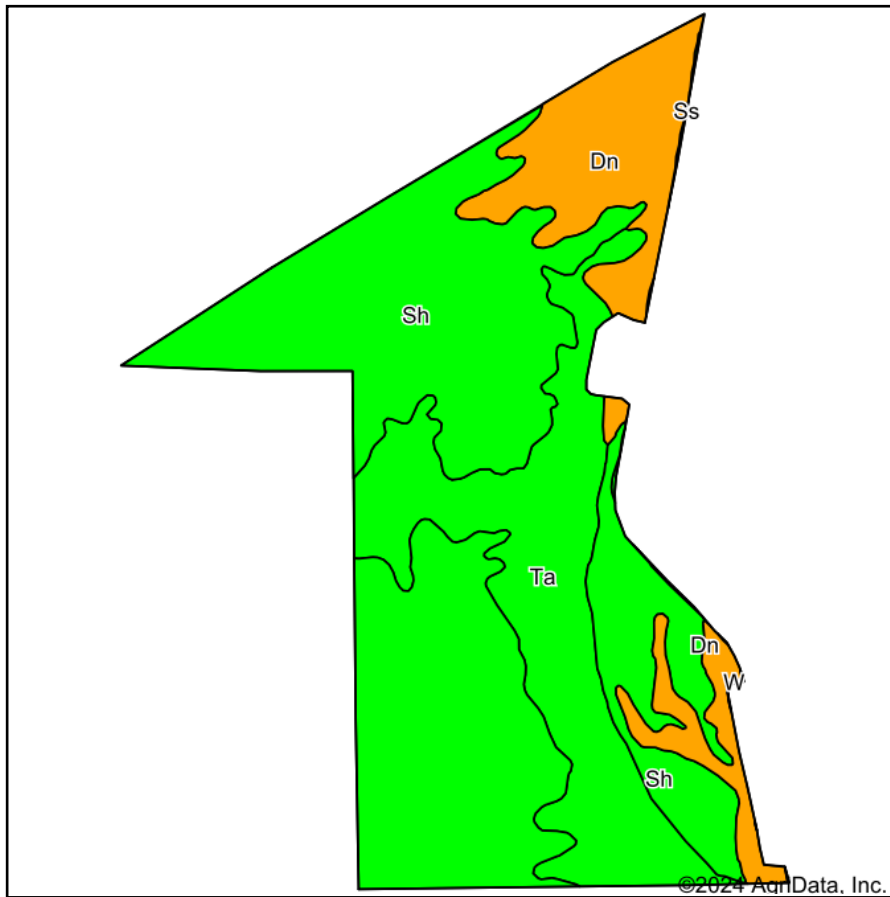

Soils data provided by USDA and NRCS.

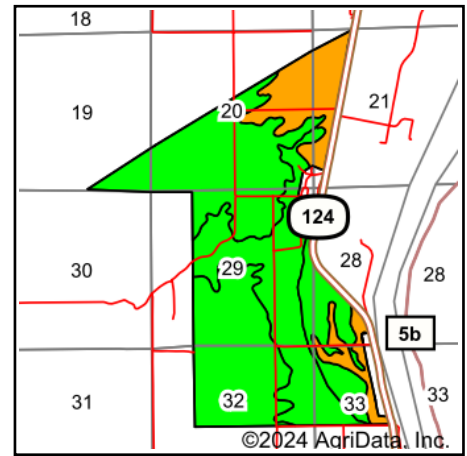

State: **Louisiana**
 County: **Catahoula**
 Location: **29-6N-6E**
 Township: **District 9**
 Acres: **1400**
 Date: **2/2/2024**



Area Symbol: LA025, Soil Area Version: 18

| Code | Soil Description | Acres | Percent of field | Non-Irr Class Legend | Non-Irr Class *c | Common bermudagrass AUM | Corn Bu | Cotton lint Lbs | Improved bermudagrass AUM | Rice Irrigated Bu | Soybeans Bu | Tall fescue AUM | Wheat Bu |
|------------------|--|--------|------------------|----------------------|------------------|-------------------------|---------|-----------------|---------------------------|-------------------|-------------|-----------------|----------|
| Sh | Sharkey clay, 0 to 1 percent slopes, rarely flooded, south | 837.82 | 59.8% | | IIIw | 6.5 | | 650 | 10 | 130 | 40 | 9 | 45 |
| Ta | Tensas silty clay, 0 to 1 percent slopes, rarely flooded | 338.54 | 24.2% | | IIIw | 6.5 | | 600 | 11 | 130 | 40 | 9 | 50 |
| Dn | Dundee silty clay loam, 0 to 1 percent slopes | 220.56 | 15.8% | | IIw | | 85 | 750 | 9 | | 40 | 9 | 45 |
| Ss | Sostien clay, occasionally flooded | 2.83 | 0.2% | | IVw | 6 | | | | | | 8 | |
| W | Water | 0.13 | 0.0% | | | | | | | | | | |
| LE | Levees-Borrow pits complex, nearly level to strongly sloping | 0.12 | 0.0% | | | | | | | | | | |
| Weighted Average | | | | | *- | 5.5 | 13.4 | 652.2 | 10.1 | 109.2 | 39.9 | 9 | 46.1 |

*c: Using Capabilities Class Dominant Condition Aggregation Method

c: Using Capabilities Class Dominant Condition Aggregation Method- Non Irr Class weighted average cannot be calculated on the current soils data due to missing data.