

# Soils Map

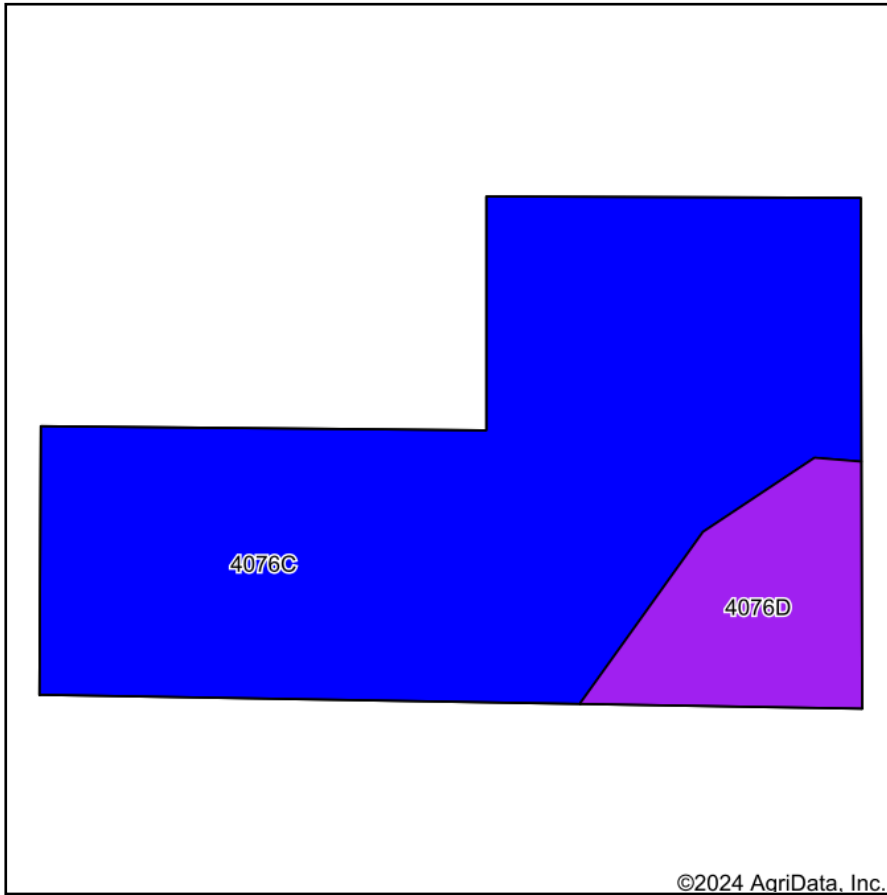

Soils data provided by USDA and NRCS.

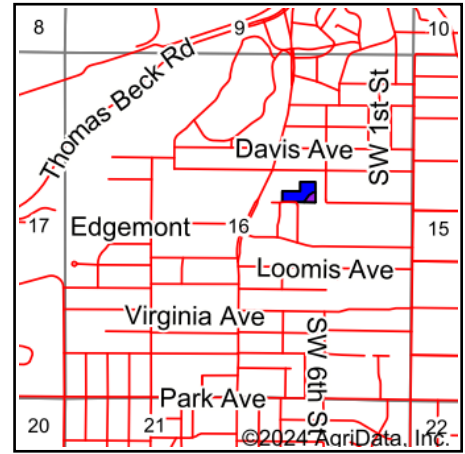

State: **Iowa**  
 County: **Polk**  
 Location: **16-78N-24W**  
 Township: **Des Moines**  
 Acres: **2.68**  
 Date: **5/30/2024**



Maps Provided By:



Area Symbol: IA153, Soil Area Version: 26

Code	Soil Description	Acres	Percent of field	CSR2 Legend	Non-Irr Class *c	*i Corn Bu	*i Soybeans Bu	CSR2**	*n NCCPI Soybeans
4076C	Ladoga-Urban land complex, 5 to 9 percent slopes	2.28	85.1%		Ille	80.0	23.2	81	76
4076D	Ladoga-Urban land complex, 9 to 14 percent slopes	0.40	14.9%		Ille	80.0	23.2	55	71
Weighted Average					3.00	80	23.2	77.1	*n 75.3

\*\*IA has updated the CSR values for each county to CSR2.

\*i Yield data provided by the ISPAID Database version 8.1.1 developed by IA State University.

\*n: The aggregation method is "Weighted Average using all components"

\*c: Using Capabilities Class Dominant Condition Aggregation Method

Soils data provided by USDA and NRCS.