

# Soils Map

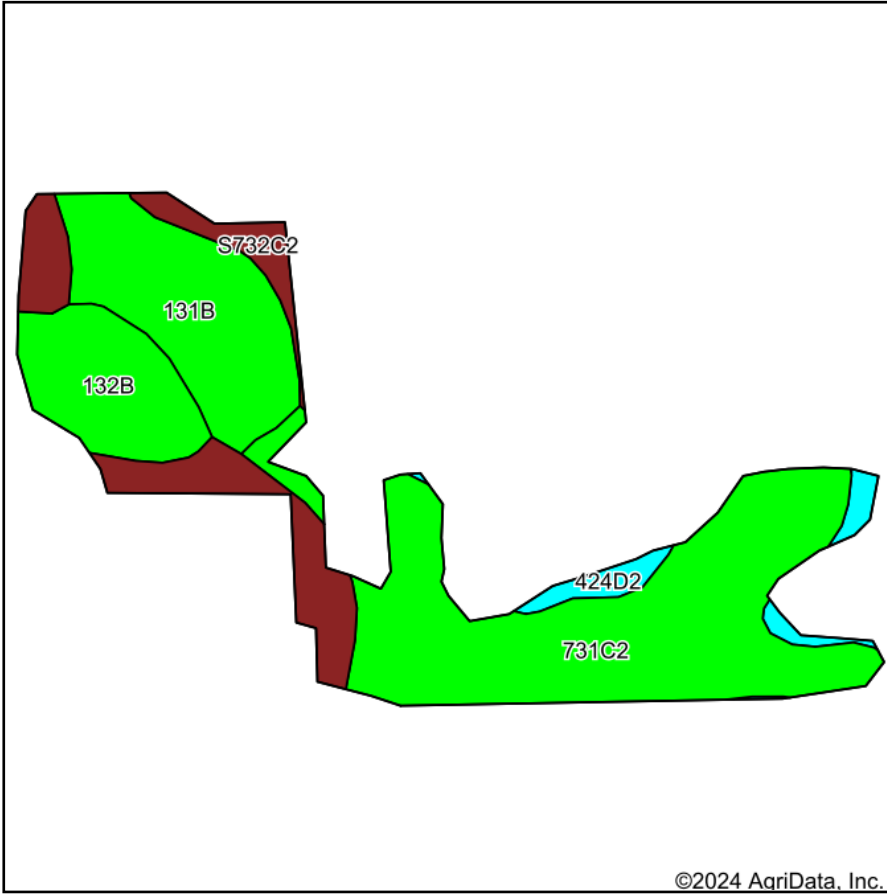

Soils data provided by USDA and NRCS.

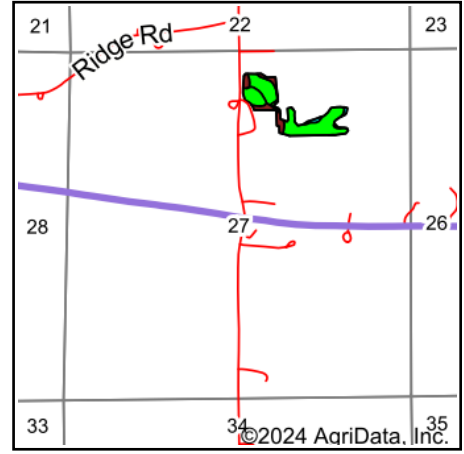

State: **Iowa**  
 County: **Wapello**  
 Location: **27-72N-15W**  
 Township: **Polk**  
 Acres: **12.36**  
 Date: **4/30/2024**

**Hawkeye Farm Mgmt & Real Estate**

**United Country Real Estate**  
 22 N Main, Albia IA Phone: 641-932-7796  
 Email: hawkeye@uciowa.com  
 On the web: www.uciowa.com  
 www.iowawhitetailfarms.com

Maps Provided By:



© AgriData, Inc. 2023

www.AgriDataInc.com



Area Symbol: IA179, Soil Area Version: 32

Code	Soil Description	Acres	Percent of field	CSR2 Legend	Non-Irr Class *c	CSR2**	CSR	*n NCCPI Corn	*n NCCPI Soybeans	
731C2	Pershing silty clay loam, 5 to 9 percent slopes, moderately eroded	5.71	46.2%		IIIe	62	40	68	56	
131B	Pershing silt loam, 2 to 5 percent slopes	2.59	21.0%		IIIe	70	65	74	59	
S732C2	Weller silty clay loam, 5 to 9 percent slopes, moderately eroded	1.91	15.5%		IIIe	59		81	67	
132B	Weller silt loam, 2 to 5 percent slopes	1.64	13.3%		IIIe	67	55	89	80	
424D2	Lindley-Keswick loams, 9 to 14 percent slopes, moderately eroded	0.51	4.1%		IVe	27	15	63	50	
<b>Weighted Average</b>						<b>3.04</b>	<b>62.4</b>	<b>*-</b>	<b>*n 73.8</b>	<b>*n 61.3</b>

\*\*IA has updated the CSR values for each county to CSR2.

\*- CSR weighted average cannot be calculated on the current soils data, use prior data version for csr values.

\*n: The aggregation method is "Weighted Average using all components"

\*c: Using Capabilities Class Dominant Condition Aggregation Method