

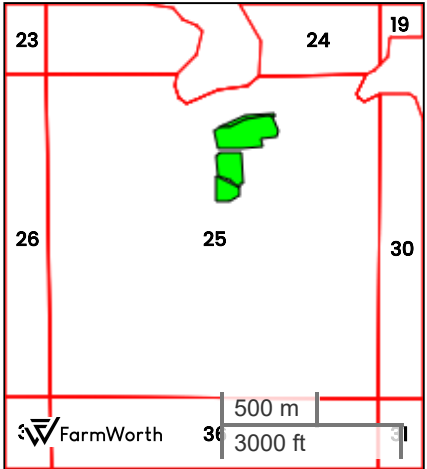

MARQUETTE 82 (82.37 AC TOTAL, 17.47 AC TILLABLE)  
TILLABLE SOILS

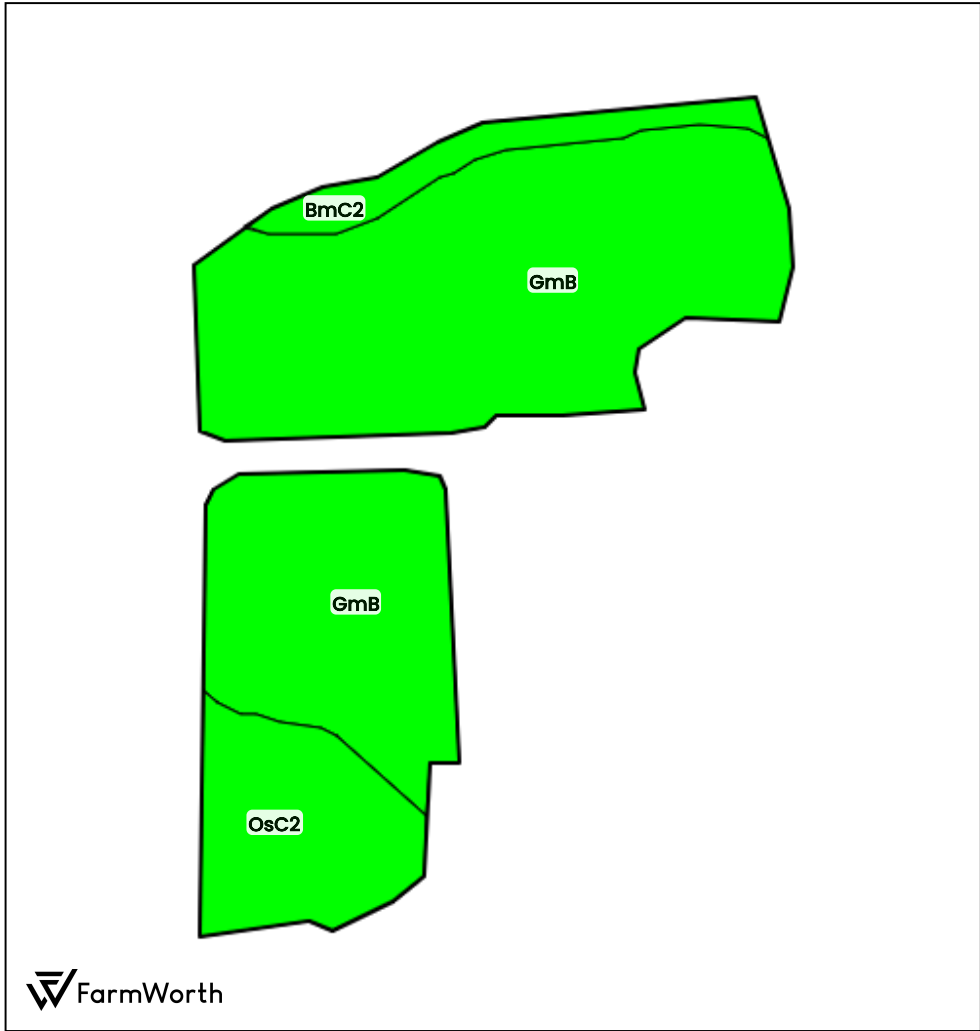

County: Marquette County, WI  
Location: 25-15N-9E  
Township: Packwaukee  
Acres: 17.47  
Date: 08/24/2024



Field borders obtained from Farm Service Agency  
as of 2008

FarmWorth, LLC makes no representations or warranties, express or implied, as to the accuracy of any information, data, numerical values, boundaries, or any other information generated through the use of FarmWorth.com. User is solely responsible for independently investigating and determining all information provided through FarmWorth.com prior to use and waives any and all claims against FarmWorth, LLC for any inaccuracies or inconsistencies in the information and/or data.

Code	Description	Acres	% of field	Overall NCCPI	Soil Class (Irr)	Soil Class (Non-Irr)	Drainage Class
GmB	Gotham loamy fine sand, loamy substratum, 2 to 6 percent slopes	13.62	77.96 %	47	-	4	Well drained
OsC2	Oshtemo loamy fine sand, 6 to 12 percent slopes, eroded	2.74	15.68 %	60	3	3	Well drained
BmC2	Boyer loamy fine sand, 6 to 12 percent slopes, eroded	1.11	6.35 %	44	-	3	Well drained
Average:				48.8			

Soils data provided by USDA and NRCS.