

Soils Map

Boundary Lines Are Approximate

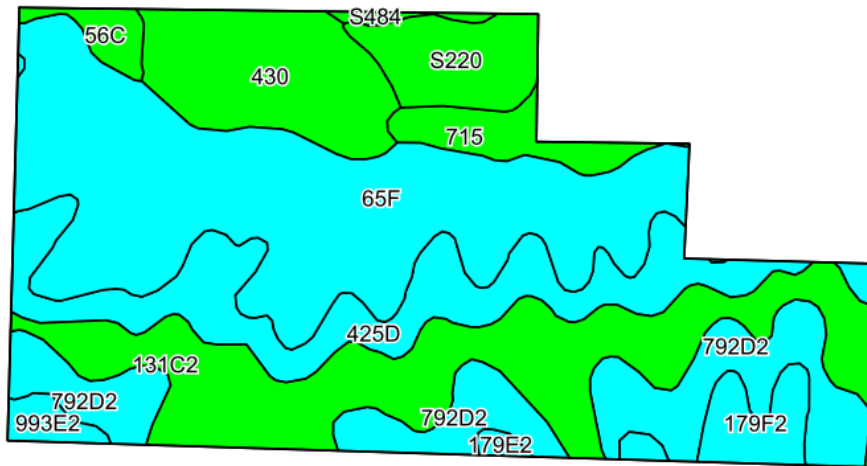

©2024 AgriData, Inc.

Soils data provided by USDA and NRCS.

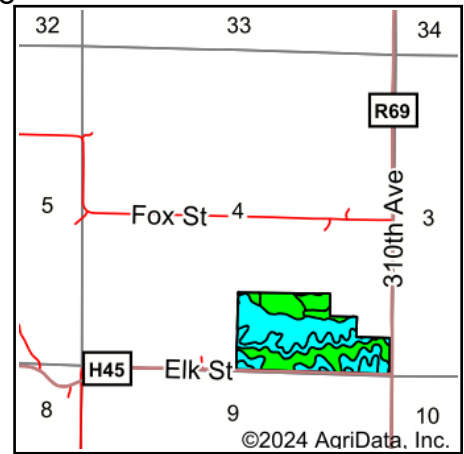

State: **Iowa**
 County: **Clarke**
 Location: **4-71N-24W**
 Township: **Franklin**
 Acres: **66.5**
 Date: **9/13/2024**

Hawkeye Farm Mgmt & Real Estate

22 N Main, Albion IA Phone: 641-932-7796
 Email: hawkeye@uciowa.com
 On the web: www.uciowa.com
www.iowawhitetailfarms.com

Maps Provided By:

surety
 CUSTOMIZED ONLINE MAPPING
 © AgriData, Inc. 2023 www.AgriDataInc.com



Area Symbol: IA039, Soil Area Version: 29

Code	Soil Description	Acres	Percent of field	CSR2 Legend	Non-Irr Class *c	CSR2**	CSR	*n NCCPI Corn	*n NCCPI Soybeans
65F	Lindley loam, 18 to 25 percent slopes	20.86	31.4%		Vll	17	5	58	48
131C2	Pershing silty clay loam, 5 to 9 percent slopes, moderately eroded	12.94	19.5%		Ille	62	45	68	56
792D2	Armstrong clay loam, 9 to 14 percent slopes, moderately eroded	8.94	13.4%		IVe	5	13	59	42
425D	Keswick loam, 9 to 14 percent slopes	8.78	13.2%		IVe	8	16	62	48
430	Ackmore silt loam, heavy till, 0 to 2 percent slopes, occasionally flooded	6.01	9.0%		Ilw	77	83	91	82
S220	Nodaway silt loam, heavy till, 0 to 2 percent slopes, occasionally flooded	3.03	4.6%		Ilw	77		87	83
715	Nodaway-Lawson silt loams, heavy till, 0 to 2 percent slopes, occasionally flooded	1.95	2.9%		Ilw	74		84	87
179F2	Gara clay loam, 18 to 25 percent slopes, moderately eroded	1.93	2.9%		IVe	11	8	52	34
56C	Cantril loam, 5 to 9 percent slopes	0.85	1.3%		Ille	76	52	92	77
993E2	Gara-Armstrong clay loams, 14 to 18 percent slopes, moderately eroded	0.70	1.1%		Vle	23	10	63	45
S484	Lawson silt loam, heavy till, 0 to 2 percent slopes, occasionally flooded	0.28	0.4%		Ilw	86		88	93
179E2	Gara clay loam, 14 to 18 percent slopes, moderately eroded	0.23	0.3%		Vle	23	28	62	42
Weighted Average						4.42	33.7	*n 66.1	*n 54.7

**IA has updated the CSR values for each county to CSR2.

*- CSR weighted average cannot be calculated on the current soils data, use prior data version for csr values.

*n: The aggregation method is "Weighted Average using all components"

*c: Using Capabilities Class Dominant Condition Aggregation Method

Soils data provided by USDA and NRCS.