

Map

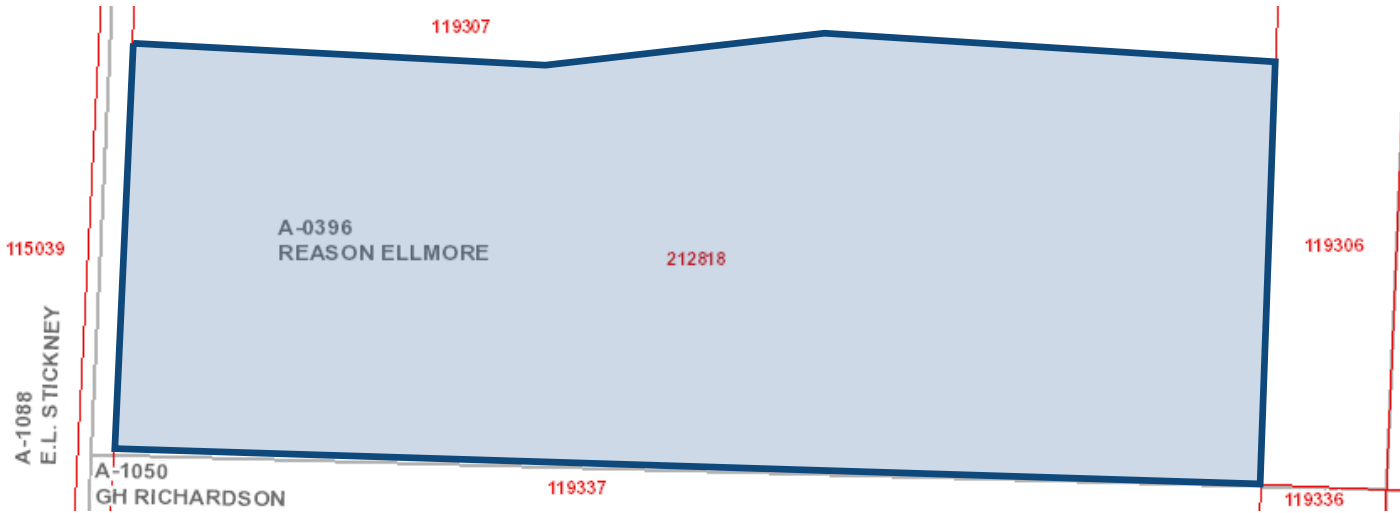

Property Details

| Account | |
|--------------------|---|
| Property ID: | 212818 |
| Legal Description: | G-0396 ELLMORE RESSON A-G0396, ACRES 43.32 |
| Geographic ID: | 125 039600201 |
| Agent: | |
| Type: | Real |
| Location | |
| Address: | HIGHTOWER RD SHERMAN, TX |
| Map ID: | 125 |
| Neighborhood CD: | |
| Owner | |
| Owner ID: | 265024 |
| Name: | MORGAN STEVEN L & DOTTY L TRUSTEES |
| Mailing Address: | MORGAN MANAGEMENT TRUST 182 HIGHTOWER RD SHERMAN, TX 75092-4948 |
| % Ownership: | 100.0% |
| Exemptions: | For privacy reasons not all exemptions are shown online. |

Property Values

| |
|--|
| |
|--|

| | |
|--|-----------|
| Improvement Homesite Value: | \$0 |
| Improvement Non-Homesite Value: | \$0 |
| Land Homesite Value: | \$0 |
| Land Non-Homesite Value: | \$0 |
| Agricultural Market Valuation: | \$742,383 |
| | |
| Market Value: | \$742,383 |
| Ag Use Value: | \$1,556 |
| | |
| Appraised Value: | \$1,556 |
| Homestead Cap Loss: ⓘ | \$0 |
| | |
| Assessed Value: | \$1,556 |
| <p>Information provided for research purposes only. Legal descriptions and acreage amounts are for appraisal district use only and should be verified prior to using for legal purpose and or documents. Please contact the Appraisal District to verify all information for accuracy.</p> | |

Property Taxing Jurisdiction

| Entity | Description | Market Value | Taxable Value |
|--------|----------------------------------|--------------|---------------|
| CAD | Central Appraisal District | \$742,383 | \$1,556 |
| GRA | Grayson County | \$742,383 | \$1,556 |
| JRC | Jr College | \$742,383 | \$1,556 |
| SSS | Southmayd/Sadler School District | \$742,383 | \$1,556 |

Property Land

| Type | Description | Acreage | Sqft | Eff Front | Eff Depth | Market Value | Prod. Value |
|---------|----------------------------|---------|--------------|-----------|-----------|--------------|-------------|
| AVCROP7 | AVERAGE CROP (C SOIL) NATP | 23.29 | 1,014,512.40 | 0.00 | 0.00 | \$399,125 | \$838 |
| PRPAST7 | POOR PASTURE (F SOIL) NATP | 1.42 | 61,855.20 | 0.00 | 0.00 | \$24,335 | \$36 |
| PRPAST7 | POOR PASTURE (F SOIL) NATP | 7.19 | 313,196.40 | 0.00 | 0.00 | \$123,216 | \$180 |
| GDCROP7 | GOOD CROP (B SOIL) NATP | 11.42 | 497,455.20 | 0.00 | 0.00 | \$195,707 | \$502 |

Property Roll Value History

| Year | Improvements | Land Market | Ag Valuation | Appraised | HS Cap Loss | Assessed |
|------|--------------|-------------|--------------|-----------|-------------|----------|
| 2024 | N/A | N/A | N/A | N/A | N/A | N/A |
| 2023 | \$0 | \$742,383 | \$1,556 | \$1,556 | \$0 | \$1,556 |
| 2022 | \$0 | \$319,251 | \$1,556 | \$1,556 | \$0 | \$1,556 |
| 2021 | \$0 | \$173,280 | \$1,623 | \$1,623 | \$0 | \$1,623 |
| 2020 | \$0 | \$173,280 | \$2,195 | \$2,195 | \$0 | \$2,195 |
| 2019 | \$0 | \$173,280 | \$2,370 | \$2,370 | \$0 | \$2,370 |
| 2018 | \$0 | \$151,525 | \$2,426 | \$2,426 | \$0 | \$2,426 |
| 2017 | \$0 | \$129,911 | \$2,581 | \$2,581 | \$0 | \$2,581 |
| 2016 | \$0 | \$151,525 | \$2,581 | \$2,581 | \$0 | \$2,581 |
| 2015 | \$0 | \$151,525 | \$2,503 | \$2,503 | \$0 | \$2,503 |
| 2014 | \$0 | \$129,923 | \$2,503 | \$2,503 | \$0 | \$2,503 |
| 2013 | \$0 | \$129,944 | \$2,484 | \$2,484 | \$0 | \$2,484 |
| 2012 | \$0 | \$281,471 | \$2,503 | \$2,503 | \$0 | \$2,503 |

Property Deed History

| Deed Date | Type | Description | Grantor | Grantee | Volume | Page | Number |
|-----------|------|---------------|---------|------------------------------------|--------|------|--------|
| 2/15/2001 | WD | WARRANTY DEED | | MORGAN STEVEN L & DOTTY L TRUSTEES | 3033 | 170 | 0 |