

Soils Map

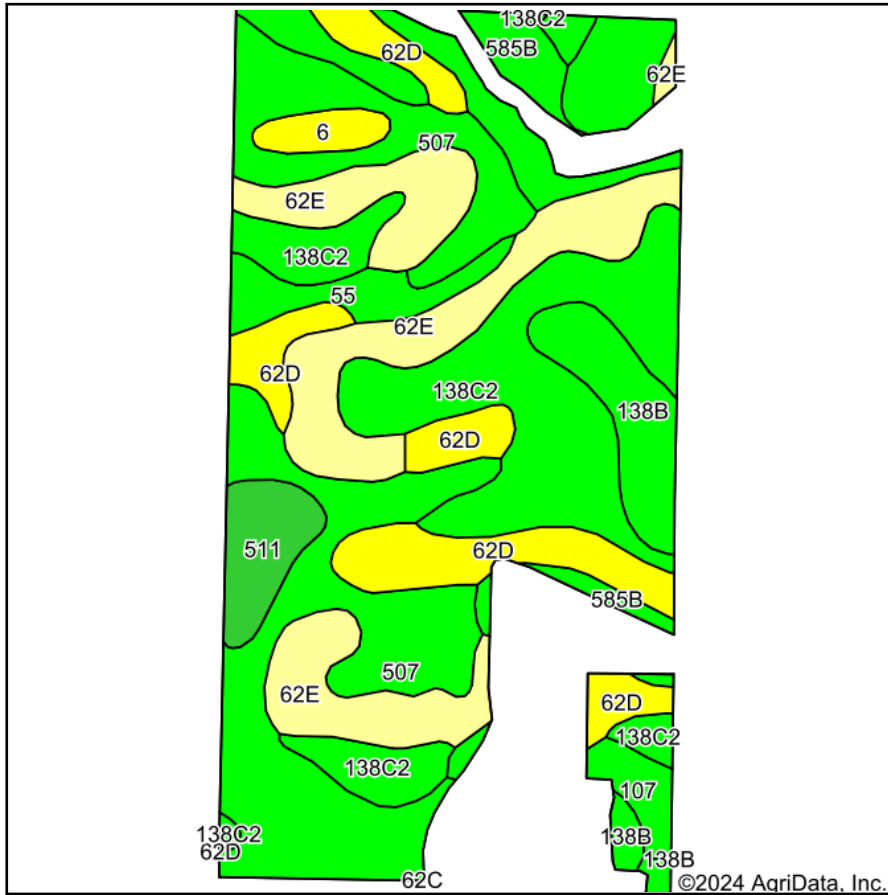

Soils data provided by USDA and NRCS.

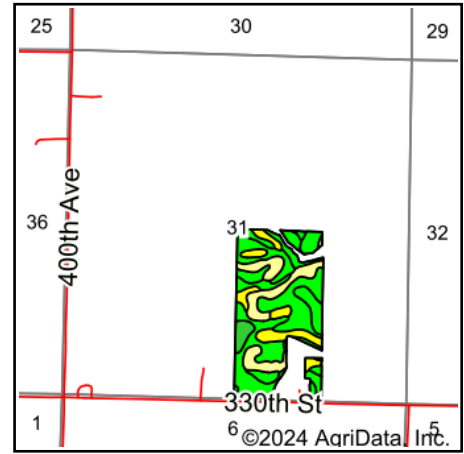

State: **Iowa**
 County: **Palo Alto**
 Location: **31-97N-33W**
 Township: **Walnut**
 Acres: **66.43**
 Date: **10/29/2024**

712-262-3110
MIDWEST LAND & REAL ESTATE, INC.
 MANAGEMENT
 Maps Provided By:
surety
 CUSTOMIZED ONLINE MAPPING
 © AgriData, Inc. 2023 www.AgriDataInc.com

Area Symbol: IA147, Soil Area Version: 30

Code	Soil Description	Acres	Percent of field	CSR2 Legend	Non-Irr Class *c	CSR2**	CSR
507	Canisteo clay loam, 0 to 2 percent slopes	16.61	25.0%		IIw	84	74
138C2	Clarion loam, 6 to 10 percent slopes, moderately eroded	16.57	24.9%		IIIe	83	58
62E	Storden loam, 10 to 22 percent slopes, moderately eroded	11.91	17.9%		IVe	32	30
62D	Storden loam, 10 to 16 percent slopes, moderately eroded	7.21	10.9%		IVe	41	39
585B	Colo-Spillville complex, 2 to 5 percent slopes	3.96	6.0%		IIw	77	60
138B	Clarion loam, 2 to 6 percent slopes	3.56	5.4%		IIe	89	76
55	Nicollet clay loam, 1 to 3 percent slopes	2.38	3.6%		Iw	89	84
511	Blue Earth mucky silt loam, 0 to 1 percent slopes	2.18	3.3%		IIIw	66	56
107	Webster clay loam, 0 to 2 percent slopes	1.09	1.6%		IIw	86	79
6	Okoboji silty clay loam, 0 to 1 percent slopes	0.96	1.4%		IIIw	59	54
Weighted Average					2.84	68.9	57.2

**IA has updated the CSR values for each county to CSR2.

*c: Using Capabilities Class Dominant Condition Aggregation Method