

STATE OF KENTUCKY  
COUNTY OF RUSSELL SCT

I, Brigitte Popplewell, Clerk of Russell County, certify that  
on the 17 day of Oct 19 97  
the foregoing plat was produced to me  
certified as above and lodged for record at 10:22  
Whereupon I have recorded the same, together with this  
certificate the 17 day of Oct  
19 97 in Book 2 Page Side A 37

Attest: Brigitte Popplewell, Clerk

By: M. Stewart D.C. 1500

'97 OCT 17 AM 10:22

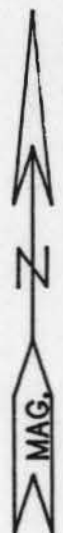

LEGEND

○ 3/8" REBAR, (YELLOW ID CAP,  
BARNES 2677) SET.

● STONE, EXISTING

AMULET ESTATES  
RESTRICTIONS

1. USED FOR RESIDENTIAL HOMES ONLY.
2. NO COMMERCIAL USE PERMITTED.
3. HOMES MUST HAVE AT LEAST 1200 SQ. FT. OF HEATED LIVING SPACE  
(DOES NOT INCLUDE GARAGES OR CARPORTS) AND BRICK, STONE, VINYL  
OR TREATED WOOD SIDING.
4. ANY HOUSE STARTED MUST BE COMPLETE 9 MONTHS FROM STARTING  
DATE.
5. ONLY ONE RESIDENT PER LOT.
6. NO MOBILE HOMES.
7. NO MODULAR HOMES.
8. ANY AND ALL BUILDINGS MUST BE OF SAME MATERIAL AS HOUSE, OR OF  
EQUIVALENT MATERIAL AS HOUSE.
9. ALL LOTS MUST BE MOWED AT LEAST TWICE A YEAR, ONE TIME IN SPRING  
AND ONE TIME IN FALL.
10. NO PARKING ON STREET.
11. NO ABANDONED VEHICLES OR OTHER JUNK.
12. NO LIVESTOCK. PERSONAL PETS ALLOWED (I.E. DOG OR CAT).

I DO HEREBY CERTIFY THAT THIS SURVEY WAS PERFORMED  
BY: B.B. BARNES, LAND SURVEYOR, NO. 2677  
THE REFERENCE MERIDIAN IS BASED ON A MAGNETIC BEARING  
OBSERVED AT N 71°16'10" W 276.19' FROM THE NEC  
OF LOT NO. 1. (STONE EXISTING)

THE METHOD OF THIS SURVEY WAS A RANDOM TRAVERSE. BY USE OF  
A 10" TOTAL STATION UNIT.  
THE UNADJUSTED MATHEMATICAL ERROR OF CLOSURE WAS 1/5,000+.  
THE ERROR OF CLOSURE OF THIS SURVEY HAS BEEN ADJUSTED.

B.B. Barnes LS 2677 10-16-97  
DATE

AMULET ESTATES



CURTIS BALLENGER  
DBK 96 - PG 224

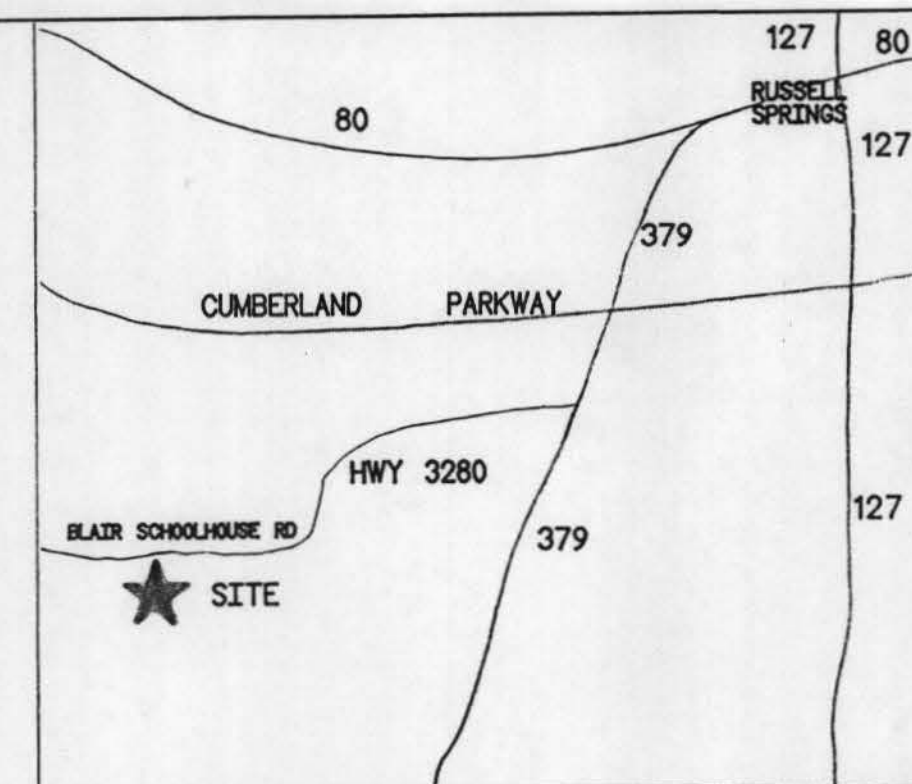

VICINITY MAP  
(NO SCALE)

SOUTH CENTRAL SURVEYING, INC.  
875 HELM LANDING ROAD  
JAMESTOWN, KENTUCKY 42629

B.B. BARNES, L.S. 2677

OFFICE PHONE: 502-343-3777  
FAX PHONE: 502-343-6303

SOUTH CENTRAL SURVEYING, INC.

SCALE: 1" = 100' APPROVED BY: BB BARNES LS 2677 DRAWN BY: PRB  
DATE: 7/16/97 REVISED:

AMULET ESTATES NEW DIVISION: TRACY HOGAN  
DEED BOOK 144 - PAGE 600

HIGHWAY 3280 -  
BLAIR SCHOOLHOUSE ROAD, RUSSELL CO., KY

DRAWING NUMBER:  
TRACYH D-11