

Soils Map

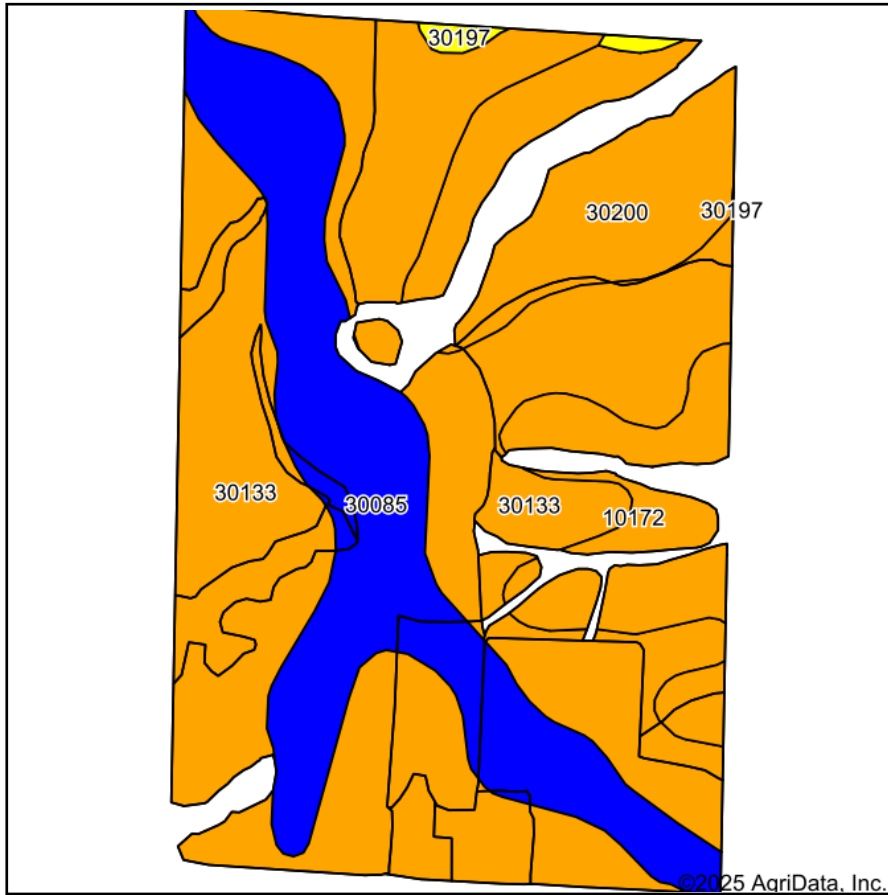

Soils data provided by USDA and NRCS.

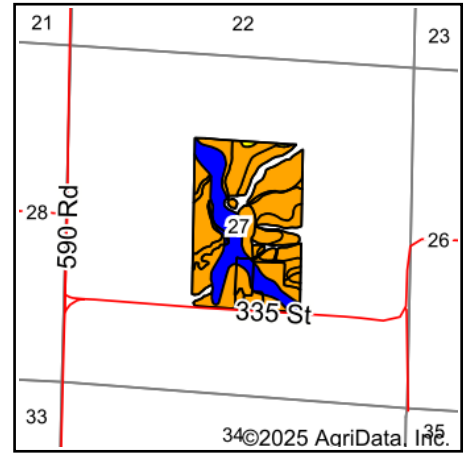

State: **Missouri**
 County: **Gentry**
 Location: **27-63N-30W**
 Township: **Athens**
 Acres: **92.72**
 Date: **3/25/2025**



Area Symbol: MO075, Soil Area Version: 27

Code	Soil Description	Acres	Percent of field	Non-Irr Class Legend	Non-Irr Class *c	*n NCCPI Overall	*n NCCPI Corn	*n NCCPI Small Grains	*n NCCPI Soybeans
30133	Lamoni clay loam, 5 to 9 percent slopes, eroded	51.41	55.5%		IIIe	59	59	53	47
30085	Grundy silt loam, 2 to 5 percent slopes	21.60	23.3%		Ile	74	74	67	64
30200	Shelby loam, 9 to 14 percent slopes	11.17	12.0%		IIIe	72	72	60	61
10172	Shelby clay loam, 9 to 14 percent slopes, moderately eroded	7.94	8.6%		IIIe	70	70	56	54
30197	Shelby loam, 14 to 18 percent slopes	0.60	0.6%		IVe	65	65	53	56
Weighted Average					2.77	*n 65	*n 65	*n 57.4	*n 53.3

*n: The aggregation method is "Weighted Average using all components"

*c: Using Capabilities Class Dominant Condition Aggregation Method

Soils data provided by USDA and NRCS.